

Enhanced Power Module

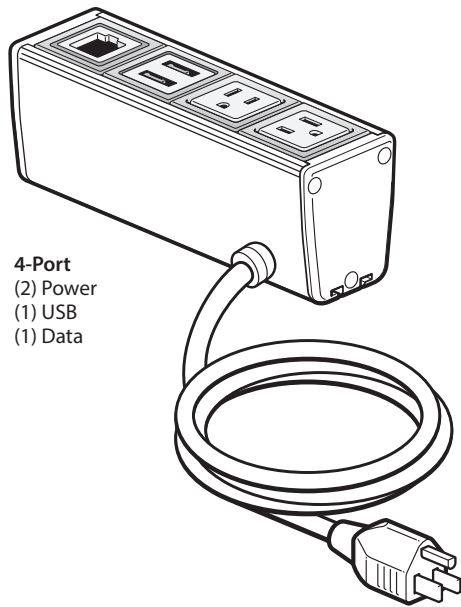

4-Port
(2) Power
(1) USB
(1) Data

Adaptable Worksurfaces®
Reside®
Intuity®
Suite®
Tactics®

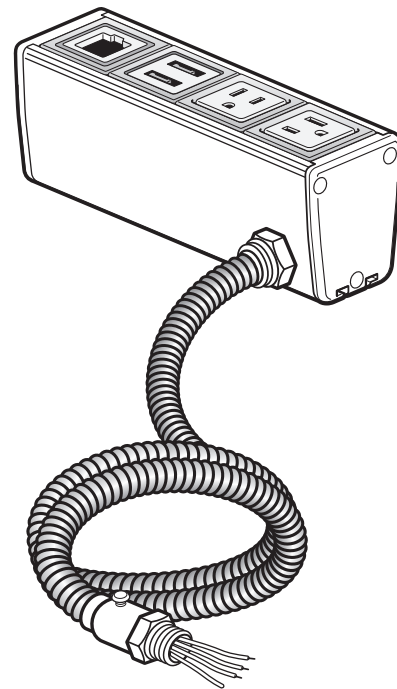

Overview

- Provides Power, USB charging, AV 3, 4 or 6 port modules.
- Mounts with variety of brackets to edge or below worksurface or on horizontal or vertical surfaces.
- Available with 6 foot cord or flexible metal conduit.

Enhanced Power Module

General Specifications

- Power Module body can be configured with several combinations of power, USB charger or AV ports. See pricebook for specific combinations available.
- Power port includes one 15 Amp 120V 60Hertz rated receptacle NEMA 5-15R configuration
- USB charger port includes two USB 2.0 style A outlets with 4.0 Amp (shared) charging capacity
- Available with a variety of mounting brackets-see pricebooks for specific brackets.
- Available with 6 foot SJT power cord with 15A plug (NEMA 5-15P)
- Available with 6 flexible galvanized steel conduit with fitting for 1/2" knockout
- Available in black anodized aluminum frame with black ports or clear anodized aluminum frame with white ports

Listings

- UL listed relocatable power tap rated for 15A 120V 60 Hz
- Cord - UL listed per UL 962A and CSA standard C22.2 #308
- Conduit - UL listed per UL Subject 111 and CSA C22.2 #42, #62, & #62.1

Applicable Codes

- Power Module must be installed in accordance with the National Electrical Code (NEC), the Canadian Electrical Code (CEC), and local electrical codes

Complementary Products

- Haworth Adaptable worksurfaces, Reside®, Intuity®, Suite® and Tactics® furniture

Typical Configuration

- Mounted in worksurface or table. Mounted on side wall of side table or credenza

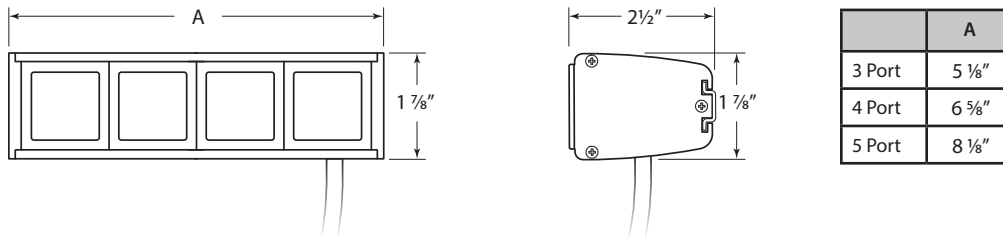

Above The Worksurface Applications

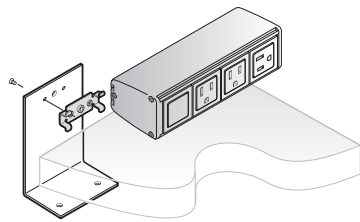

Enhanced Power Module Bracket - Above Worksurface Fixed

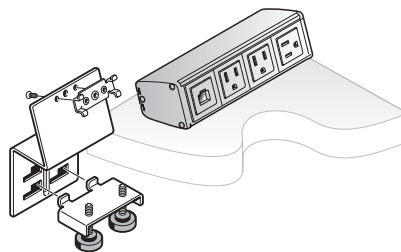

Enhanced Power Module Bracket - Above Worksurface Adjustable

Below The Worksurface Applications

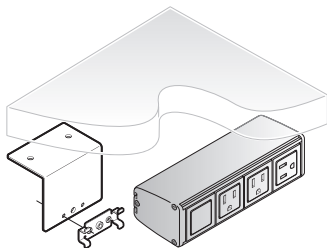

Enhanced Power Module Bracket - Under Worksurface Fixed

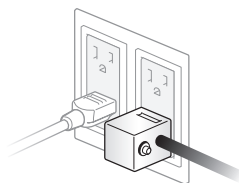

Circuit Breaker Plug