

HAWORTH

Operating Your Upside Height-Adjustable Table

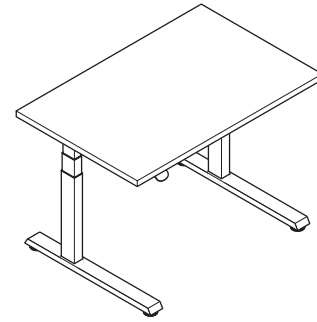

Note: Avoid risk of injury with your height-adjustable table through proper training. For safe operation, ensure that there is at least 1" between the height-adjustable worksurface and any adjacent objects such as storage or fixed worksurfaces.

Paddle Type

Your table is equipped with one of two paddle types (programmable or standard).

*Press the paddle down or up and follow the instructions regardless of the paddle type.

STANDARD PADDLE

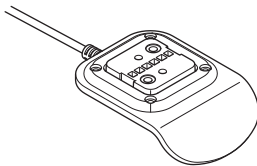

PROGRAMMABLE PADDLE

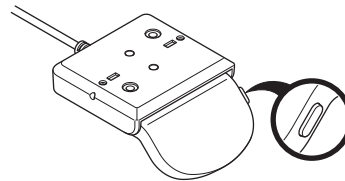

*Paddle and table examples are for illustration purposes only—yours may look different depending on table type.

⚠ IMPORTANT!	
	PRIOR TO FIRST USE, PLUG POWER CORD INTO OUTLET AND PERFORM A DEFAULT RESET TO SYNCHRONIZE THE MOTORS IN THE COLUMNS (D). SEE DEFAULT RESET INSTRUCTIONS.

WAKE UP

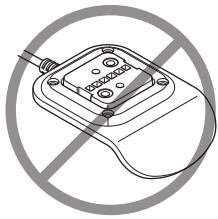

STANDARD PADDLE

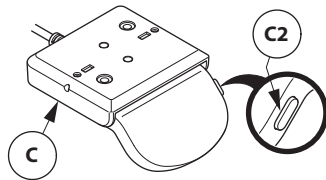

PROGRAMMABLE PADDLE

NOTE: For Programmable Paddles (C) only. Paddle (C) enters a power save mode after 10 seconds of inactivity. Prior to each use, user must **"TAP AND RELEASE"** paddle (C) or **"TAP AND RELEASE"** the menu button (C2) to activate paddle (C).

Power save Mode: Paddle (C) display not visible.

1 PADDLE SLEEPING

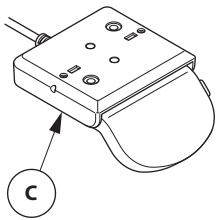

Tap and release to activate paddle (C) prior to each use.

2 TAP TO WAKE UP PADDLE

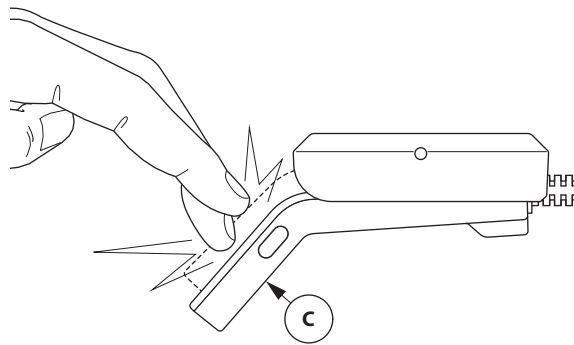

3 TABLE HEIGHT IS SHOWN

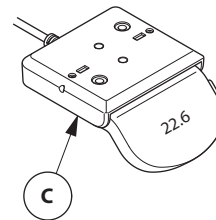

DEFAULT RESET

Synchronizes motors by returning the table to lowest position. Resetting resolves most mechanism issues. **This procedure can be done with either a standard or programmable paddle.**

Default Reset must be performed prior to first use and once per month to ensure proper function. Default Reset should also be performed if table is not operating properly.

1 IMPORTANT! Remove all contents from under table!

STANDARD PADDLE

PROGRAMMABLE PADDLE

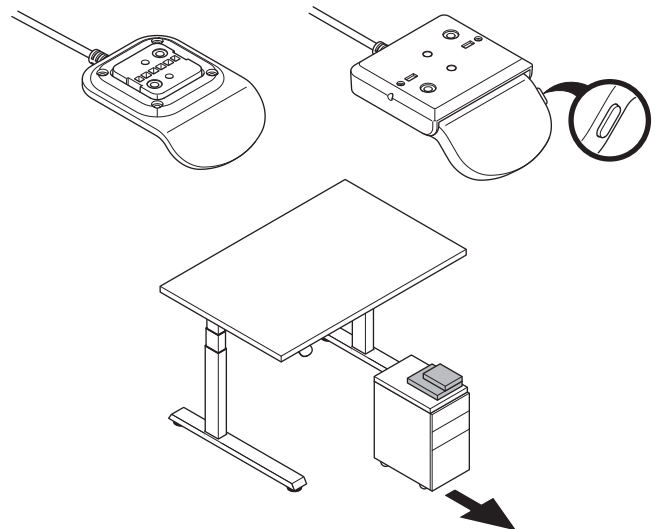
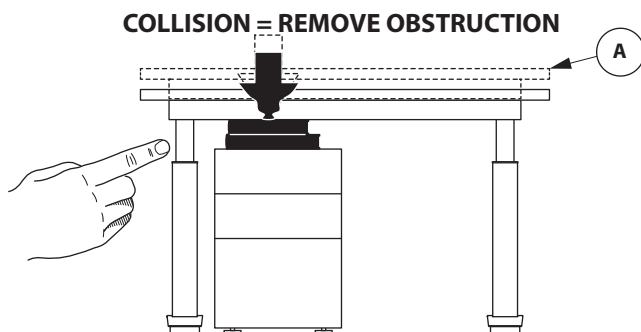

CUSTOMER SERVICE PHONE: 1-800-426-8562

HAWORTH

E.C.O. No: 245-693

Page: 2 of 20

Part No: 6100-0110

Rev: 3

2

Lower table all the way down

Press paddle (C) down

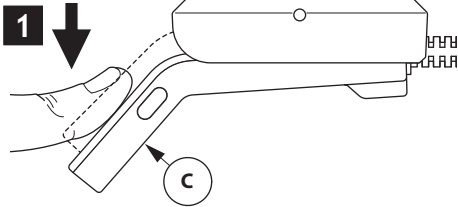

Lower table all the way down

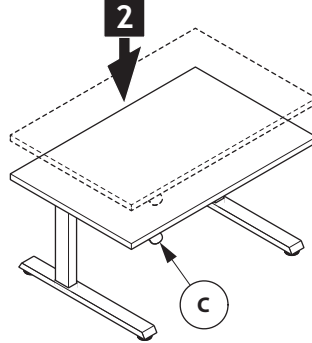

3 Release paddle (C)

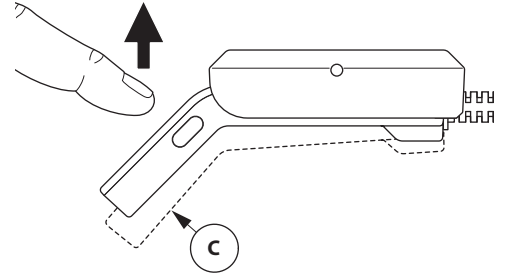

3

Hold down paddle (C) for 15 seconds and release

"HOLD FOR 15 SECONDS"

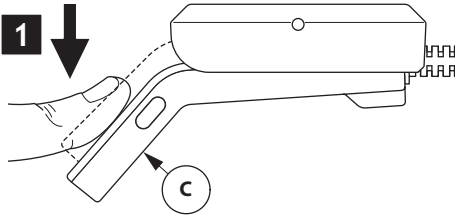

2

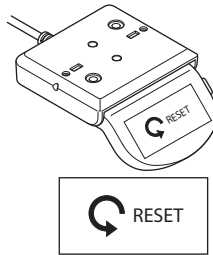

NOTE: This step only applies to programmable paddle.

3 Release paddle (C)

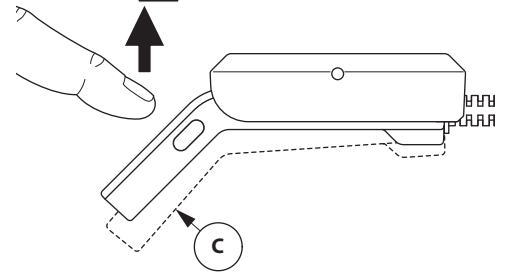

4

Press and hold down paddle (C) until table moves down and continue to hold until table stops moving up

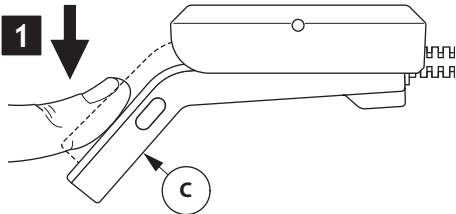

MOVES DOWN SLIGHTLY

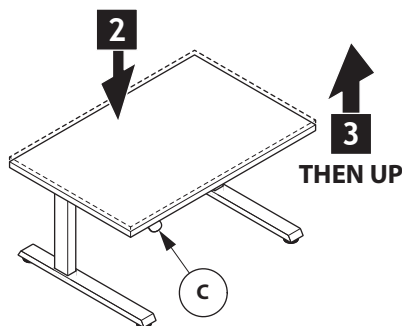

4 Release paddle (C)

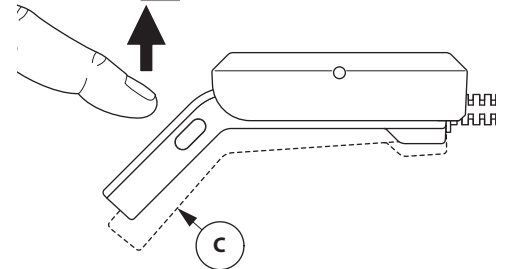

NOTE: Typically the table will move up slightly but if a lower storage stop is set, it will raise up all the way to the lower storage stop.

CUSTOMER SERVICE PHONE: 1-800-426-8562

HAWORTH

E.C.O. No: 245-693

Page: 3 of 20

Part No: 6100-0110

Rev: 3

PROGRAMMABLE PADDLE FEATURES

PROGRAMMABLE PADDLE

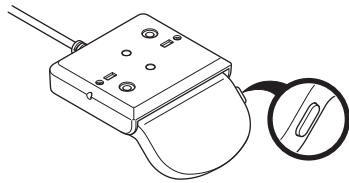

STANDARD PADDLE

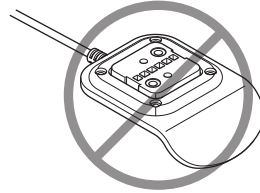

Saving the first preset height position

1 Raise table to desired standing height (above 35.5 inches)

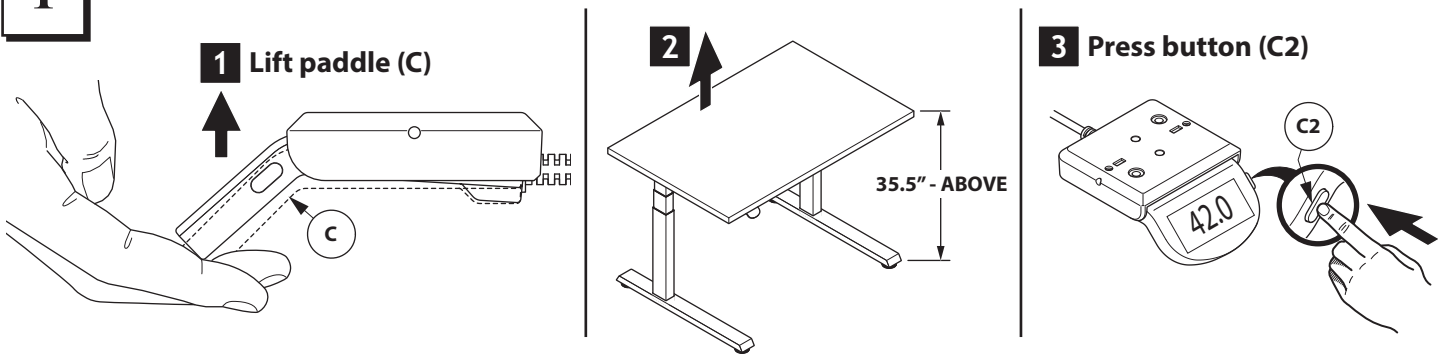

2 Tap paddle (C) up until "Favorite" menu is displayed

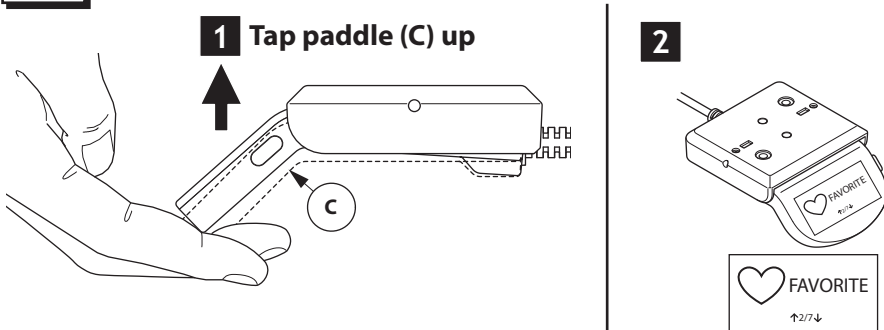

3 Press button (C2)

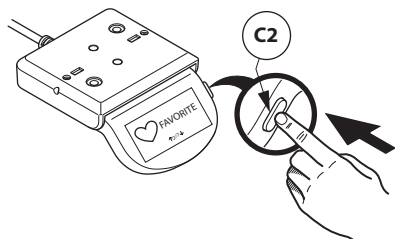

4 Press button (C2) again to set "Preset Height 1"

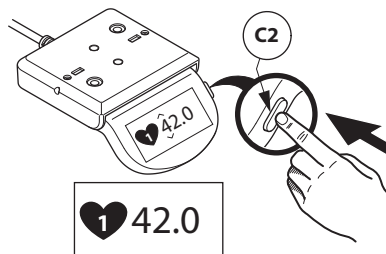

NOTE: Heart fills in.

CUSTOMER SERVICE PHONE: 1-800-426-8562

HAWORTH

E.C.O. No: 245-693

Page: 4 of 20

Part No: 6100-0110

Rev: 3

Saving the second preset height position

1

Raise or lower table to desired seated height (below 35.5 inches)

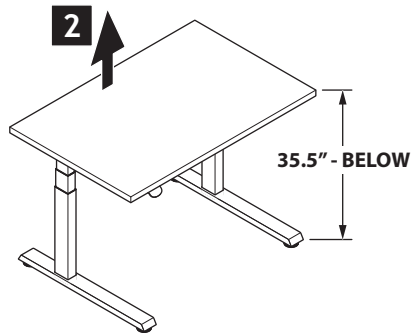
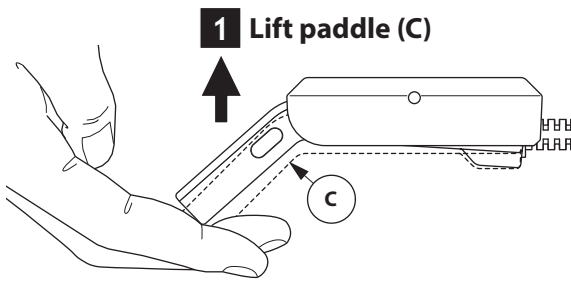

3 Press button (C2)

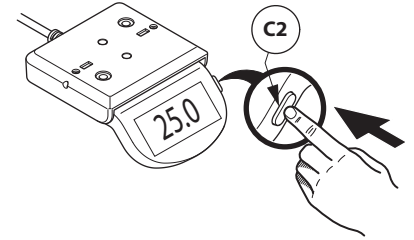

2

Tap paddle (C) up until "Favorite" menu is displayed

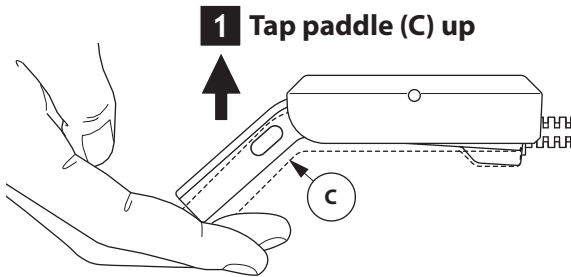

2

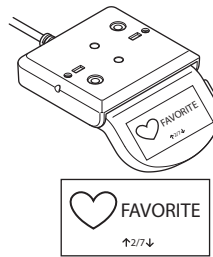

3 Press button (C2)

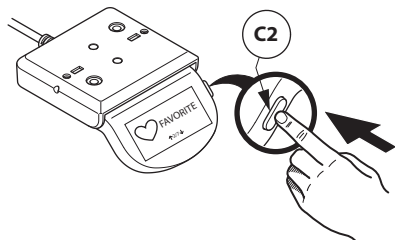

4 Press button (C2) again to set "Preset Height 2"

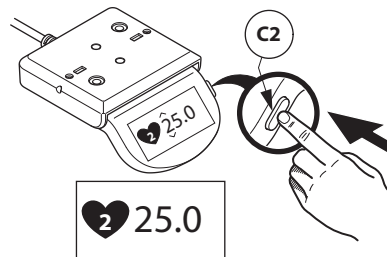

NOTE: Heart fills in.

Moving to a preset height

1

Lower to Preset Height 1 (42")

1 Tap paddle (C) down
2 times rapidly

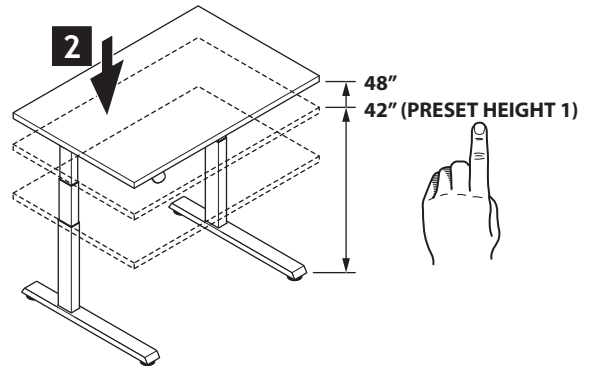
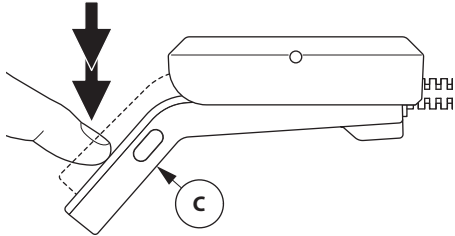

2

Lower to Preset Height 2 (25")

1 Tap paddle (C) down
2 times rapidly

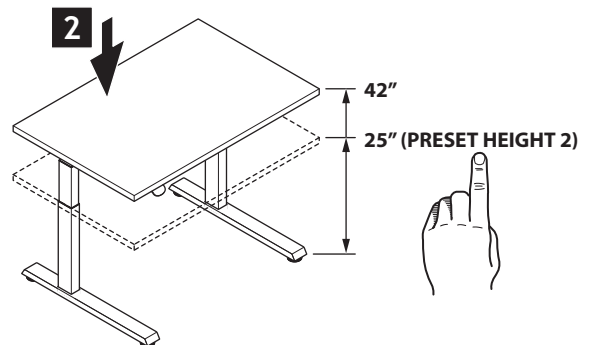
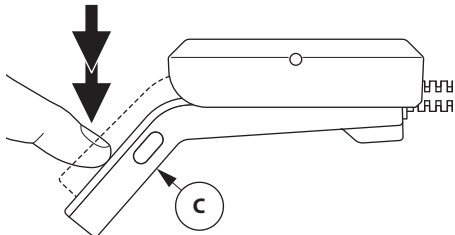

3

Raise back to Preset Height 1 (42")

1 Tap paddle (C) up
2 times rapidly

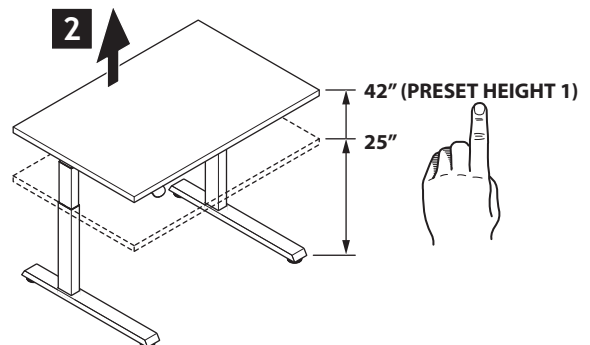
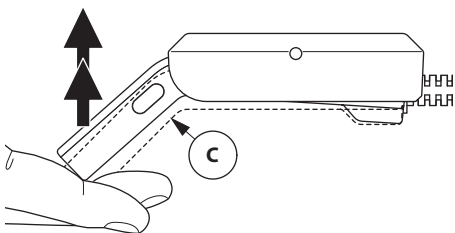

Set move reminder

1 Finding and setting the "REMINDER" setting

1 Press button (C2)

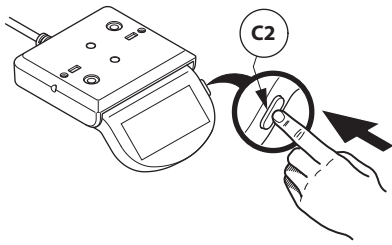

2 Tap paddle (C) up until the "REMINDER" menu is displayed

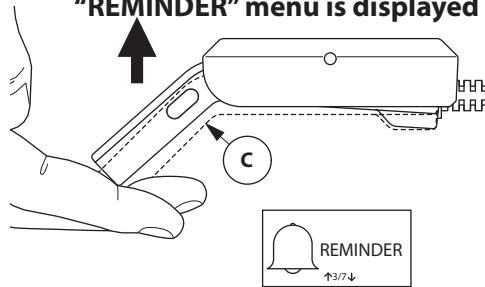

3 Press button (C2)

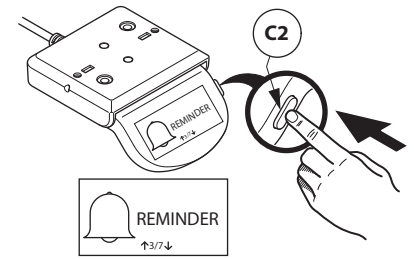

4 Tap paddle (C) up until the desired reminder is displayed

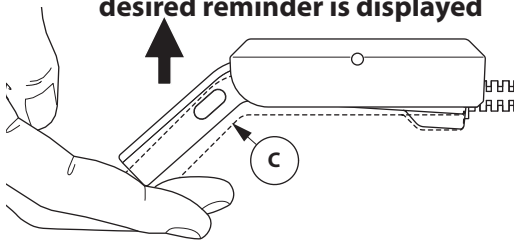

5 Press button (C2)

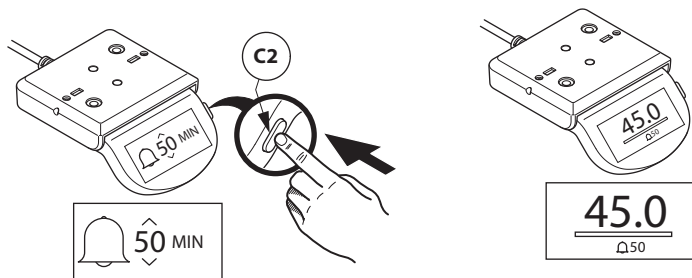

How move reminder bar works

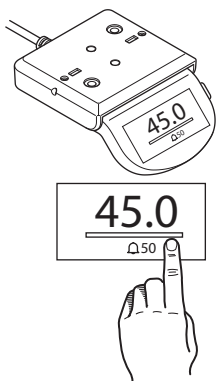

NOTE: If table height is **ABOVE** 40", the bar will not fill and the paddle **WILL NOT** vibrate.

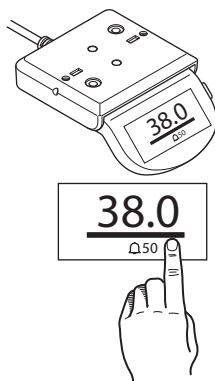

NOTE: If table height is **BELOW** 40", the bar begins to fill as each minute passes. when bar is full it will vibrate.

Resetting move reminder

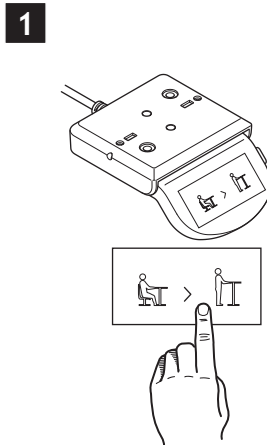

NOTE: When the time on the reminder bar is full the paddle will vibrate and display the above image.

2 Raise table above 40" to reset the move reminder

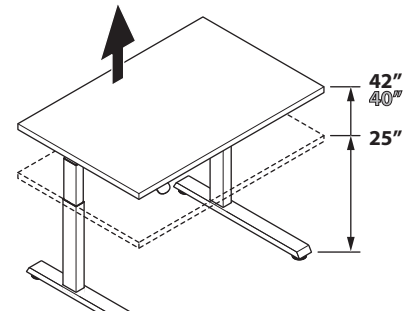

3 Lower table height **BELOW** 40", and the bar begins filling again.

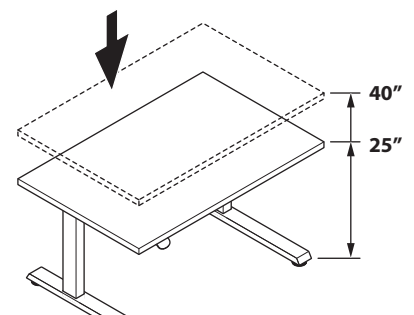

Turn off reminder

1 Press button (C2)

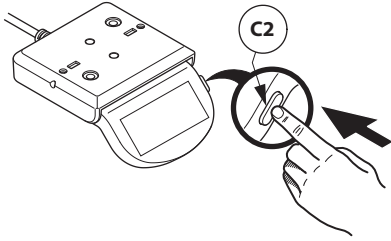

2 Tap paddle (C) up until the "REMINDER" menu is displayed

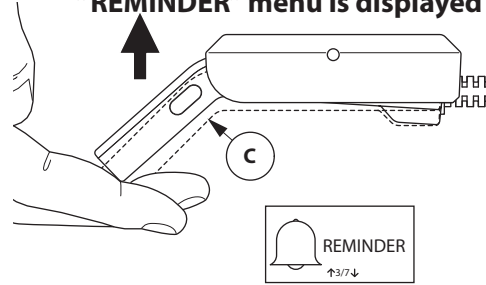

3 Press button (C2)

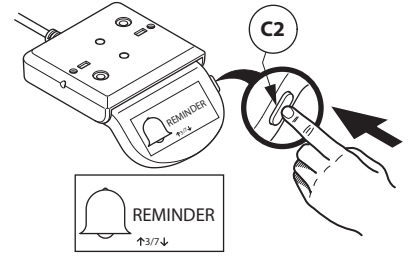

4 Tap paddle (C) up until the "turn off reminder" is displayed

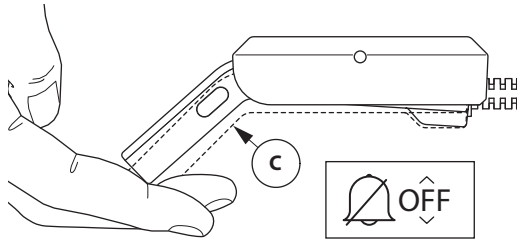

5 Press button (C2)

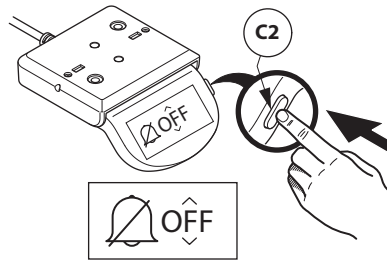

Set Upper and Lower Storage Stop

1

Set upper storage stop

1 Raise table to desired upper storage stop height

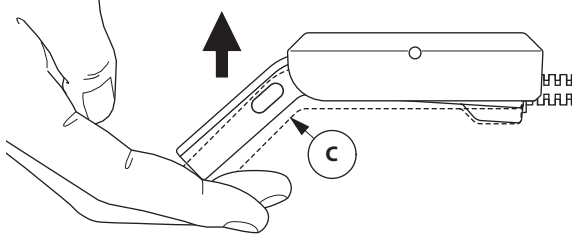

2

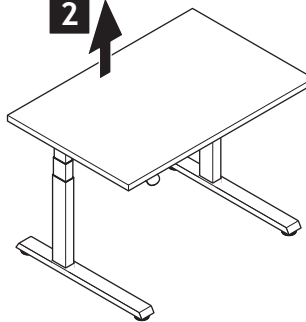

3 Press button (C2)

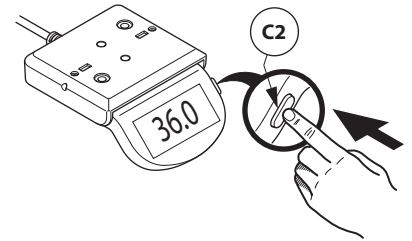

4 Tap paddle (C) up until "Limits" is displayed

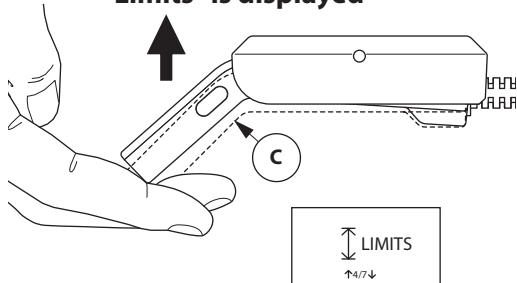

5 Press button (C2)

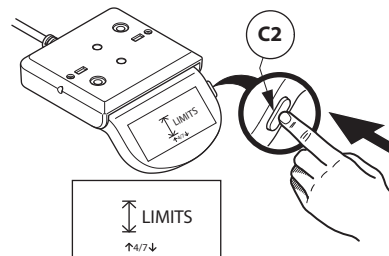

6 Tap paddle (C) up until the "UPPER STORAGE STOP" page is displayed

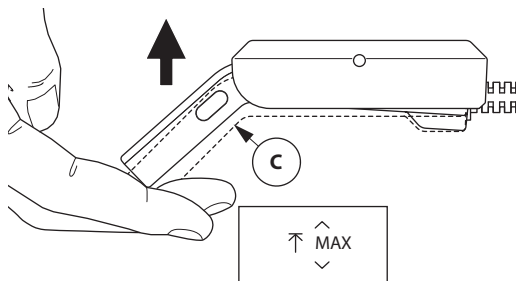

7 Press button (C2) to set upper storage stop height

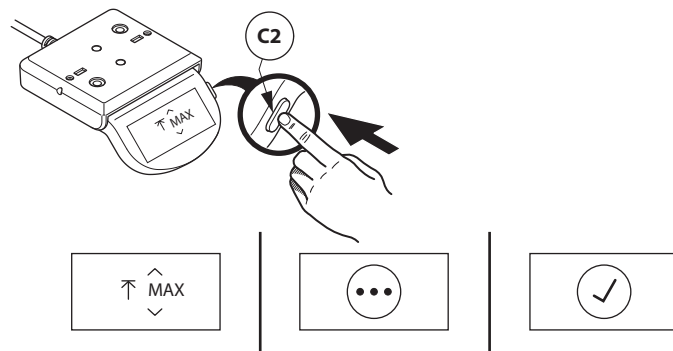

CUSTOMER SERVICE PHONE: 1-800-426-8562

HAWORTH

E.C.O. No: 245-693

Page: 9 of 20

Part No: 6100-0110

Rev: 3

Set Upper and Lower Storage Stop

2

Set lower storage stop

1 Press paddle (C) down

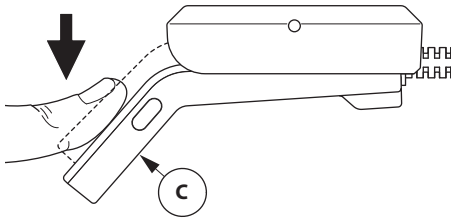

2

Lower table to desired lower storage stop height

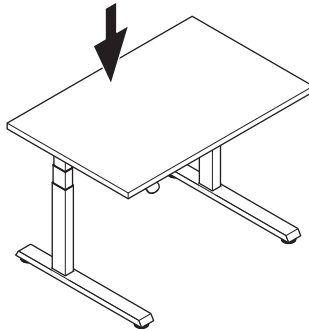

3

Press button (C2)

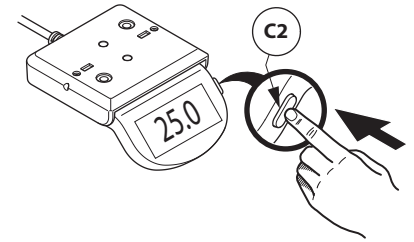

4

Tap paddle (C) up until the "LIMITS" menu is displayed

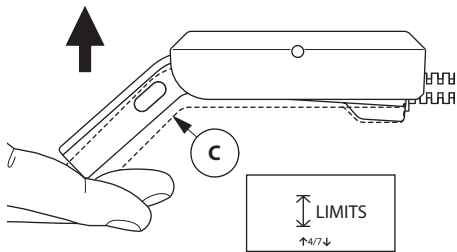

5

Press button (C2)

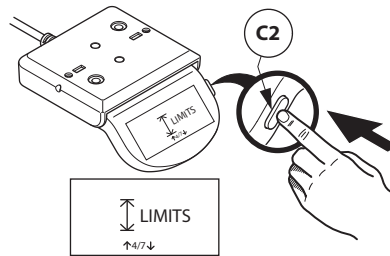

6

Tap paddle (C) up until the "LOWER STORAGE STOP" page is displayed

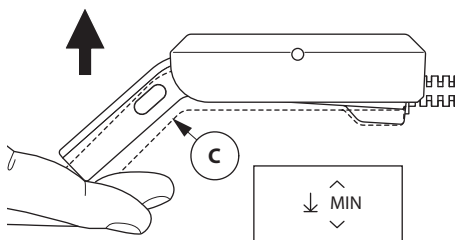

7

Press button (C2) to set lower storage stop height

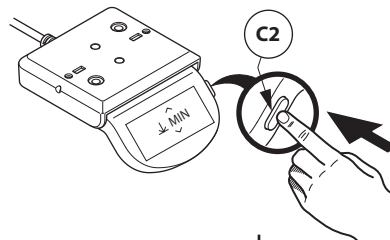

NOTE: Performing a reset with lower storage stop enabled will stop the table at lower storage stop. User will have to release paddle and then press again to reach lowest position to complete reset.

Once reset is complete, the table will rise to lower stop storage height.

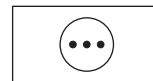

Clear Upper and Lower Storage Stop

3

1 Press button (C2)

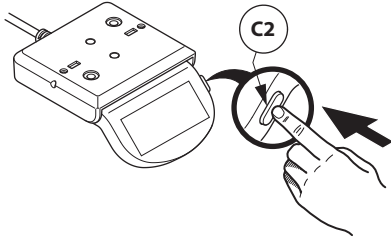

2 Tap paddle (C) up until the "LIMITS" menu is displayed

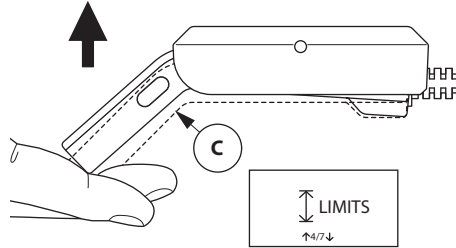

3 Press button (C2)

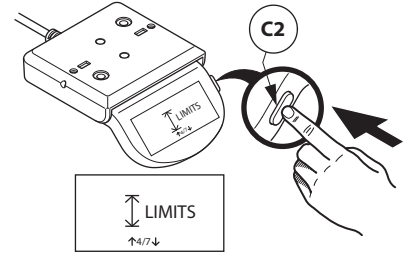

4 Press paddle (C) down until the "CLEAR UPPER AND LOWER STORAGE STOP" page is displayed

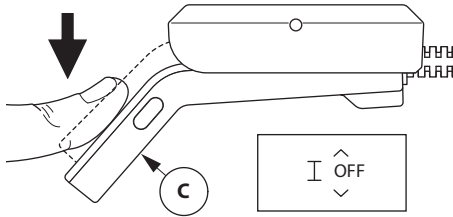

5 Press button (C2) to clear upper and lower storage stop height

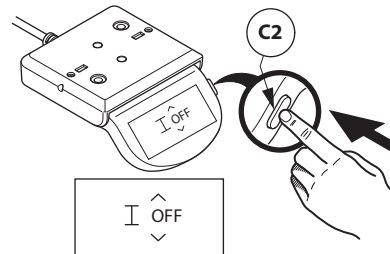

Set Lock Mode

1 Follow steps to set "Lock Mode"

1 Press button (C2)

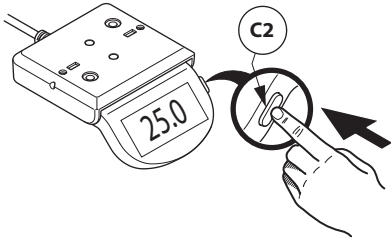

2 Tap paddle (C) up until "LOCK" menu is displayed

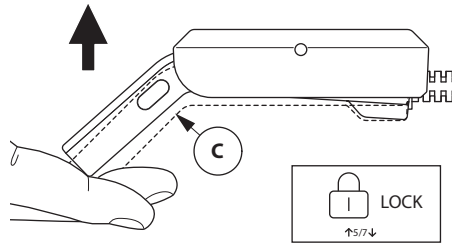

3 Press button (C2)

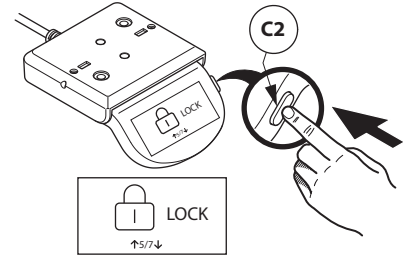

4 Tap paddle (C) up until "LOCK" is displayed

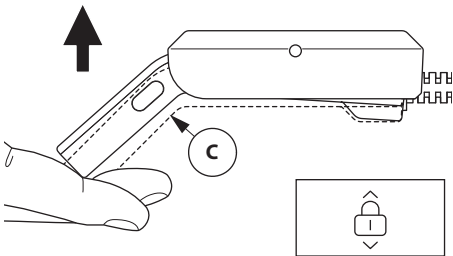

5 Press button (C2) to set lock on paddle automatically after 10 seconds of inactivity

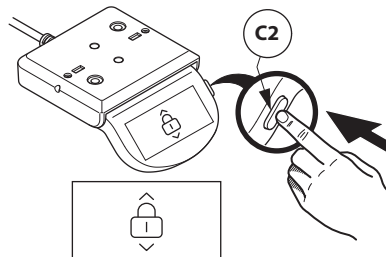

The Lock Mode

2

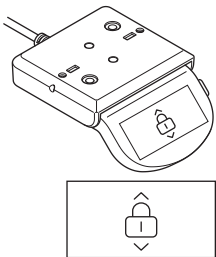

NOTE: Once 10 seconds of inactivity has elapsed, the paddle (C) will automatically lock, preventing any change to the table height or user settings.

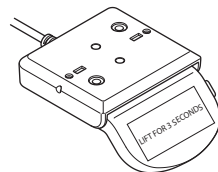

LIFT FOR 3 SECONDS

NOTE: Lifting for 3 seconds will unlock paddle (C).

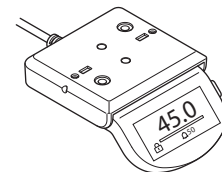

45.0

Δ.50

NOTE: A lock icon will be displayed on the home screen when the lock mode is active.

Turn off Lock

3

1 Press button (C2)

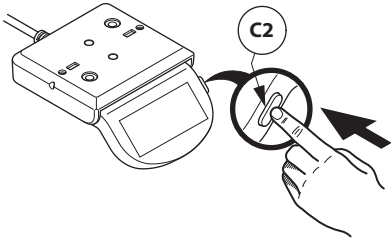

2 Tap paddle (C) up until "LOCK" menu is displayed

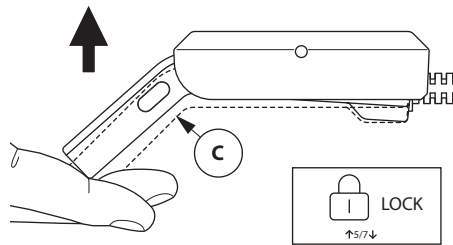

3 Press button (C2)

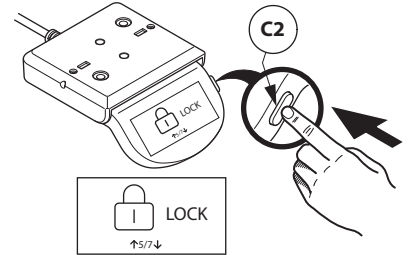

4 Tap paddle (C) up until "UNLOCK" is displayed

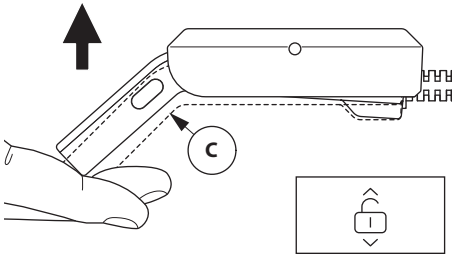

5 Press button (C2)

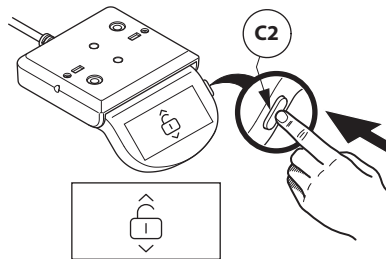

Set Vibration Pattern

1 Follow steps to set "Vibration Pattern"

1 Press button (C2)

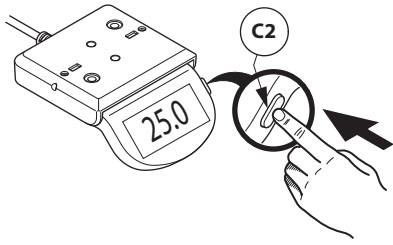

2 Tap paddle (C) up until "VIBRATION" menu is displayed

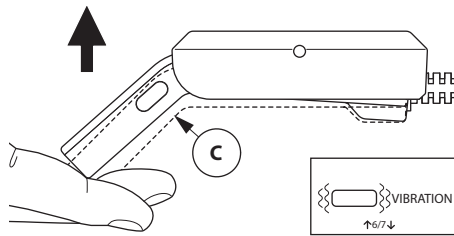

3 Press button (C2)

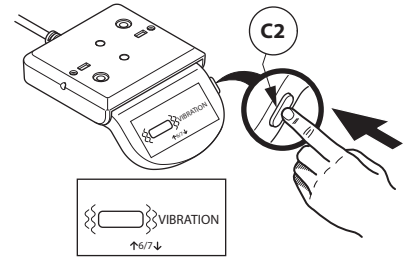

4 Tap paddle (C) up until desired "VIBRATION PATTERN" is displayed

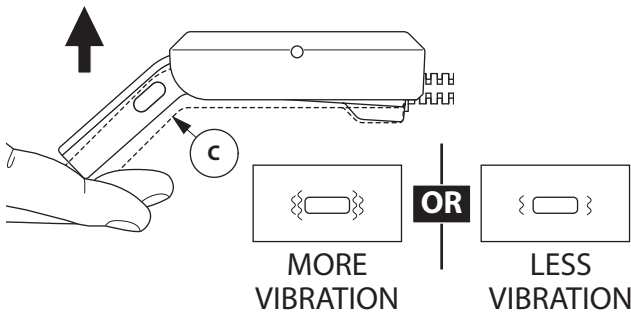

5 Press button (C2)

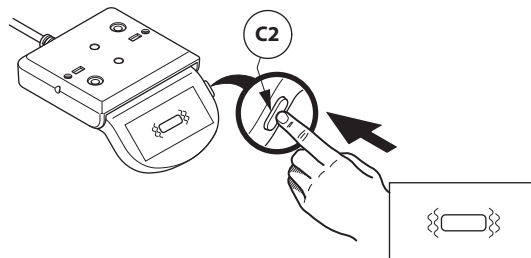

Clear Vibration Pattern

1 Press button (C2)

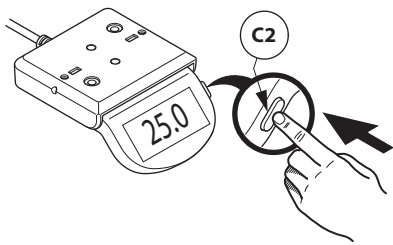

2 Tap paddle (C) up until "VIBRATION" menu is displayed

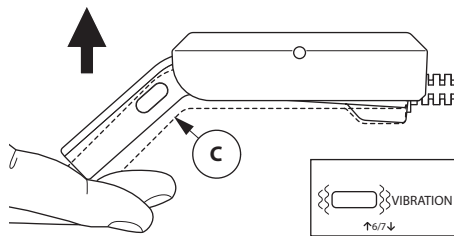

3 Press button (C2)

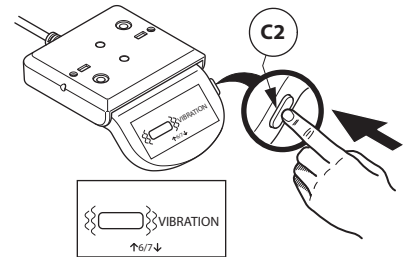

4 Tap paddle (C) up until the "TURN OFF VIBRATION PATTERN" page is displayed

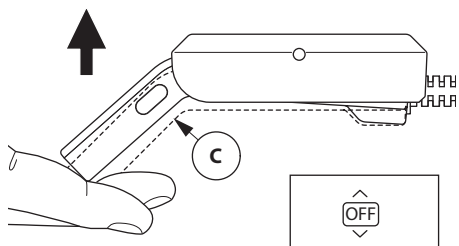

5 Press button (C2)

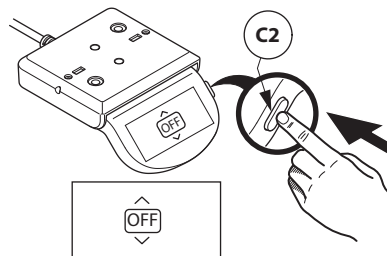

Change Collision Detection Sensitivity

1 Follow steps to change Collision Detection Sensitivity

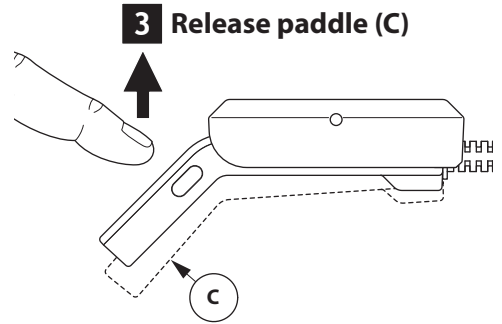
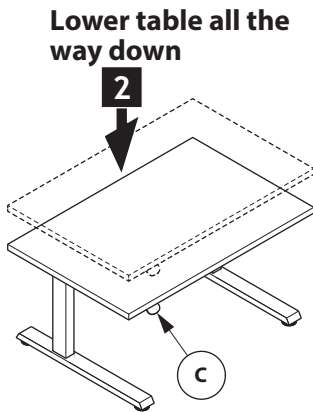
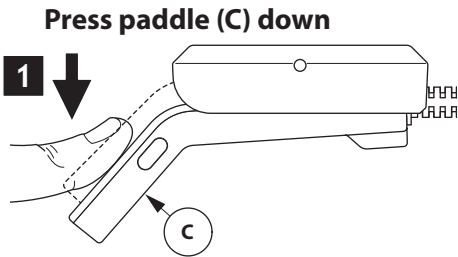

2 Hold down paddle (C) for 15 seconds and release

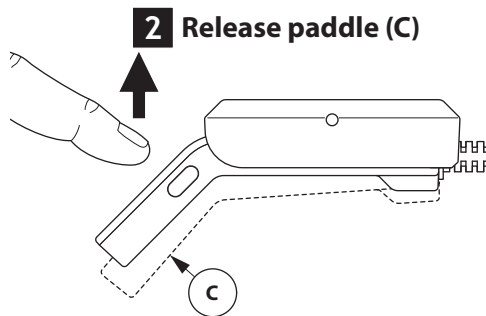
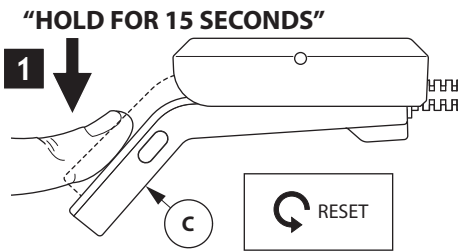

3 Lift paddle (C) and hold until a number is displayed

NOTE: Repeat this step until desired sensitivity is displayed.

Hold paddle (C) up until desired sensitivity is achieved

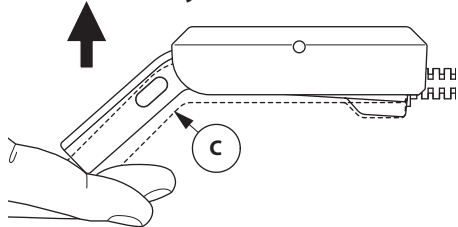

<div style="border: 1px solid black; padding: 5px; width: 40px; margin: 0 auto;">10.5</div> <p>MOST SENSITIVE</p>	OR	<div style="border: 1px solid black; padding: 5px; width: 40px; margin: 0 auto;">10.6</div> <p>MODERATE SENSITIVITY</p>	OR	<div style="border: 1px solid black; padding: 5px; width: 40px; margin: 0 auto;">10.7</div> <p>LEAST SENSITIVE</p>
---	-----------	---	-----------	--

4 Press paddle (C) down and hold until table reset is complete

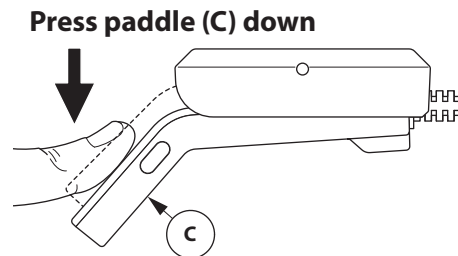

HAWORTH

Upside Table

Troubleshooting Guide

Note: Parts of this guide require a programmable paddle handset, service part # 8754-8401.

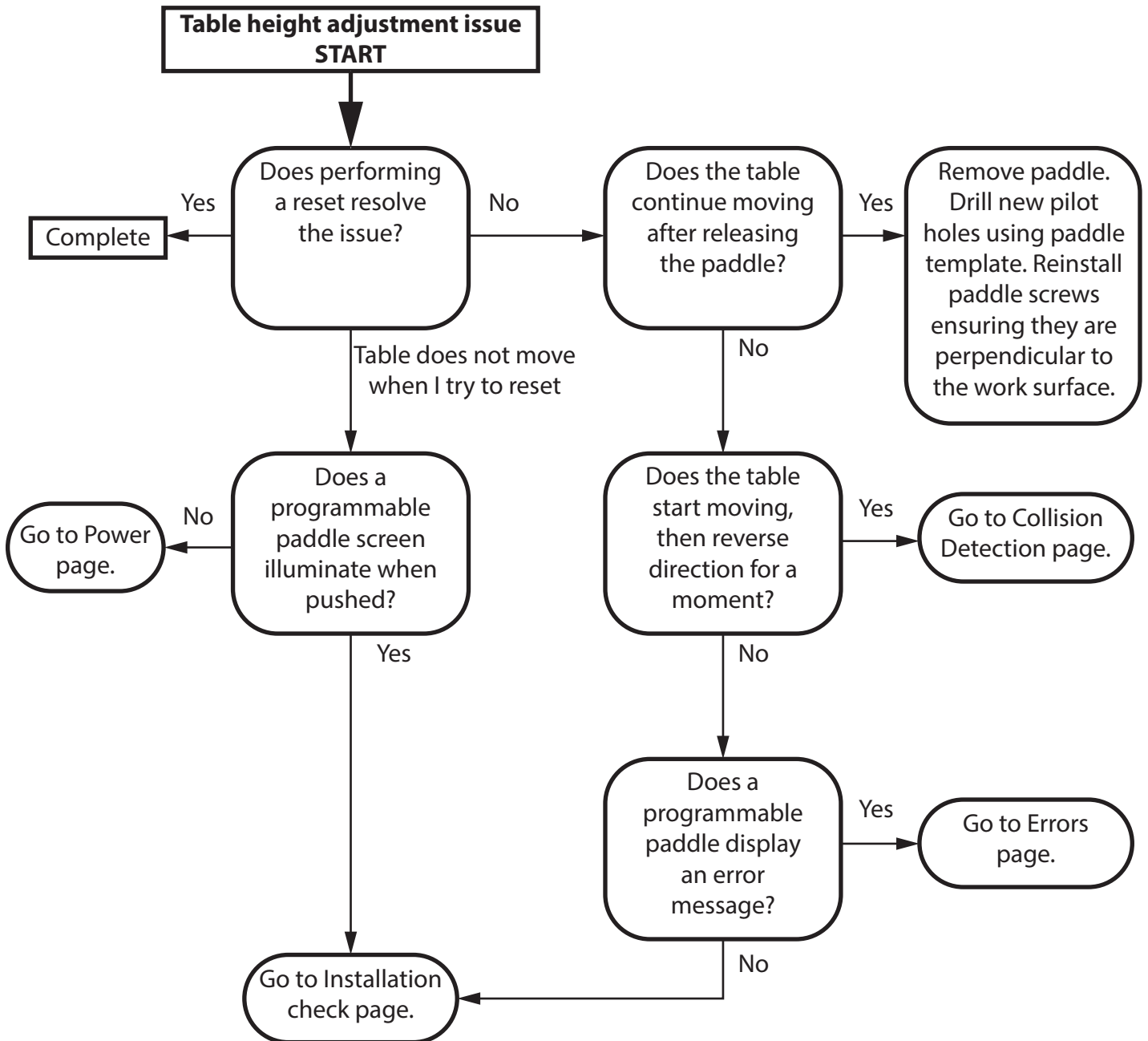

HAWORTH

Upside Table

Collision Detection

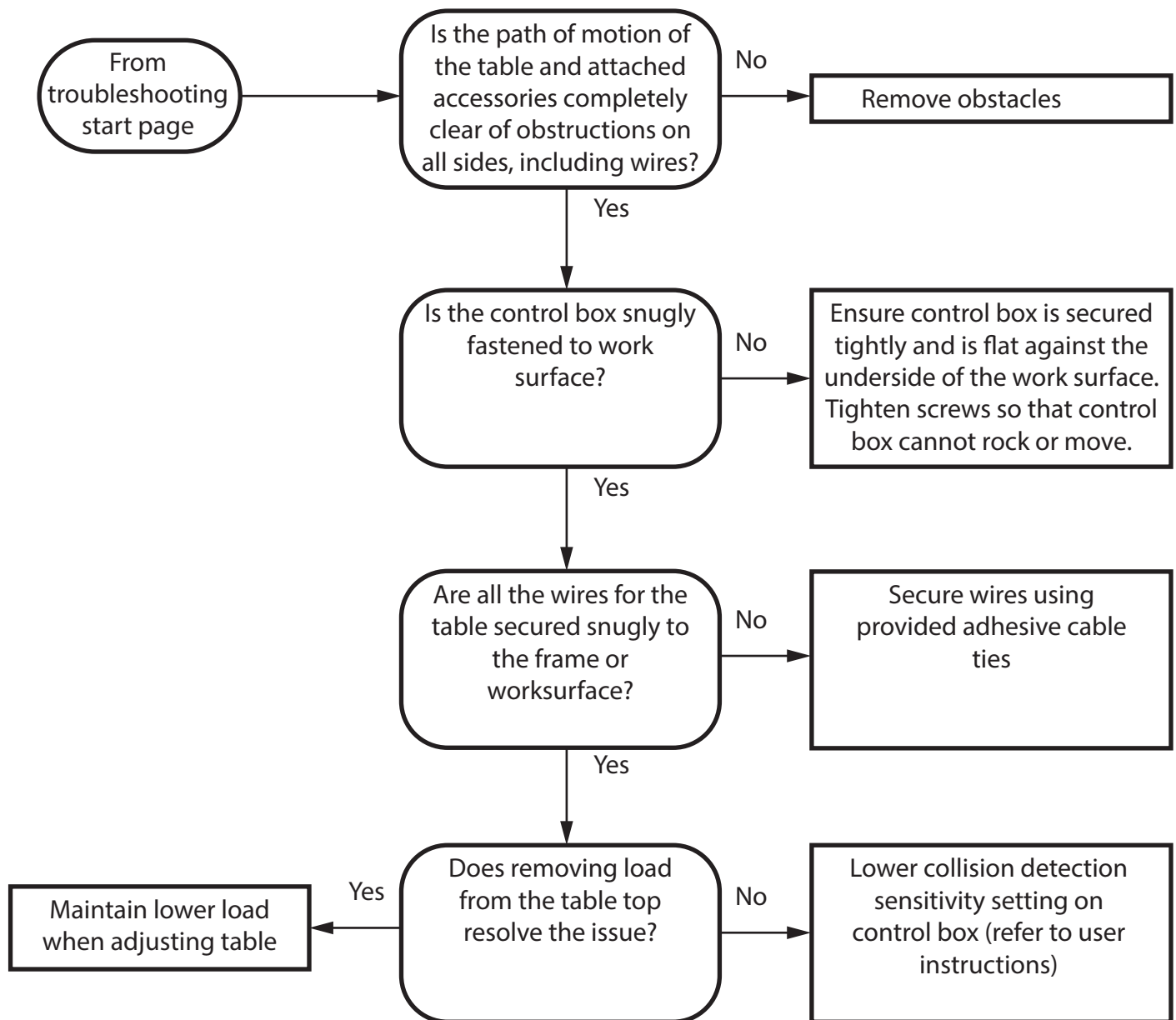

HAWORTH

Upside Table

Errors

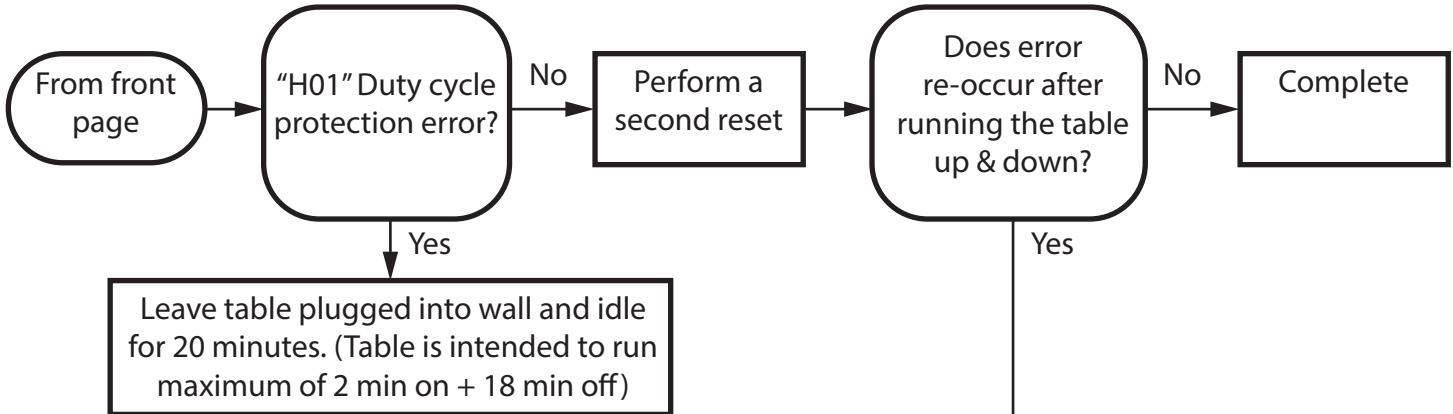

Error	Description	Troubleshooting steps
E01	M1 overcurrent protection	1) Identify which column is plugged into M1 port on control box 2) Reduce load over M1 column
E02	M2 overcurrent protection	1) Identify which column is plugged into M2 port on control box 2) Reduce load over M2 column
E07	M1 Hall effect sensor	1) Unplug and re-plug M1 cable
E08	M2 Hall effect sensor	1) Unplug and re-plug M2 cable
LOC	Handset locked	1) Replace handset 2) Unplug table for 20 seconds and plug back in

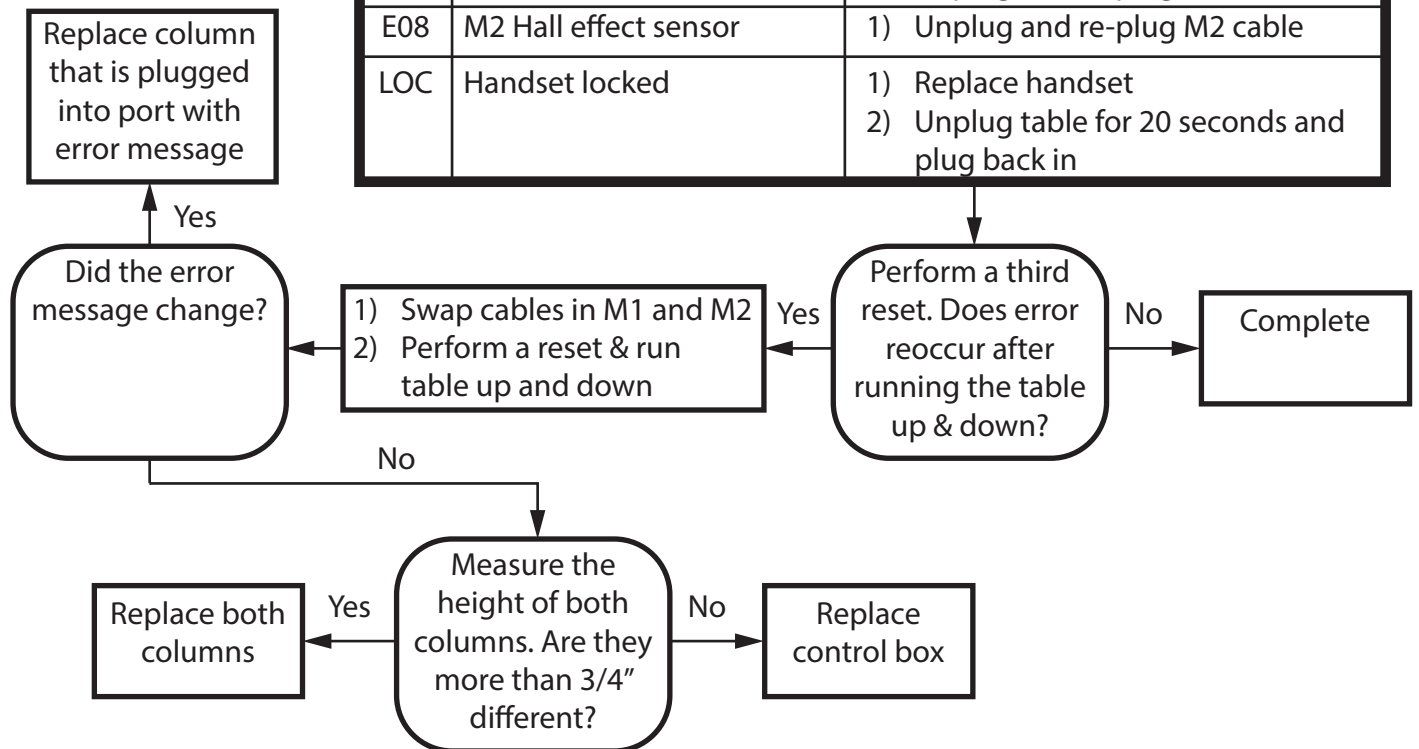

HAWORTH Upside Table Power

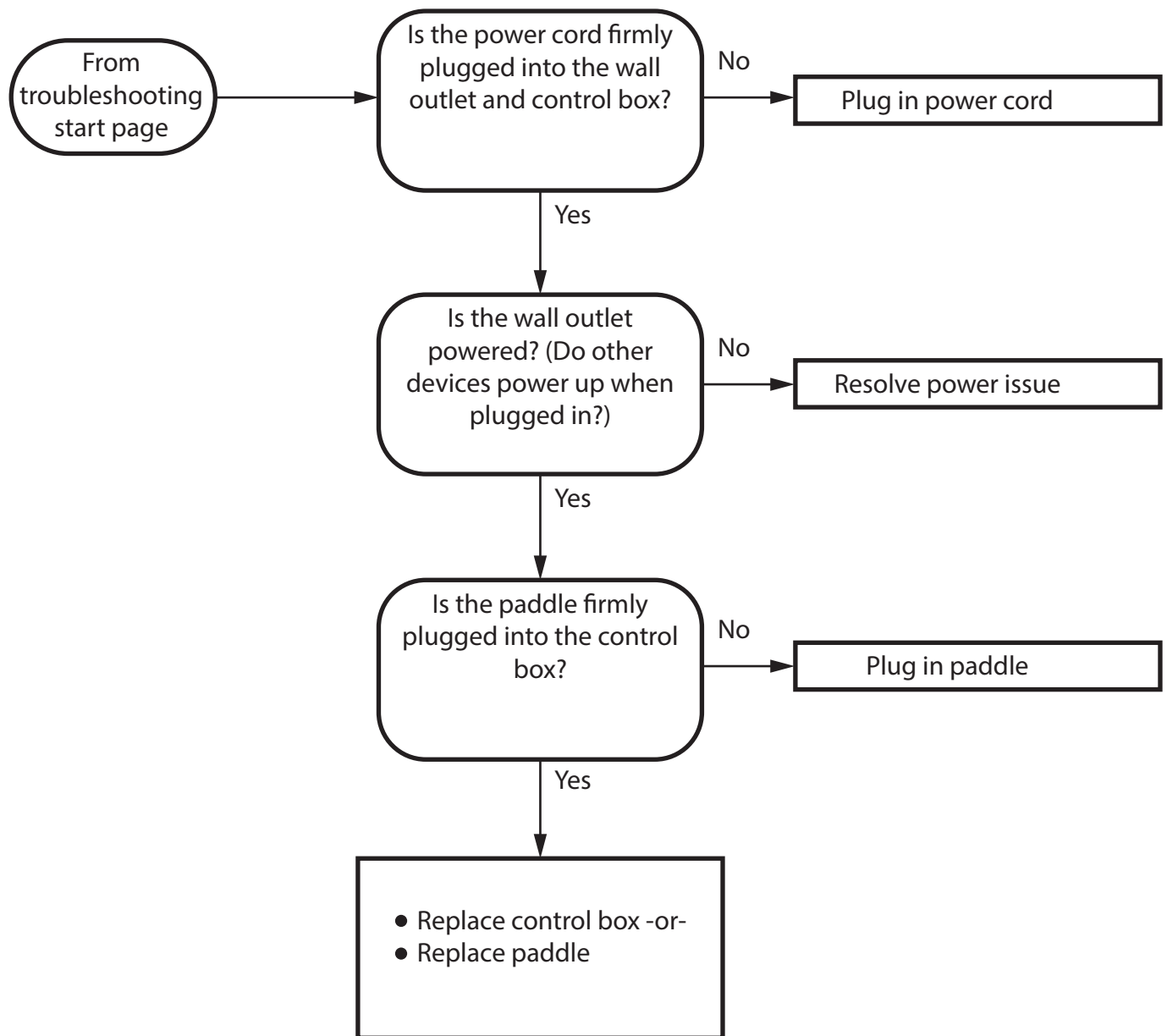

HAWORTH

Upside Table

Installation Check

