

# Trivati Architectural Details

## Trivati Panels

- Trivati Double Glazed Wall with 2.5" Bottom Rail - Vertical Section
- Trivati Offset Glazed Wall with 2.5" Bottom Rail - Vertical Section
- Trivati Center Glazed Wall with 2.5" Bottom Rail - Vertical Section
- Trivati Triple Glazed Wall with 2.5" Bottom Rail - Vertical Section
- Trivati Double Glazed Wall with 1.5" Bottom Rail - Vertical Section
- Trivati Offset Glazed Wall with 1.5" Bottom Rail - Vertical Section
- Trivati Center Glazed Wall with 1.5" Bottom Rail - Vertical Section
- Trivati Triple Glazed Wall with 1.5" Bottom Rail - Vertical Section
- Trivati Solid Wall with 2.5" Bottom Rail - Vertical Section
- Trivati Solid Wall with 1.5" Bottom Rail - Vertical Section
- Trivati Solid Wall - Horizontal Section
- Trivati Combination Wall - Vertical Sections

## Trivati Doors

- Trivati Double Glazed Sliding Door Beneath Ceiling Tile - Vertical Section
- Trivati Double Glazed Sliding Door Beneath GWB Soffit - Vertical Section
- Trivati Glass Slab Sliding Door Beneath Ceiling Tile - Vertical Section
- Trivati Glass Slab Sliding Door Beneath GWB Soffit - Vertical Section
- Trivati Double Glazed Pivot Door Beneath Ceiling Tile - Vertical Section
- Trivati Double Glazed Pivot Door Beneath GWB Soffit - Vertical Section
- Trivati Glass Slab Pivot Door Beneath Ceiling Tile - Vertical Section
- Trivati Glass Slab Pivot Door Beneath GWB Soffit - Vertical Section
- Trivati Wood Slab Pivot Door Beneath Ceiling Tile - Vertical Section
- Trivati Wood Slab Pivot Door Beneath GWB Soffit - Vertical Section
- Trivati Wood Glazed Pivot Door Beneath Ceiling Tile - Vertical Section
- Trivati Wood Glazed Pivot Door Beneath GWB Soffit - Vertical Section
- Trivati Sliding Door Typical - Horizontal Section
- Trivati Pivot Door Typical - Horizontal Section

HAWORTH

# Trivati Architectural Details

## Fly-by Transitions

- Trivati Fly-By with 3.5" Cover Kit Back-to-Back Double Glazed Pivot Doors
- Trivati Fly-By with 3.5" Cover Kit Offset Glazed Wall Span and Glass Slab Pivot Door
- Trivati Fly-By with 3.5" Cover Kit Double Glazed Wall Span and Wood Pivot Door
- Trivati Trivati Fly-By with 3.5" Cover Kit Offset Glazed Wall Span and Double Glazed Sliding Door
- Trivati Fly-By with 3.5" Cover Kit Back-to-Back Double Glazed Sliding Doors
- Trivati Fly-By with 3.5" Cover Kit Back-to-Back Glass Slab Sliding Doors
- Trivati Fly-By with 3.5" Cover Kit Offset Glazed Wall Span and Glass Slab Sliding Door
- Trivati Fly-By with 3.5" Cover Kit Double Glazed Wall Spans
- Trivati Fly-By with 3.5" Cover Kit Offset Glazed Wall Spans
- Trivati Fly-By with 3.5" Cover Kit Center Glazed Wall Spans
- Trivati Fly-By with 5" Cover Kit Back-to-Back Double Glazed Pivot Doors
- Trivati Fly-By with 5" Cover Kit Offset Glazed Wall Span and Glass Slab Pivot Door
- Trivati Fly-By with 5" Cover Kit Double Glazed Wall Span and Wood Pivot Door

## Inline Transitions

- Trivati Double Glazed Wall Span to Double Glazed Sliding Door
- Trivati Offset Glazed Wall Span to Double Glazed Sliding Door
- Trivati Double Glazed Wall Span to Glass Slab Sliding Door
- Trivati Offset Glazed Wall Span to Glass Slab Sliding Door
- Trivati Double Glazed Wall Span to Wood Pivot Door
- Trivati Center Glazed Wall Span to Wood Pivot Door

## Wall Starter

- Trivati Door Frame Starter Double Glazed Sliding Door
- Trivati Door Frame Starter Double Glazed Pivot Door
- Trivati Door Frame Starter Glass Slab Sliding Door
- Trivati 2.5" Starter with Removable Clad Double Glazed Wall Span
- Trivati 2.5" Starter with Removable Clad Offset Glazed Wall Span
- Trivati 1.5" Starter with Removable Clad Double Glazed Wall Span
- Trivati 1.5" Starter with Removable Clad Offset Glazed Wall Span
- Trivati 2.5" Starter Double Glazed Wall Span
- Trivati 2.5" Starter Offset Glazed Wall Span
- Trivati 1.5" Starter Double Glazed Wall Span
- Trivati 1.5" Starter Offset Glazed Wall Span
- Trivati 2.5" Starter 1-Channel

## Trivati Architectural Details

### 2-Way 90°

- Trivati 90° Corner Post Transition Offset Glazed Wall Span to Double Glazed Sliding Door
- Trivati 90° Corner Post Transition Double Glazed Wall Span to Glass Slab Pivot Door
- Trivati 90° Corner Post Transition Double Glazed Wall Span to Double Glazed Wall Span
- Trivati 90° Corner Post Transition Offset Glazed Wall Span to Double Glazed Wall Span
- Trivati 90° Corner Post Transition Offset Glazed Wall Span to Offset Glazed Wall Span

### 3-Way 90°

- Trivati 3-Way 90° with 3.5" Cover Kit Double Glazed Pivot Door and Double Glazed Wall Spans
- Trivati 3-Way 90° with 3.5" Cover Kit Glass Slab Pivot Door and Double Glazed Wall Spans
- Trivati 3-Way 90° with 3.5" Cover Kit Wood Pivot Door and Double Glazed Wall Spans
- Trivati 3-Way 90° with 3.5" Cover Kit Back-to-Back Glass Slab Pivot Doors and Center Glazed Wall Span
- Trivati 3-Way 90° with 3.5" Cover Kit Back-to-Back Wood Pivot Doors and Double Glazed Wall Span
- Trivati 3-Way 90° with 3.5" Cover Kit Back-to-Back Double Glazed Sliding Doors and Offset Glazed Wall Span
- Trivati 3-Way 90° with 3.5" Cover Kit Back-to-Back Glass Slab Sliding Doors and Double Glazed Wall Span
- Trivati 3-Way 90° with 3.5" Cover Kit Double Glazed Sliding Door, Double Glazed Wall Span and Center Glazed Wall Span
- Trivati 3-Way 90° with 3.5" Cover Kit Glass Slab Sliding Door, Offset Glazed Wall Span and Center Glazed Wall Span
- Trivati 3-Way 90° with 1-Channel Transition Rail
- Trivati 3-Way 90° with 3.5" Cover Kit Double Glazed Wall Spans
- Trivati 3-Way 90° with 3.5" Cover Kit offset Glazed Wall Spans and Center Glazed Wall Span
- Trivati 3-Way 90° with 3.5" Cover Kit Center Glazed Wall Spans

### End of Run

- Trivati End of Run Double Glazed Wall Span
- Trivati End of Run offset Glazed Wall Span
- Ceiling Connection
- Ceiling Tile Detail - Vertical Section
- GWB Ceiling Detail - Vertical Section
- Double Sliding Door Turnbuckle Support - Vertical Section
- Lateral Bracing - Vertical Section

HAWORTH

# Trivati Architectural Details

## Trivati Double Glazed Wall with 2.5" Bottom Rail - Vertical Section

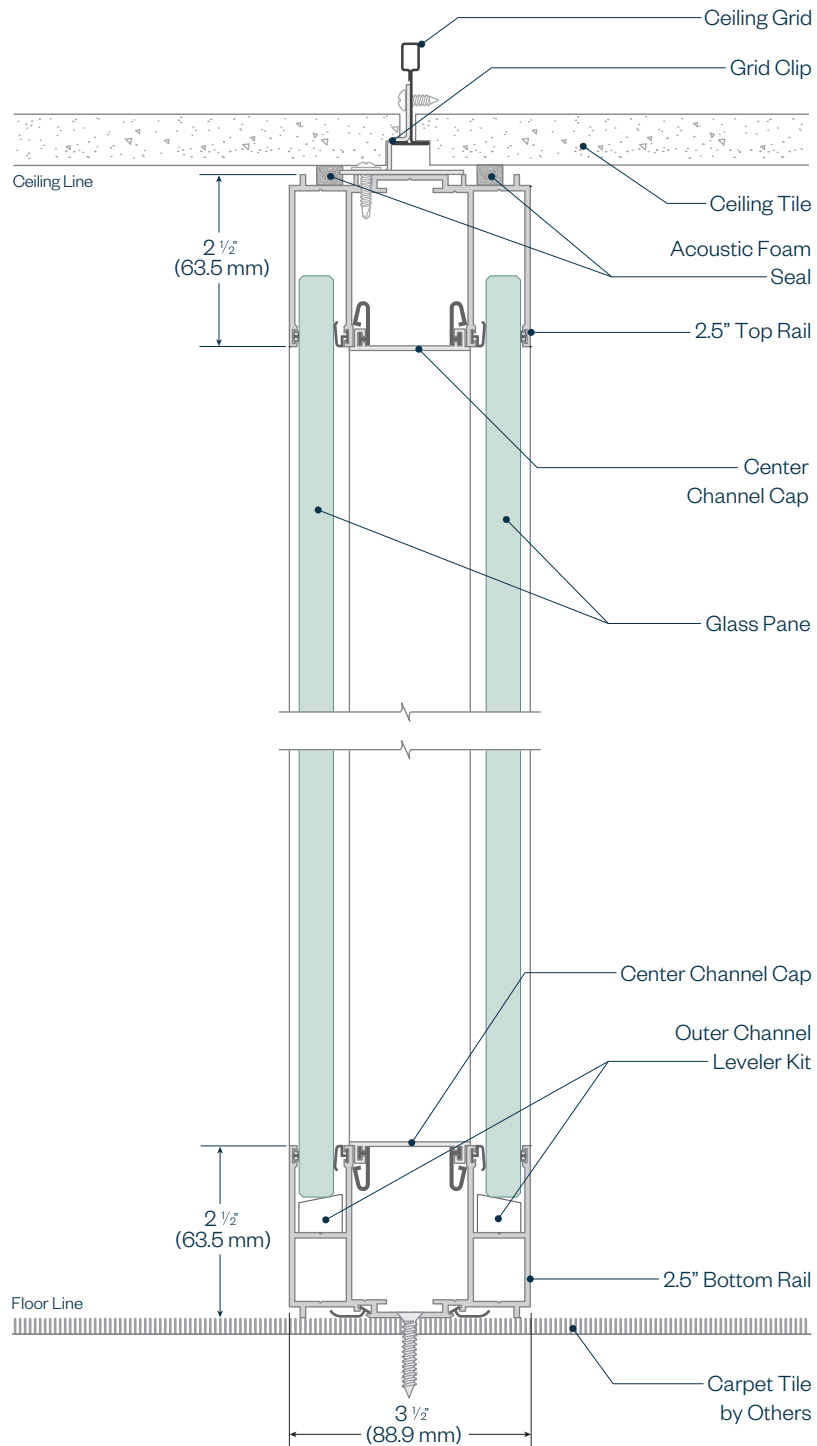



HAWORTH

# Trivati Architectural Details

## Trivati Offset Glazed Wall with 2.5" Bottom Rail - Vertical Section

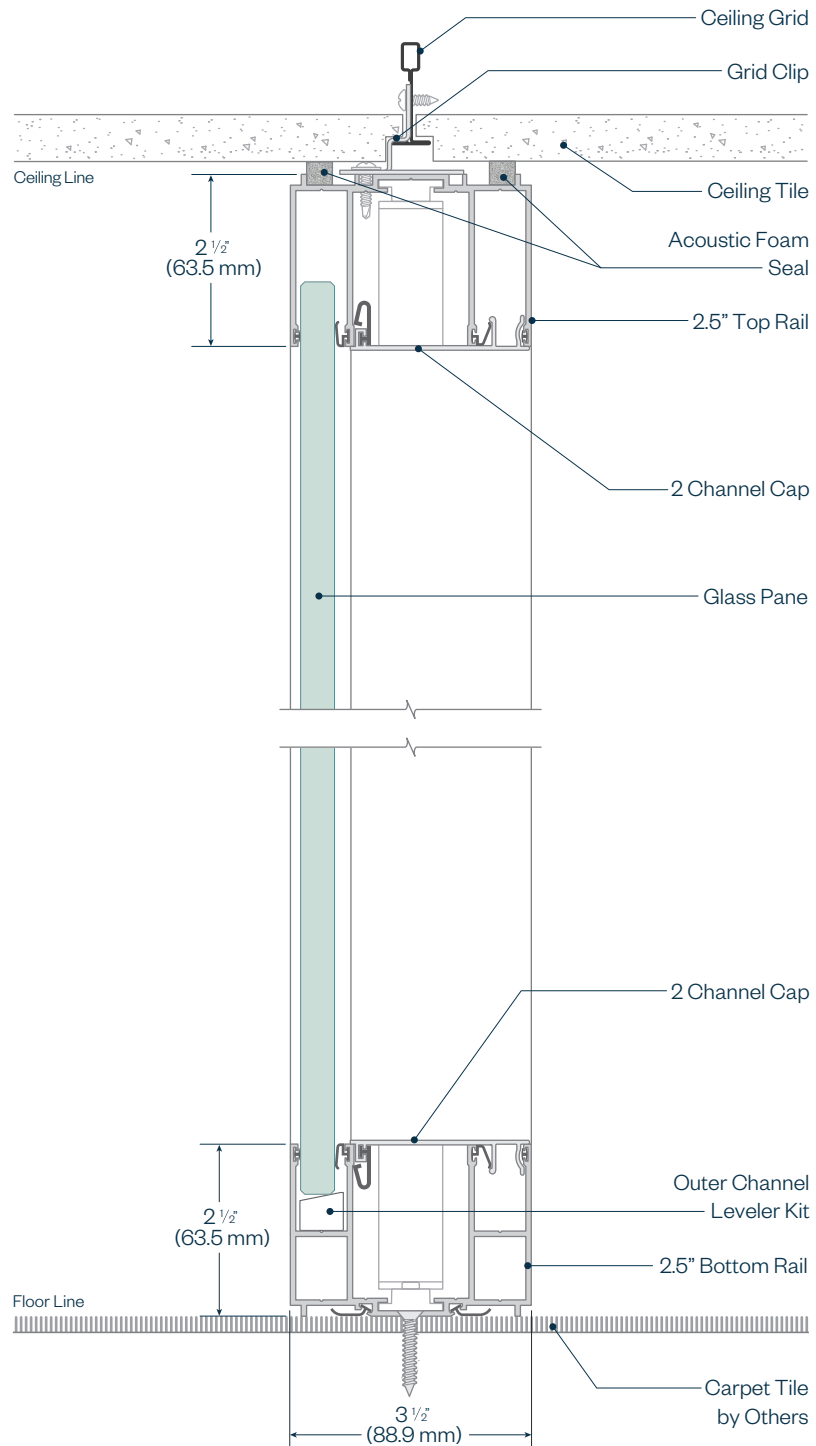

HAWORTH

# Trivati Architectural Details

## Trivati Center Glazed Wall with 2.5" Bottom Rail - Vertical Section

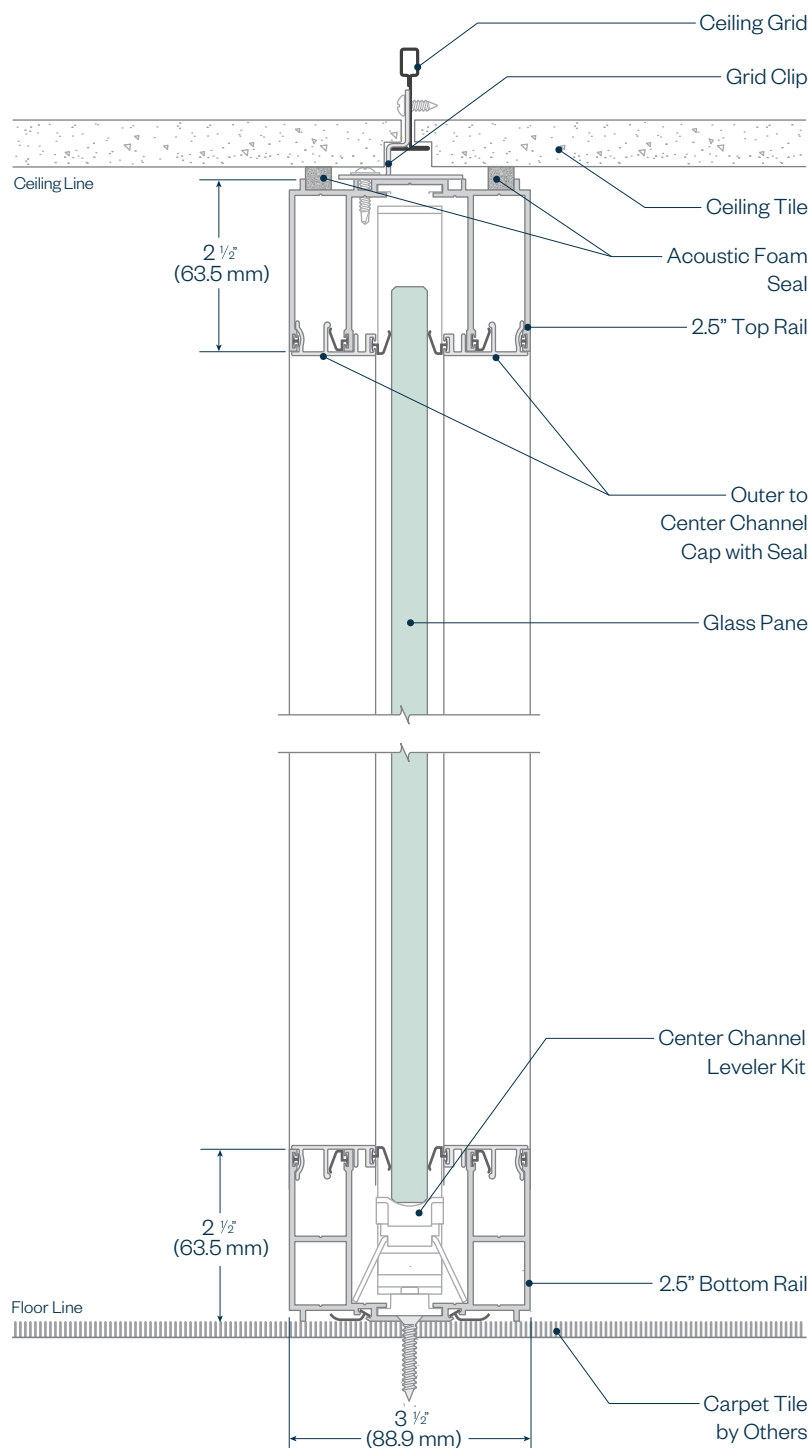

HAWORTH

# Trivati Architectural Details

## Trivati Triple Glazed Wall with 2.5" Bottom Rail - Vertical Section

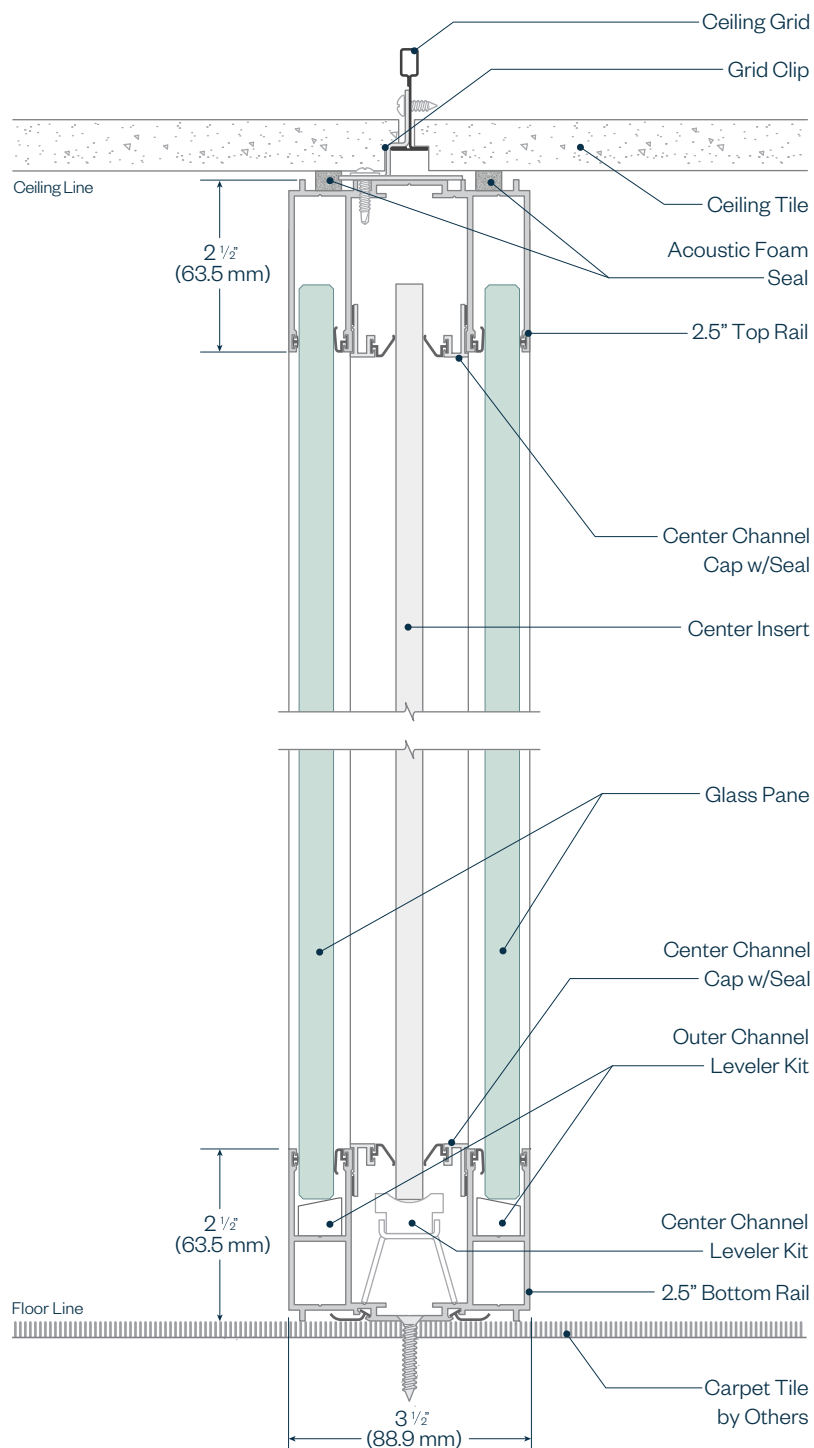

HAWORTH

# Trivati Architectural Details

## Trivati Double Glazed Wall with 1.5" Bottom Rail - Vertical Section

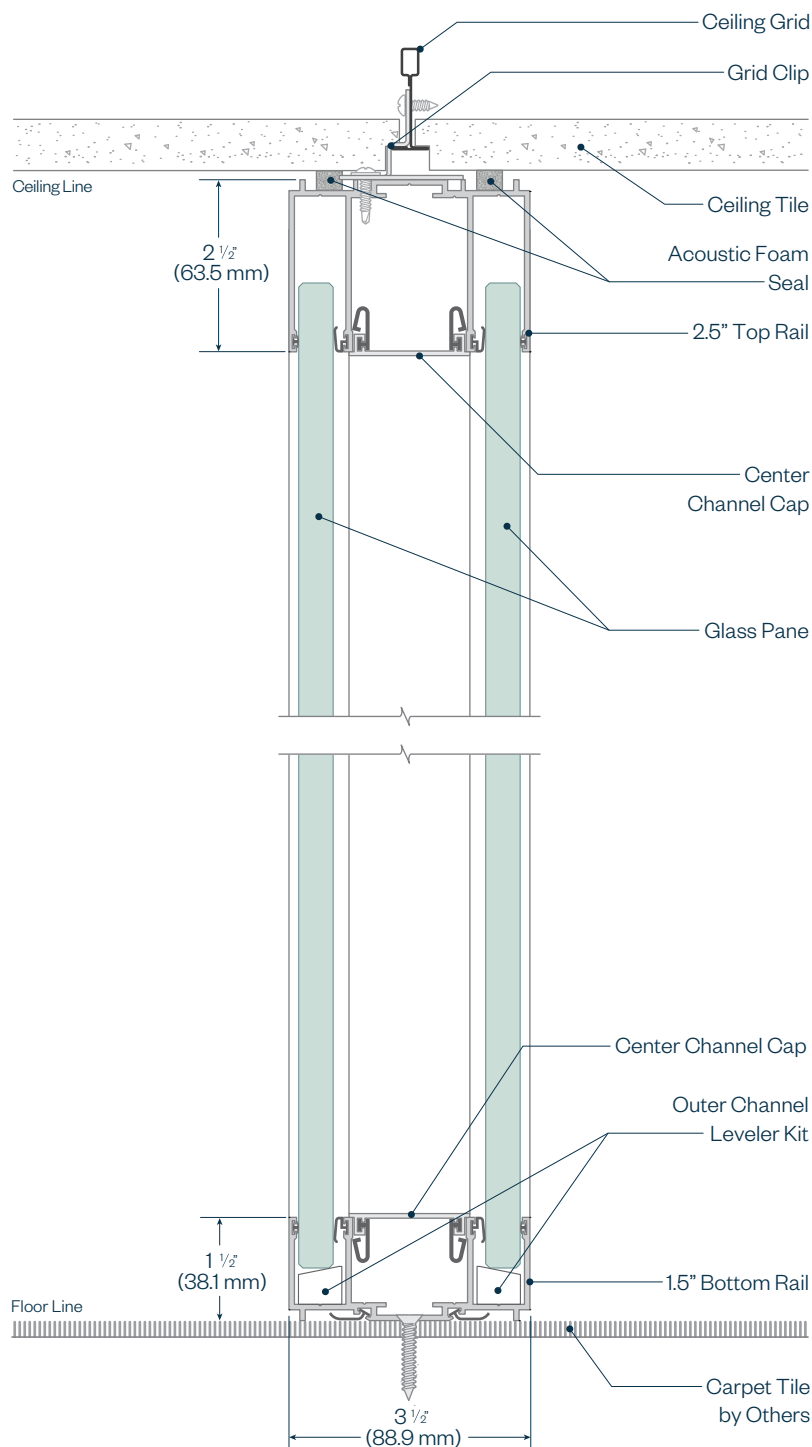

HAWORTH

# Trivati Architectural Details

## Trivati Offset Glazed Wall with 1.5" Bottom Rail - Vertical Section

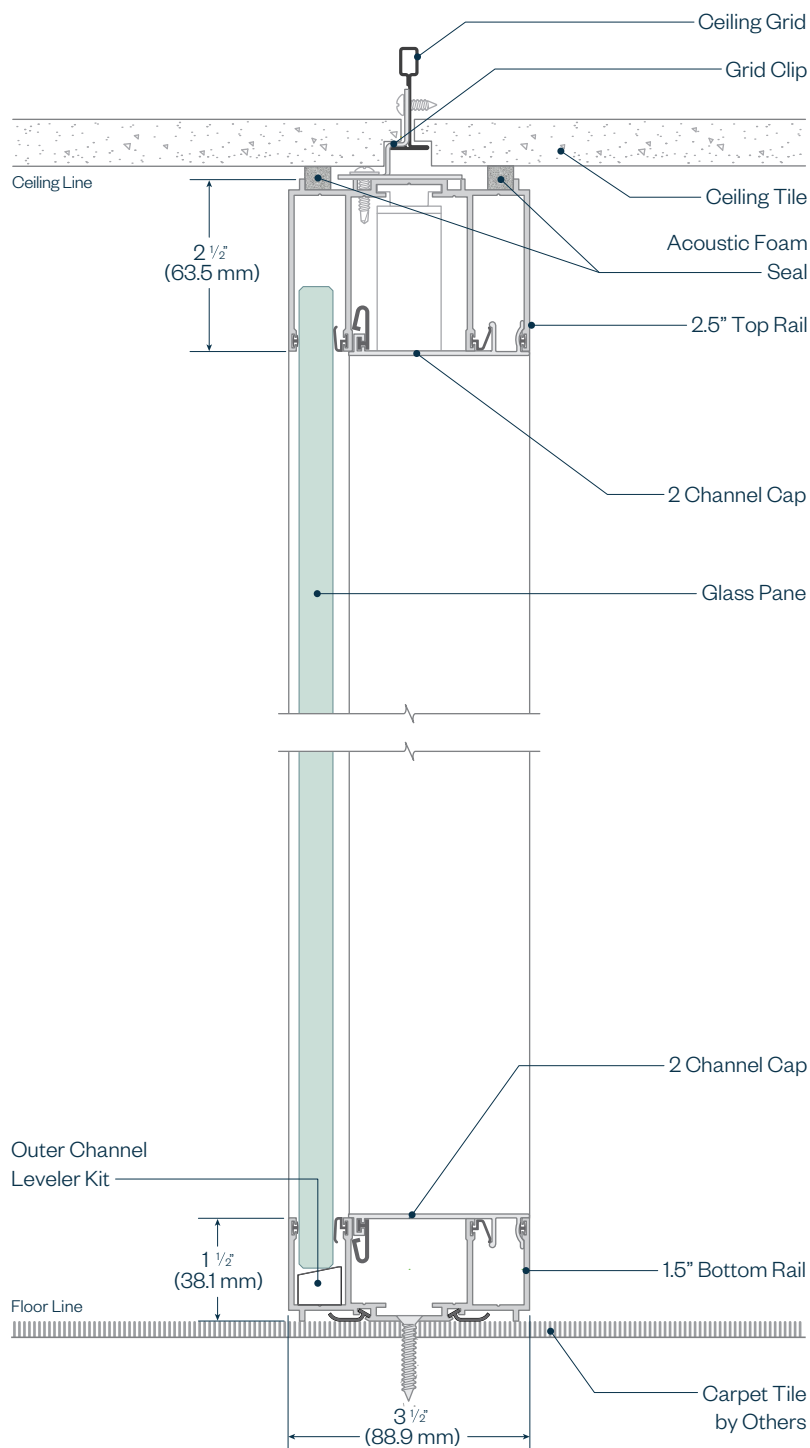

HAWORTH

# Trivati Architectural Details

## Trivati Center Glazed Wall with 1.5" Bottom Rail - Vertical Section

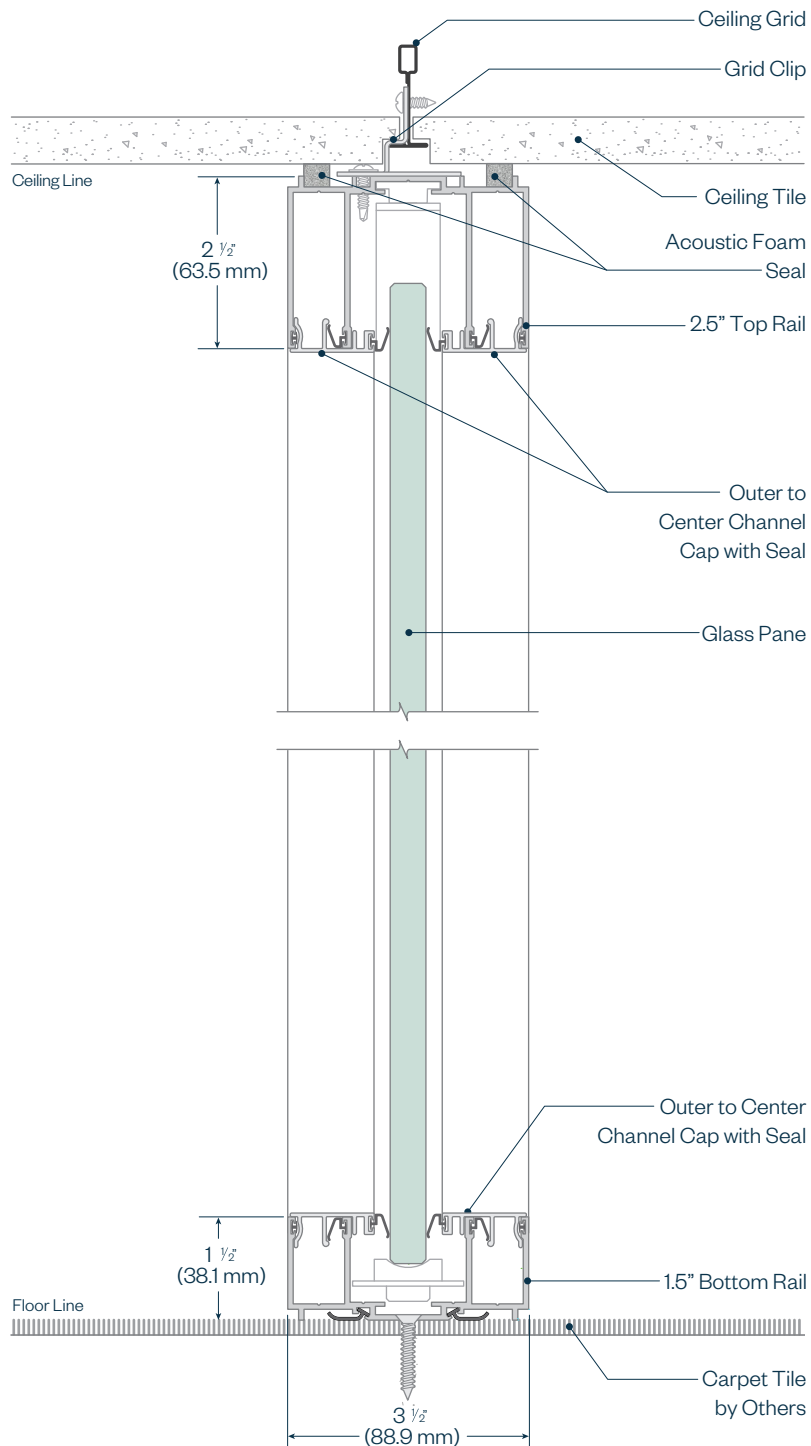

HAWORTH

# Trivati Architectural Details

## Trivati Triple Glazed Wall with 1.5" Bottom Rail - Vertical Section

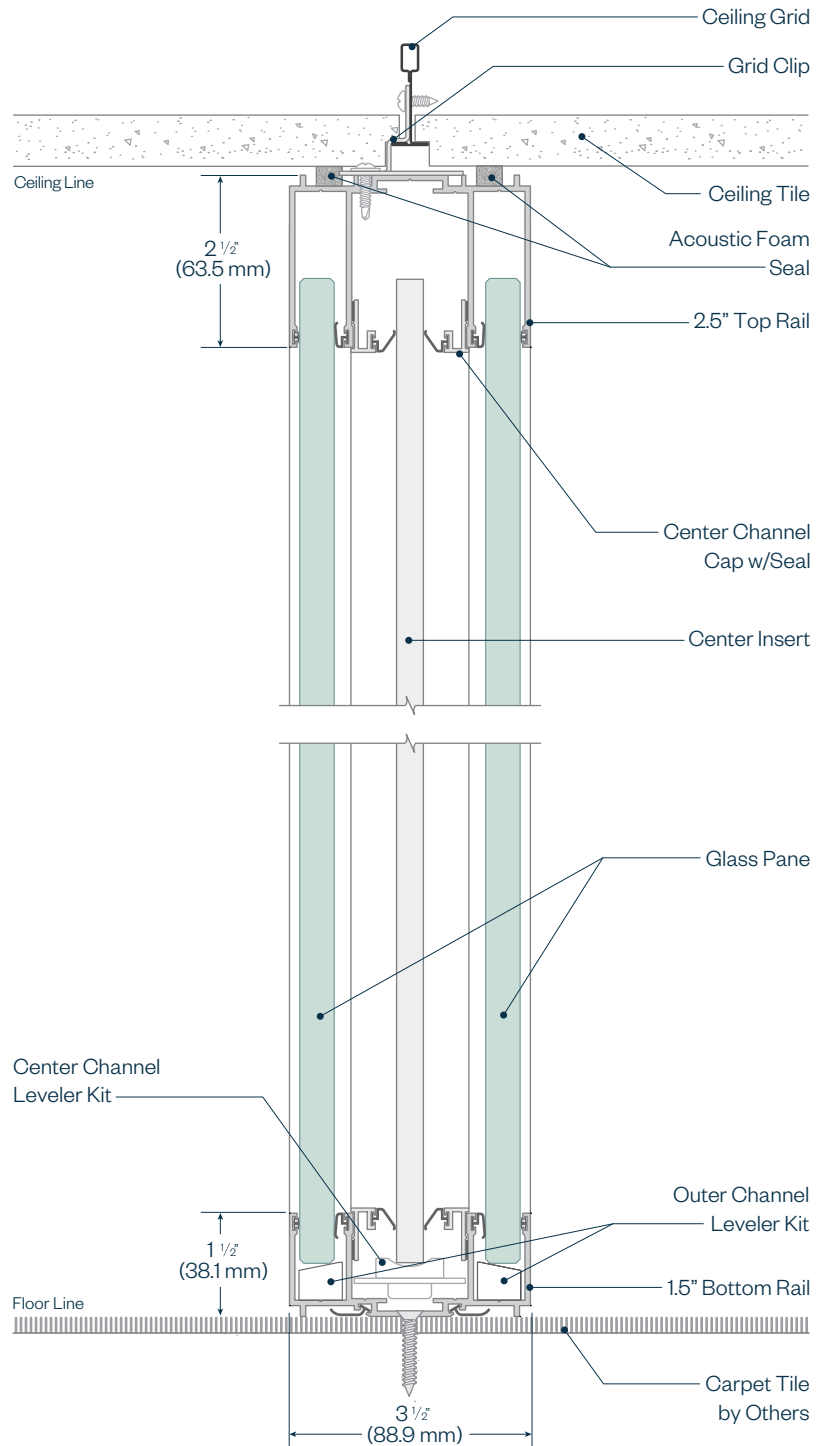

HAWORTH

# Trivati Architectural Details

## Trivati Solid Wall with 2.5" Bottom Rail - Vertical Section

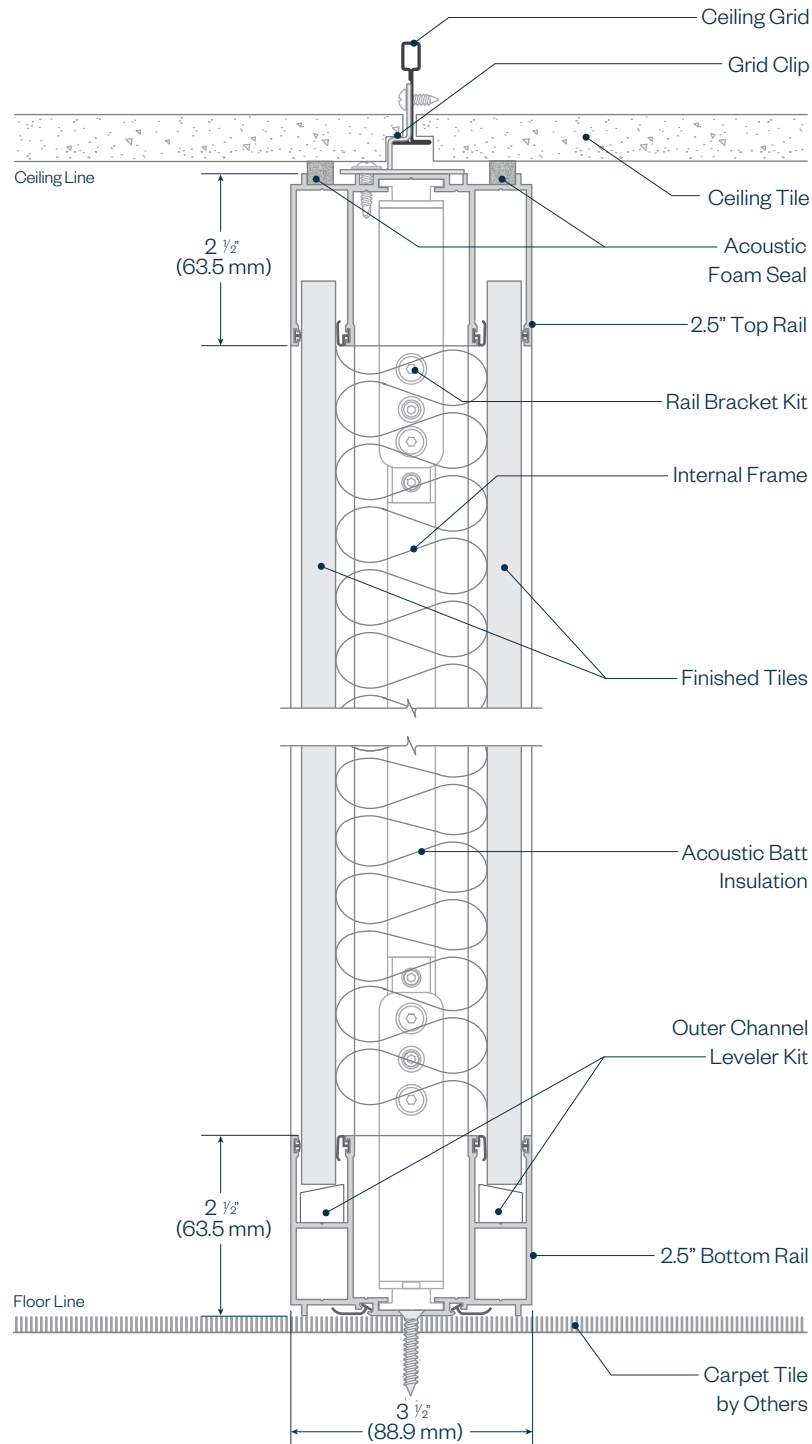



HAWORTH

# Trivati Architectural Details

## Trivati Solid Wall with 1.5" Bottom Rail - Vertical Section

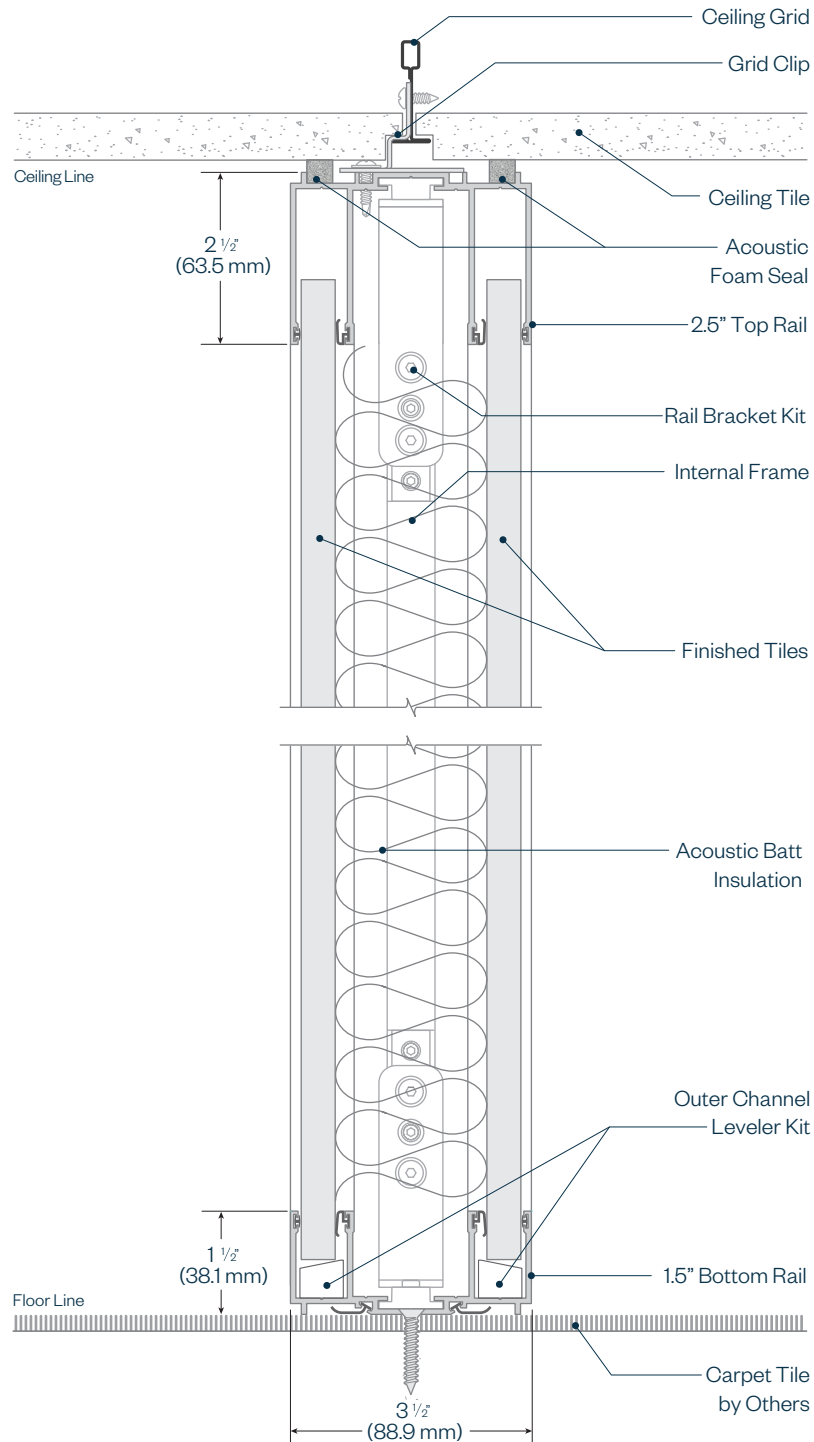

HAWORTH

# Trivati Architectural Details

## Trivati Solid Wall - Horizontal Section

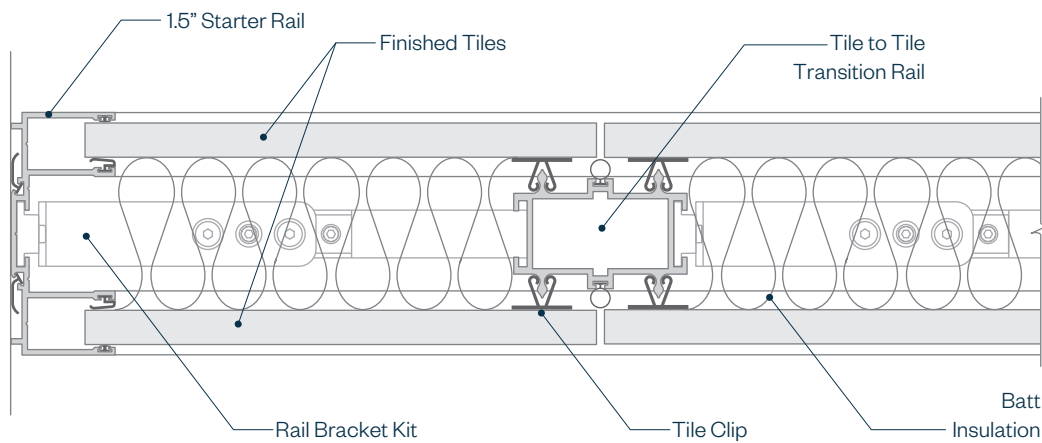

HAWORTH

# Trivati Architectural Details

## Trivati Combination Wall - Vertical Sections

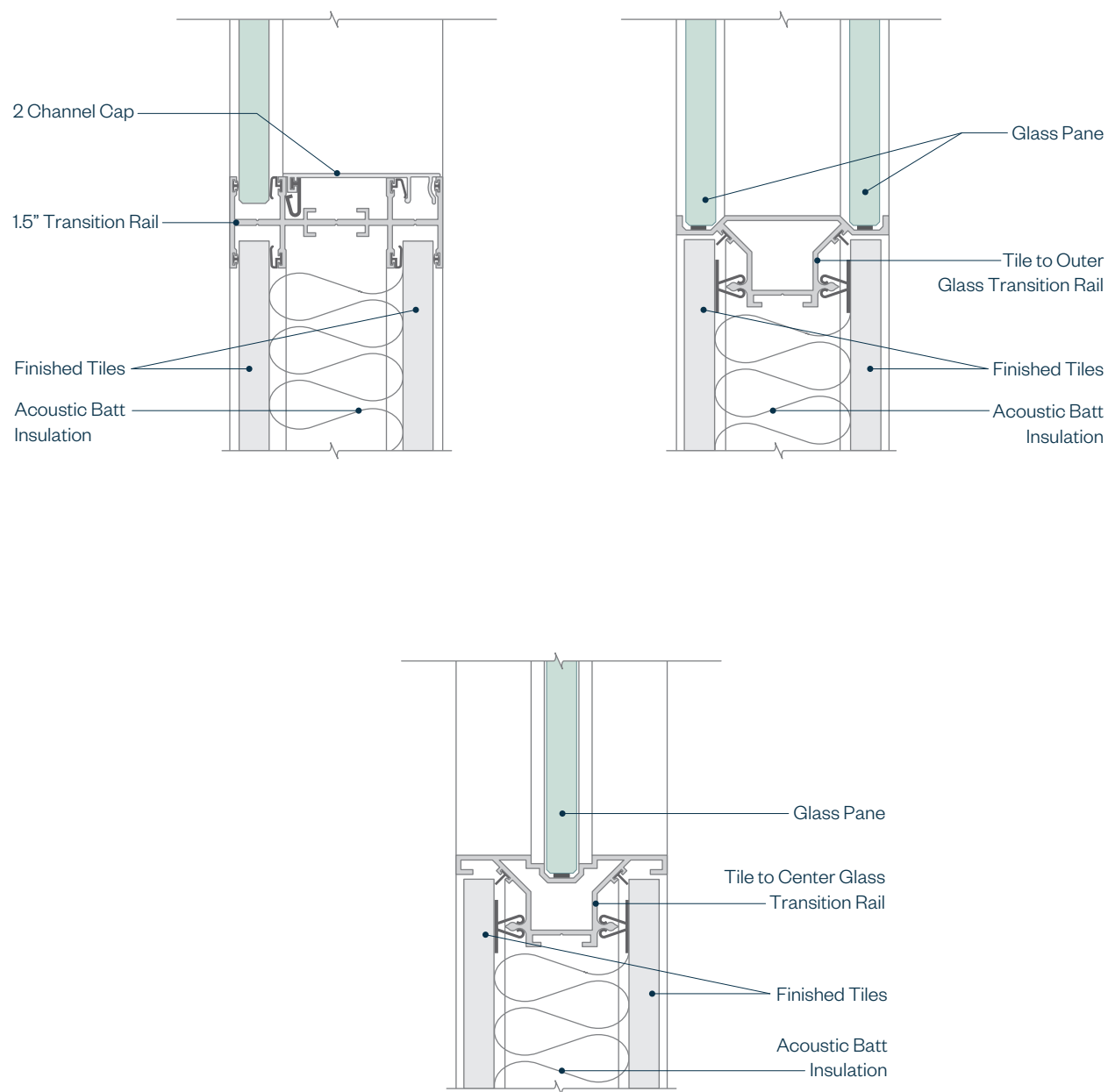

HAWORTH

# Trivati Architectural Details

## Trivati Double Glazed Sliding Door Beneath Ceiling Tile - Vertical Section

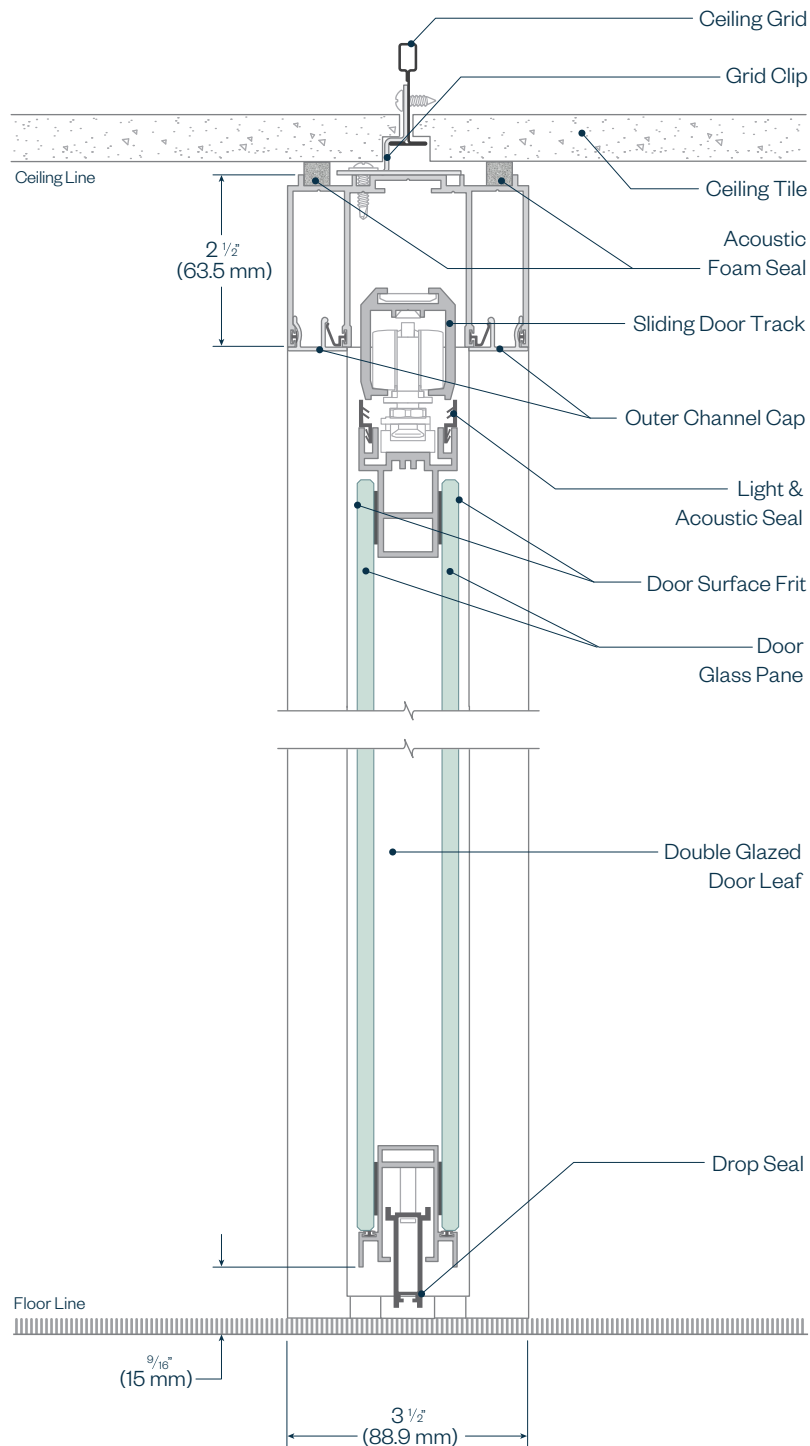

HAWORTH

# Trivati Architectural Details

## Trivati Double Glazed Sliding Door Beneath GWB Soffit - Vertical Section

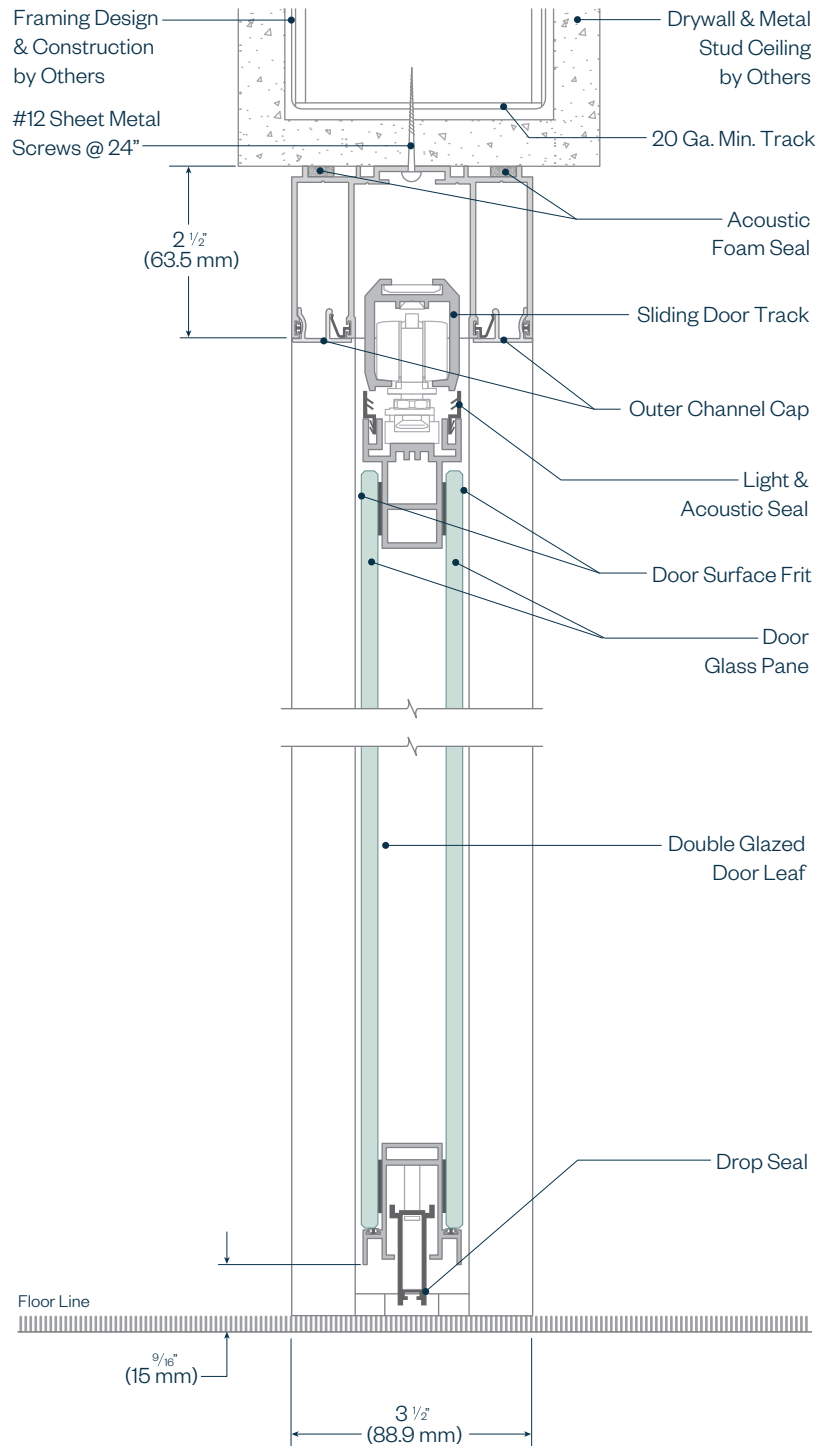

HAWORTH

# Trivati Architectural Details

## Trivati Glass Slab Sliding Door Beneath Ceiling Tile - Vertical Section

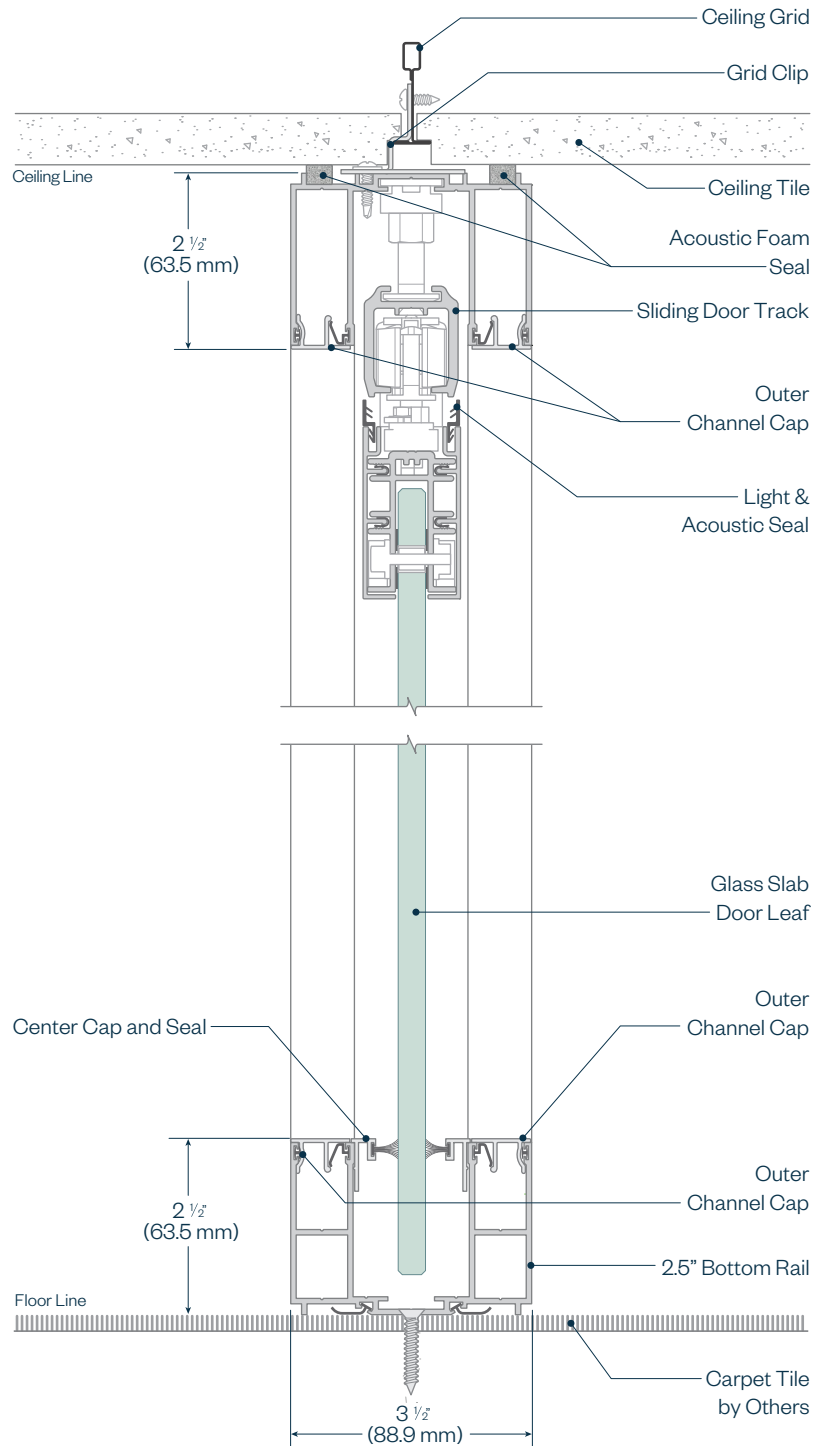

HAWORTH

# Trivati Architectural Details

## Trivati Glass Slab Sliding Door Beneath GWB Soffit - Vertical Section

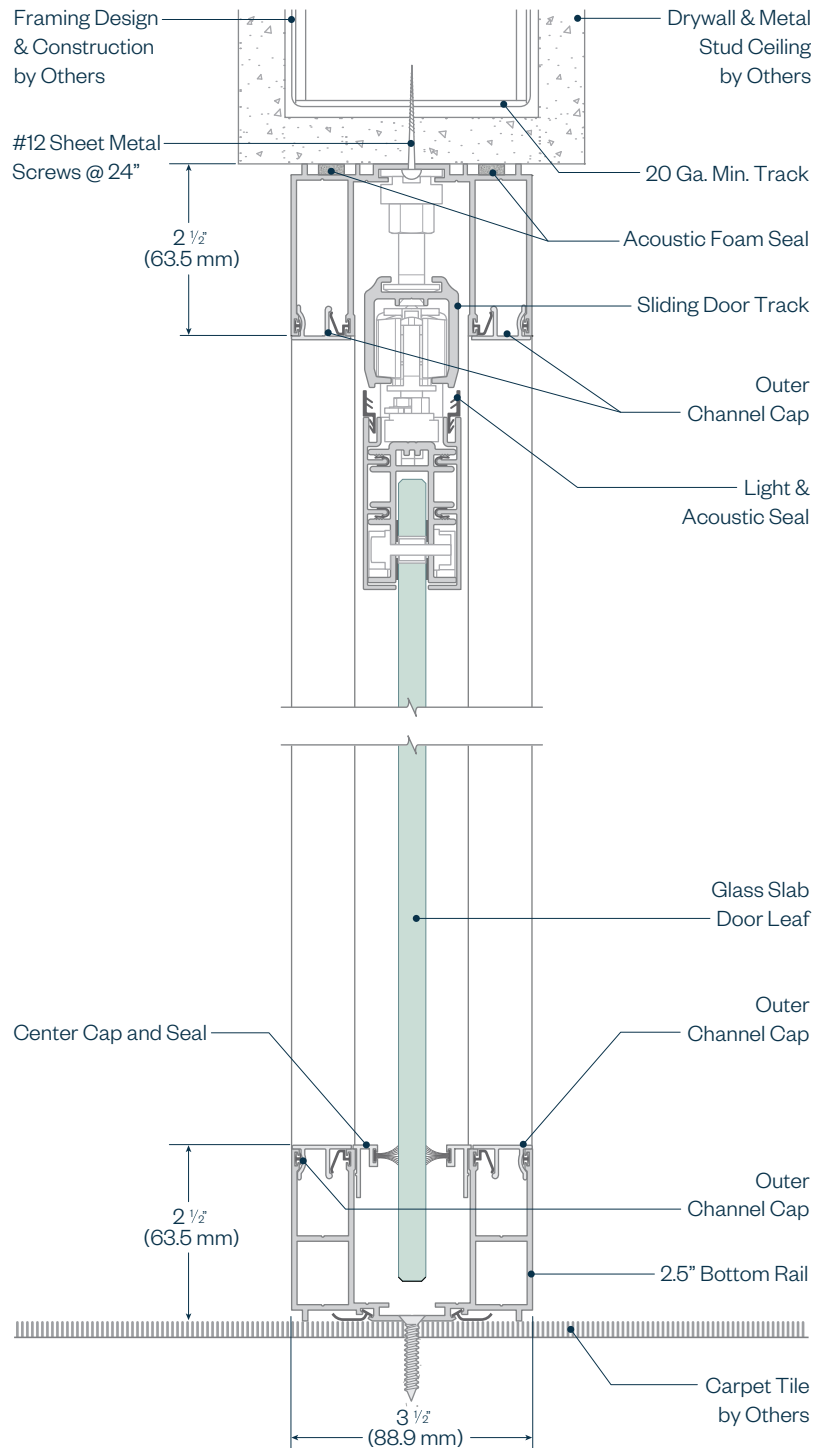

HAWORTH

# Trivati Architectural Details

## Trivati Double Glazed Pivot Door Beneath Ceiling Tile - Vertical Section

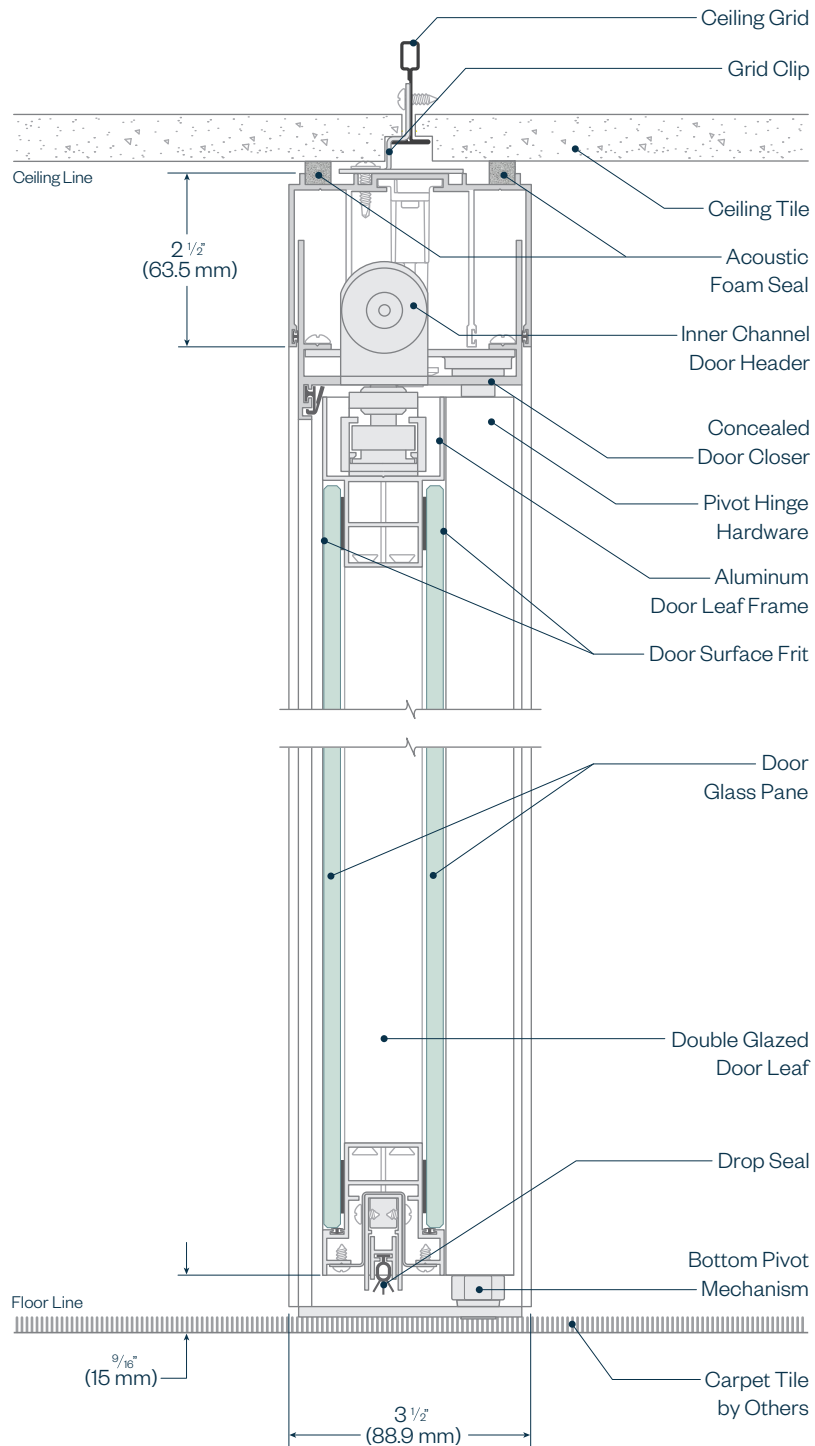



HAWORTH

# Trivati Architectural Details

## Trivati Double Glazed Pivot Door Beneath GWB Soffit - Vertical Section

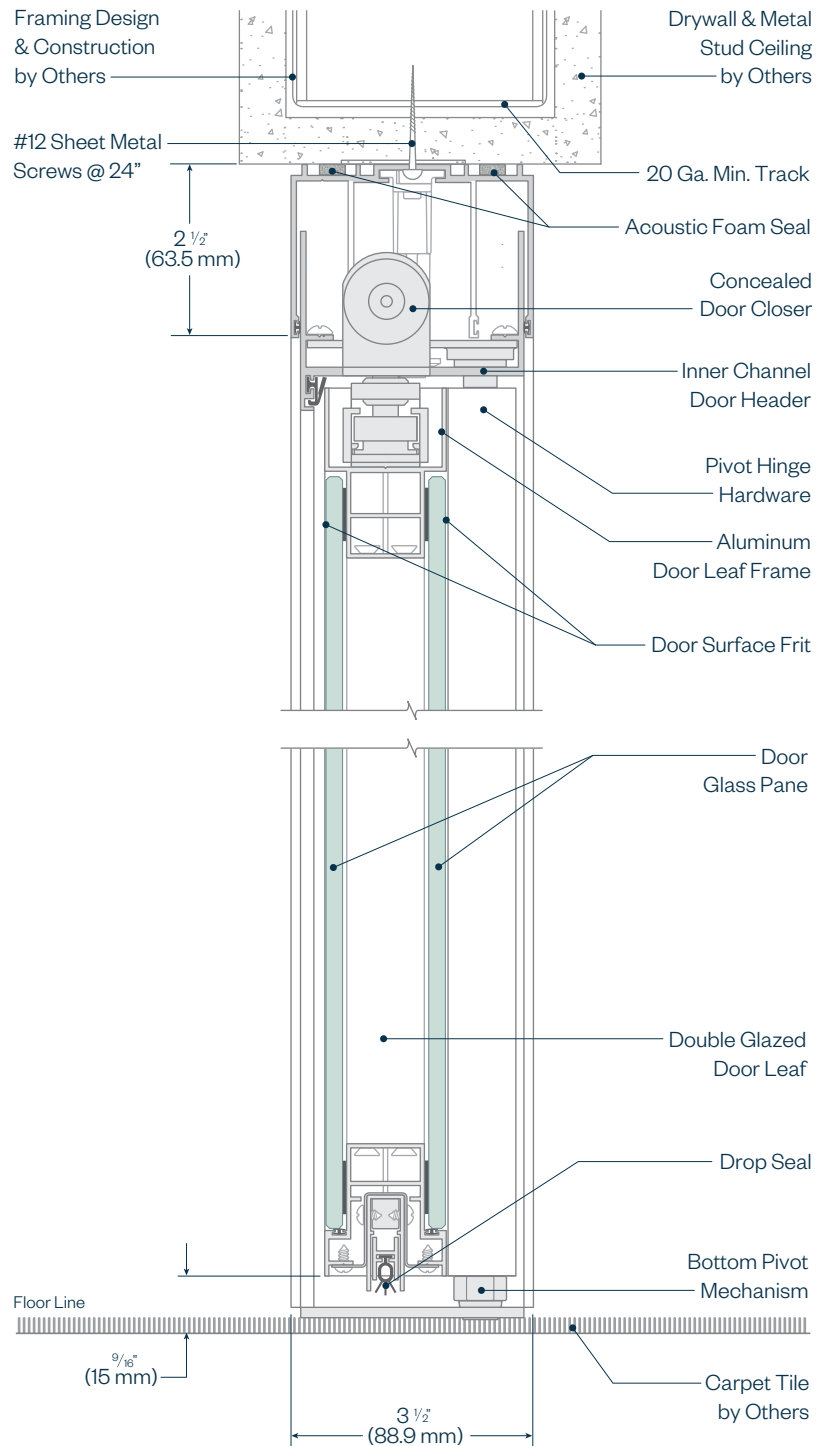

HAWORTH

# Trivati Architectural Details

## Trivati Glass Slab Pivot Door Beneath Ceiling Tiles - Vertical Section

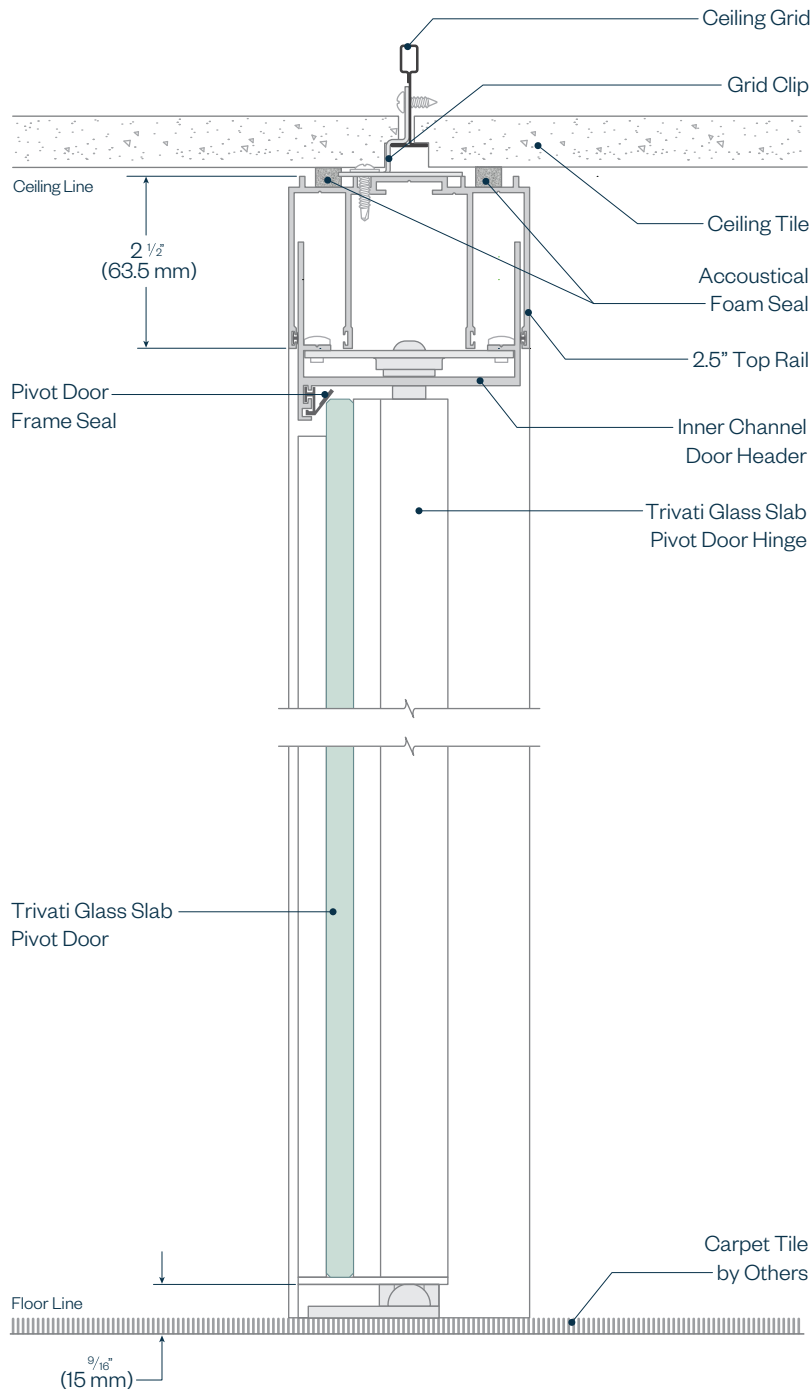

HAWORTH

# Trivati Architectural Details

## Trivati Glass Slab Pivot Door Beneath GWB Soffit - Vertical Section

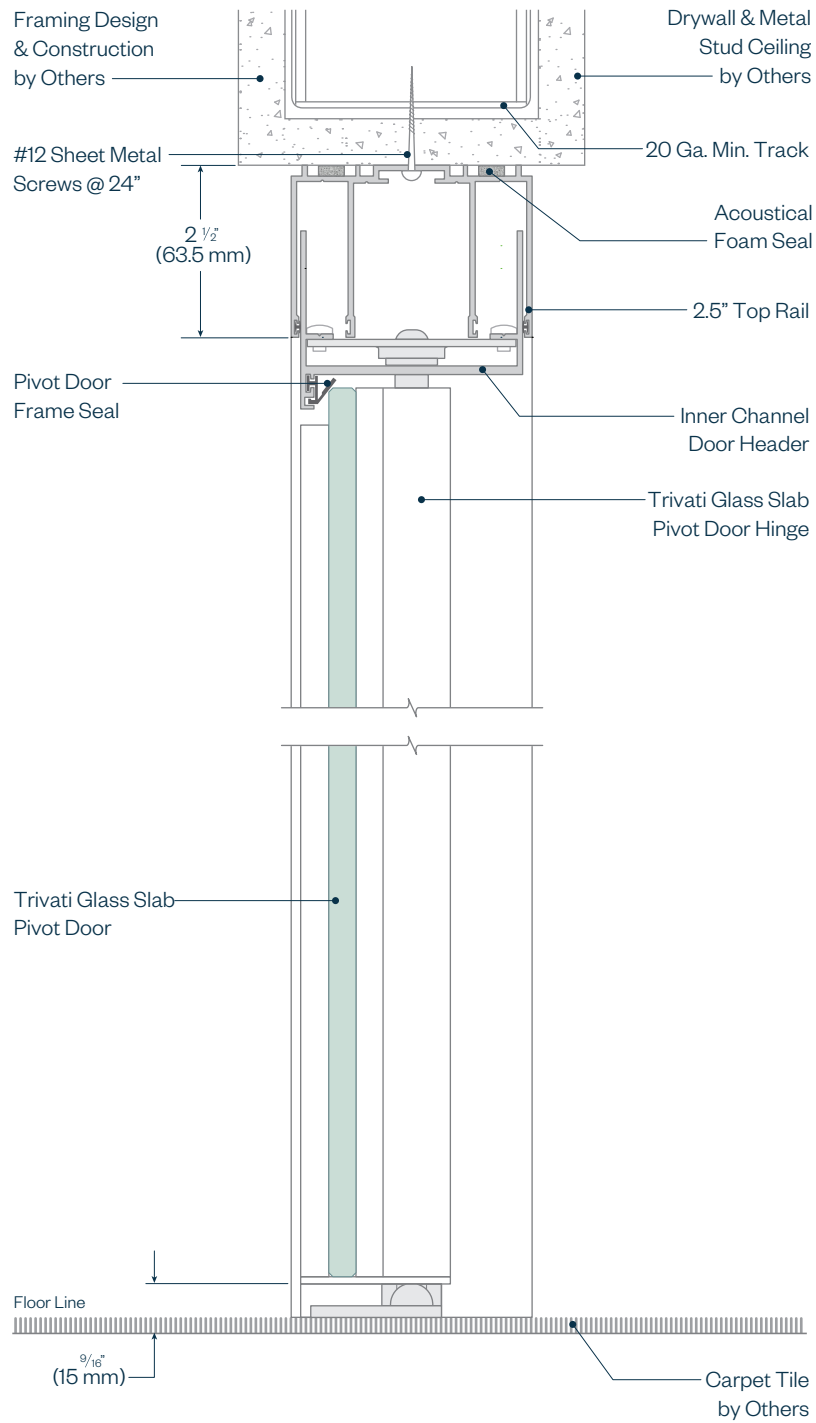

HAWORTH

# Trivati Architectural Details

## Trivati Glass Slab Pivot Door Beneath Ceiling Tiles - Vertical Section

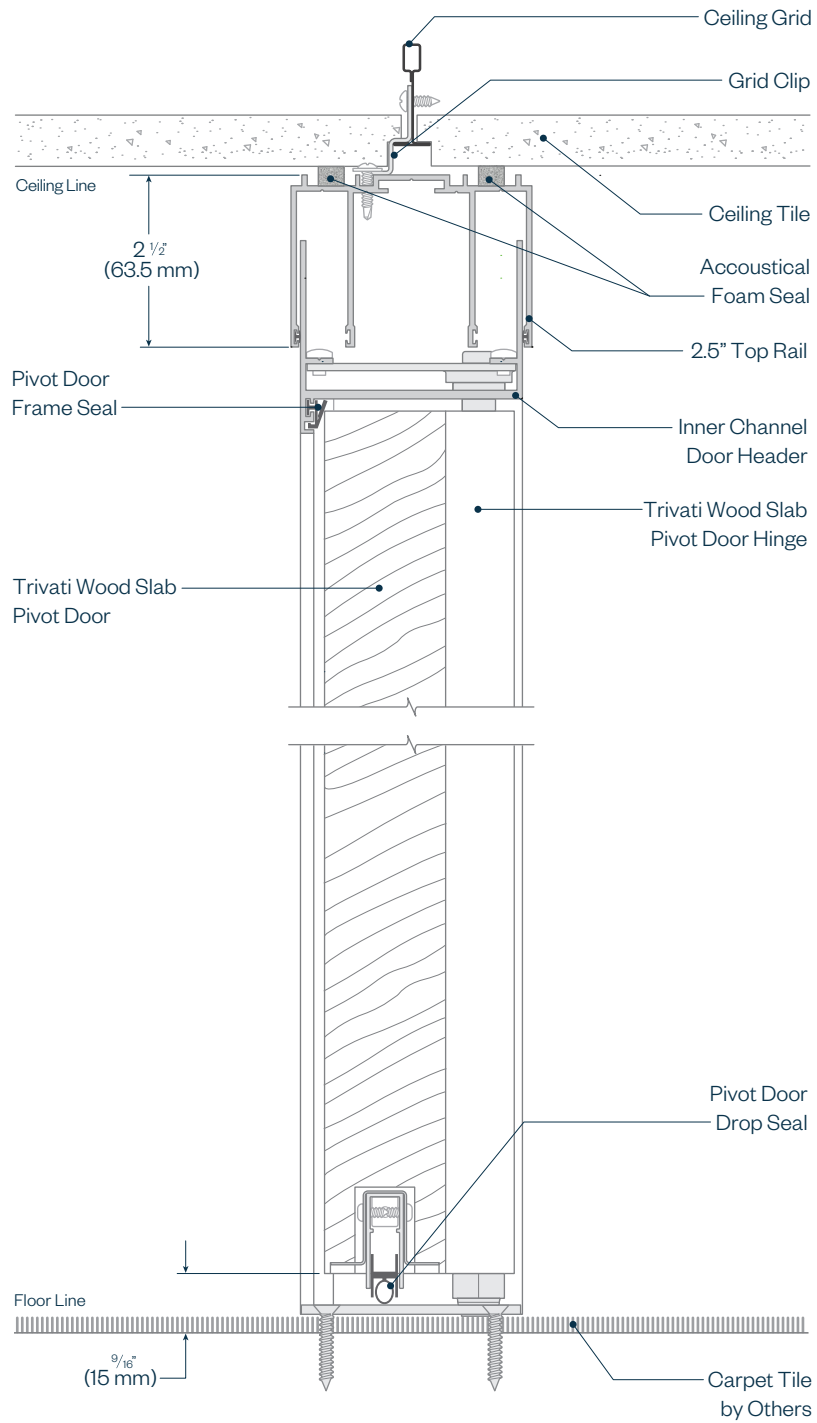

HAWORTH

# Trivati Architectural Details

## Trivati Wood Slab Pivot Door Beneath GWB Soffit - Vertical Section

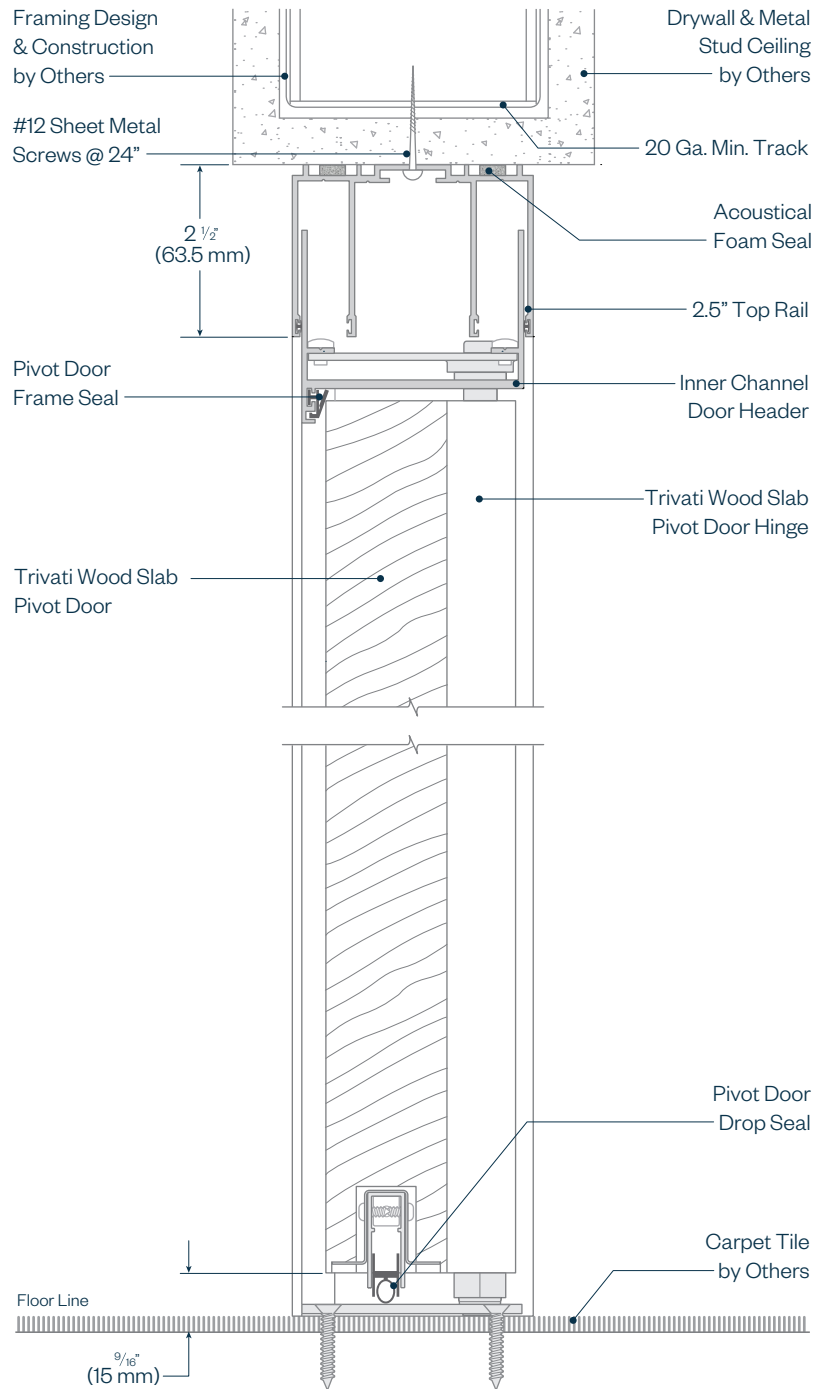

HAWORTH

# Trivati Architectural Details

## Trivati Wood Glazed Pivot Door Beneath Ceiling Tiles - Vertical Section

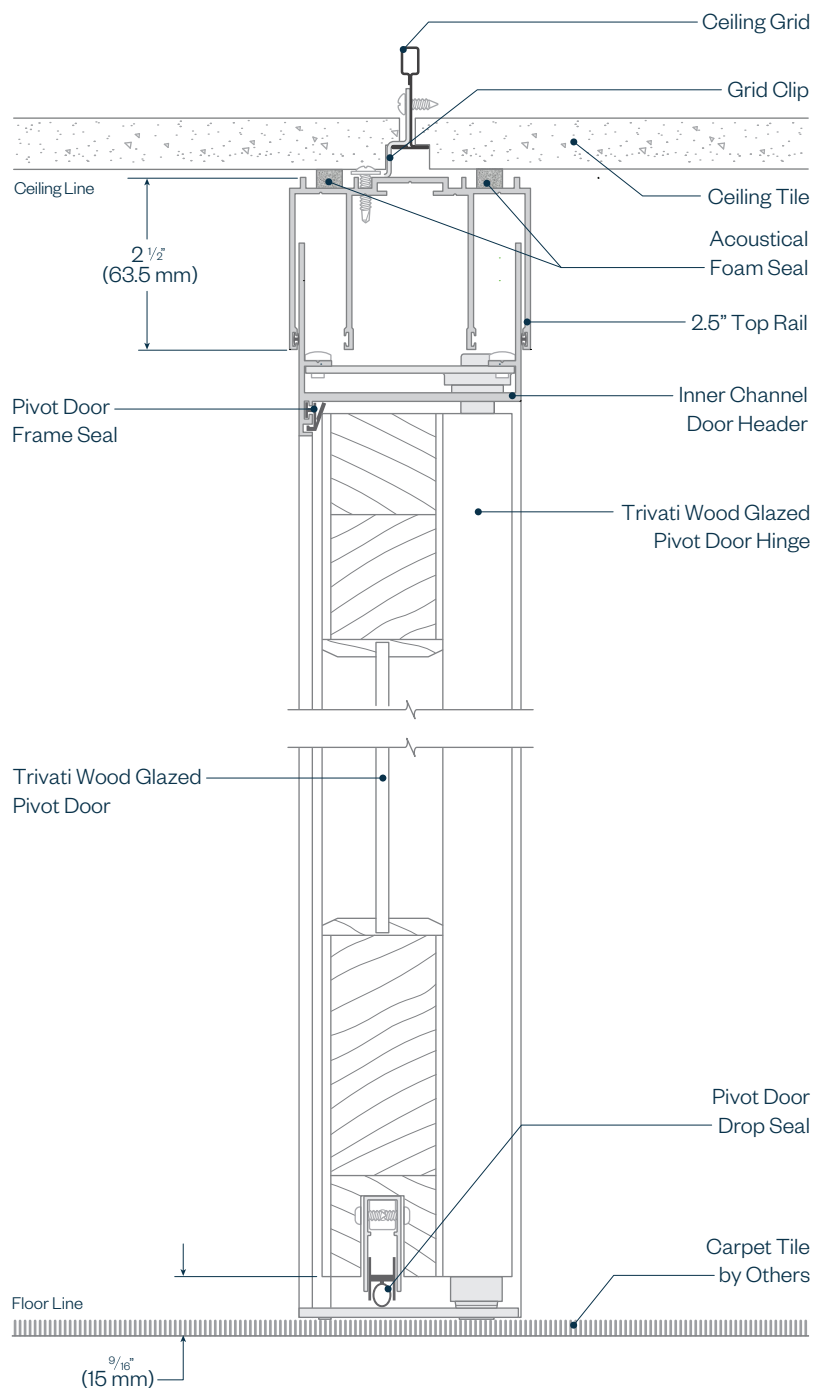

HAWORTH

# Trivati Architectural Details

## Trivati Wood Glazed Pivot Door Beneath GWB Soffit - Vertical Section

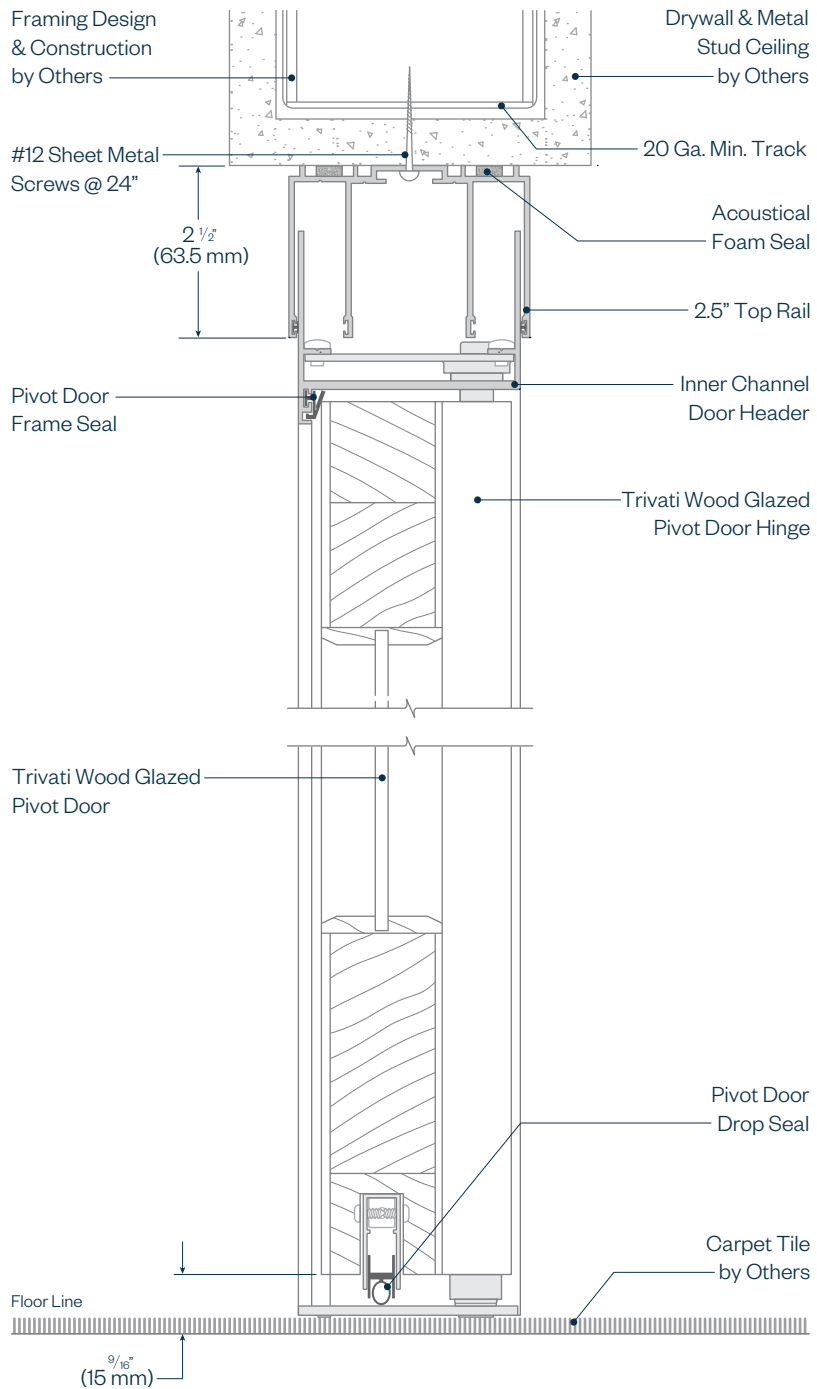

HAWORTH

# Trivati Architectural Details

## Trivati Sliding Door Typical - Horizontal Section

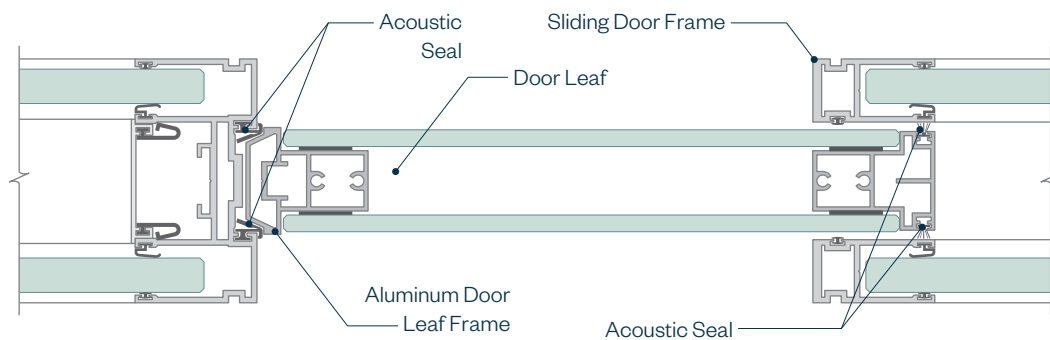



HAWORTH

# Trivati Architectural Details

## Trivati Pivot Door Typical - Horizontal Section

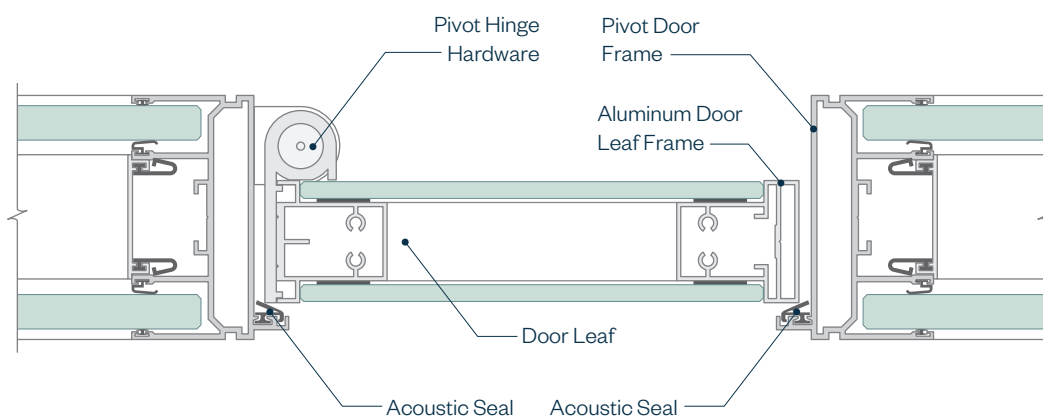

HAWORTH

# Trivati Architectural Details

## Trivati Fly-By with 3.5" Cover Kit Back-to-Back Double Glazed Pivot Doors

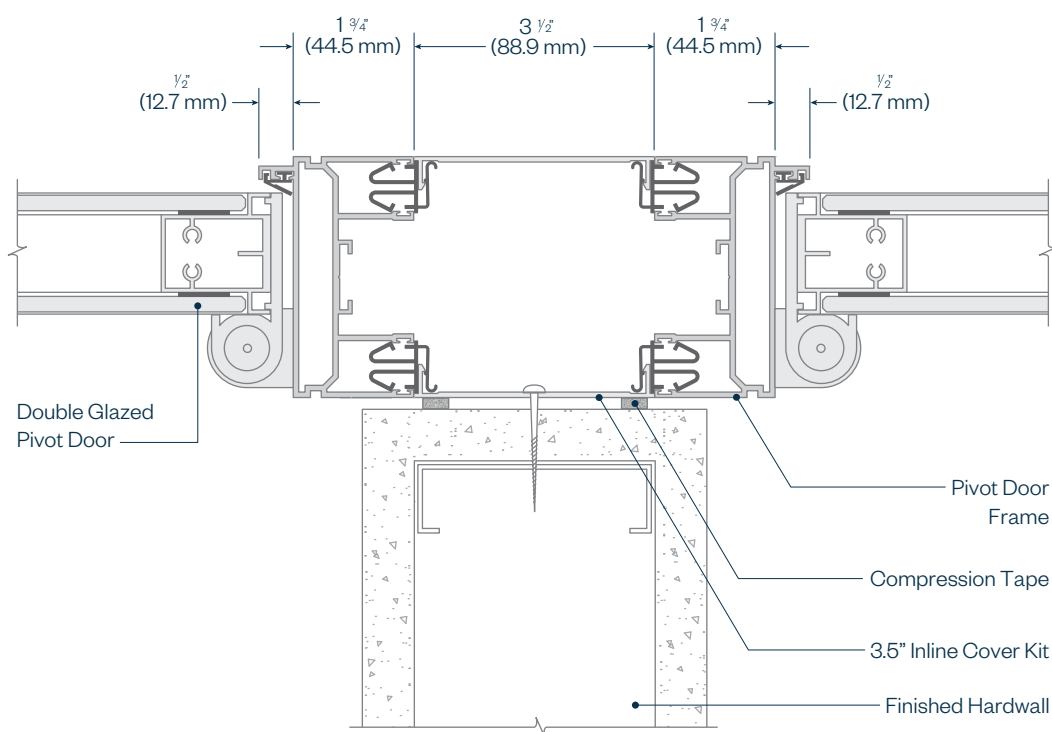

HAWORTH

# Trivati Architectural Details

Trivati Fly-By with 3.5" Cover Kit

Offset Glazed Wall Span and Glass Slab Pivot Door

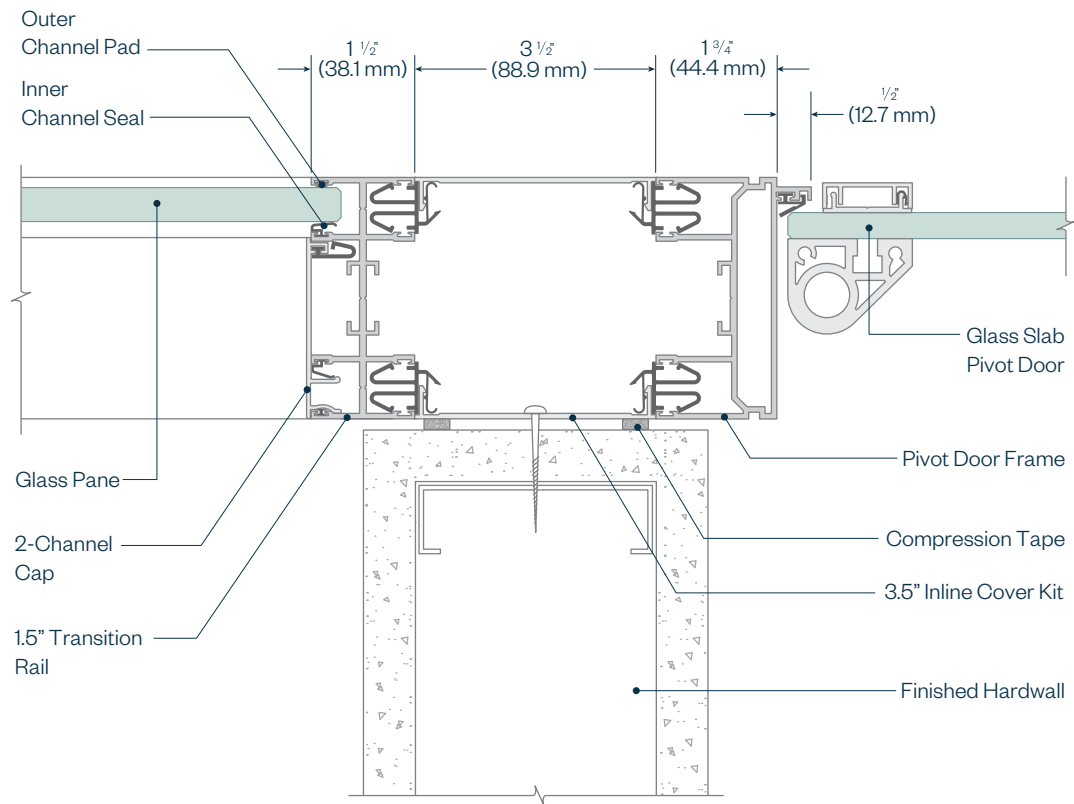

HAWORTH

# Trivati Architectural Details

Trivati Fly-By with 3.5" Cover Kit

Double Glazed Wall Span and Wood Pivot Door

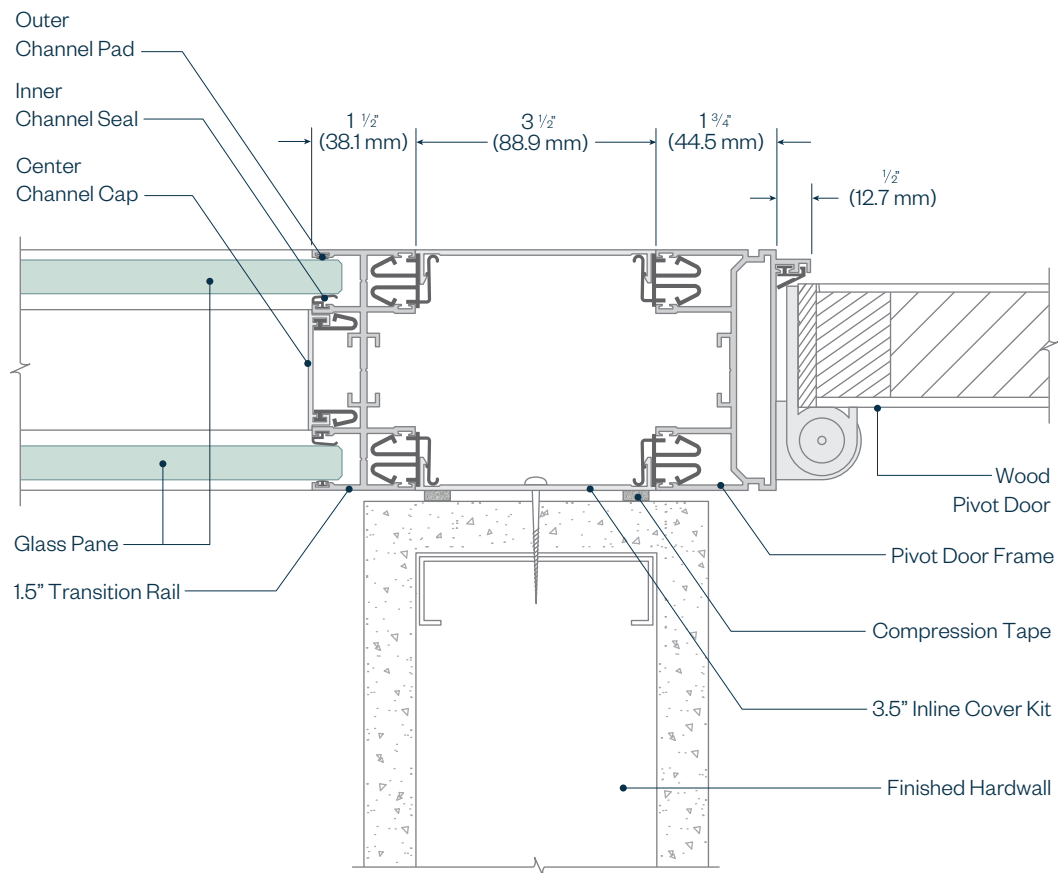

HAWORTH

# Trivati Architectural Details

Trivati Fly-By with 3.5" Cover Kit

Offset Glazed Wall Span and Double Glazed Sliding Door

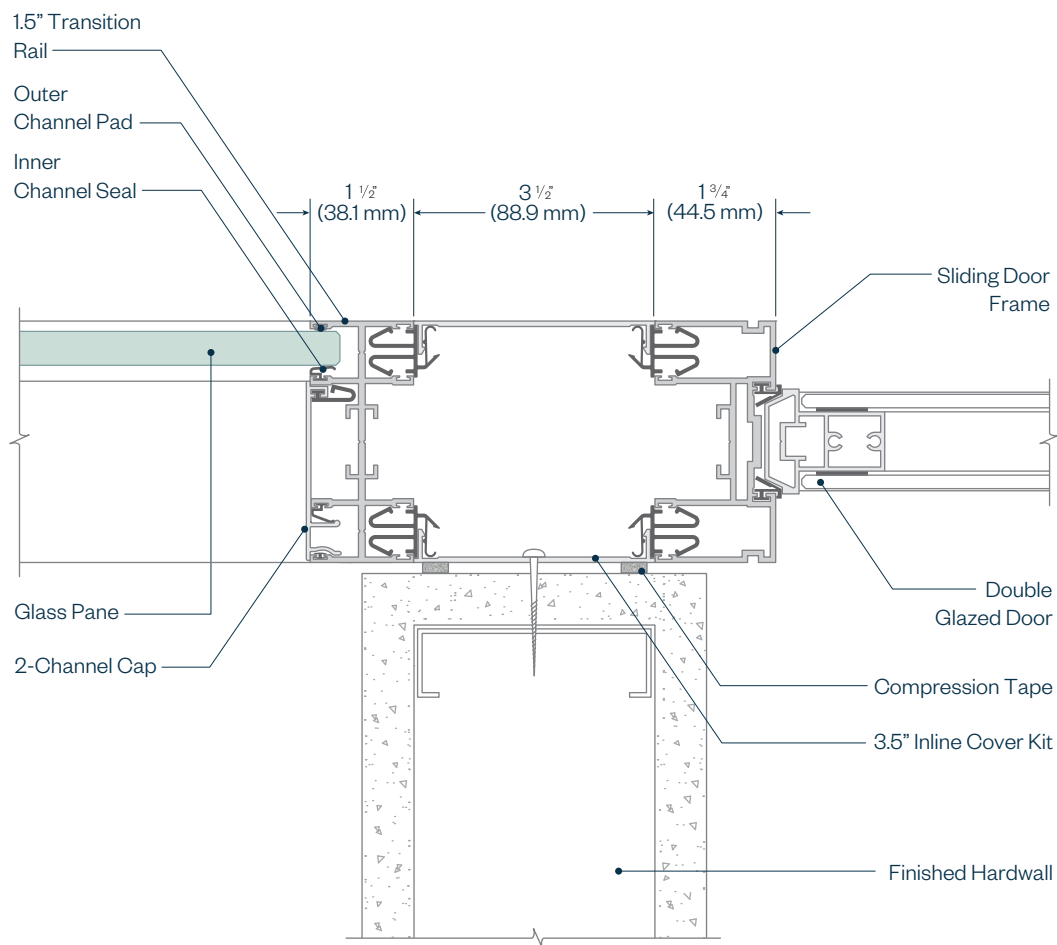

HAWORTH

# Trivati Architectural Details

## Trivati Fly-By with 3.5" Cover Kit Back-to-Back Double Glazed Sliding Doors

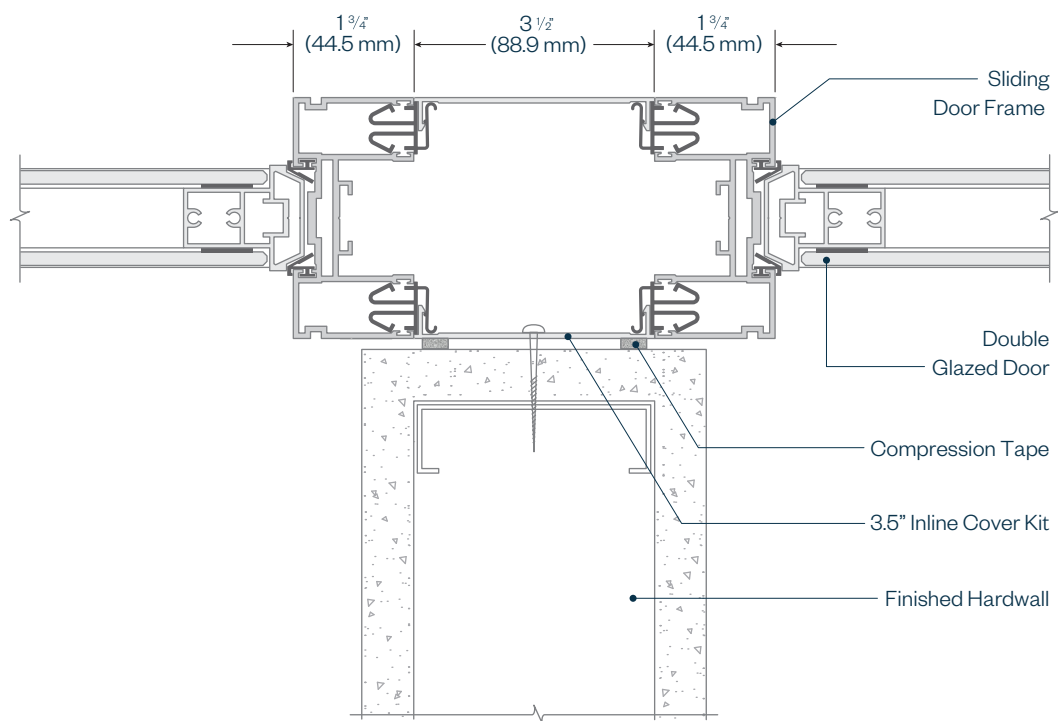

HAWORTH

# Trivati Architectural Details

## Trivati Fly-By with 3.5" Cover Kit Back-to-Back Glass Slab Sliding Doors

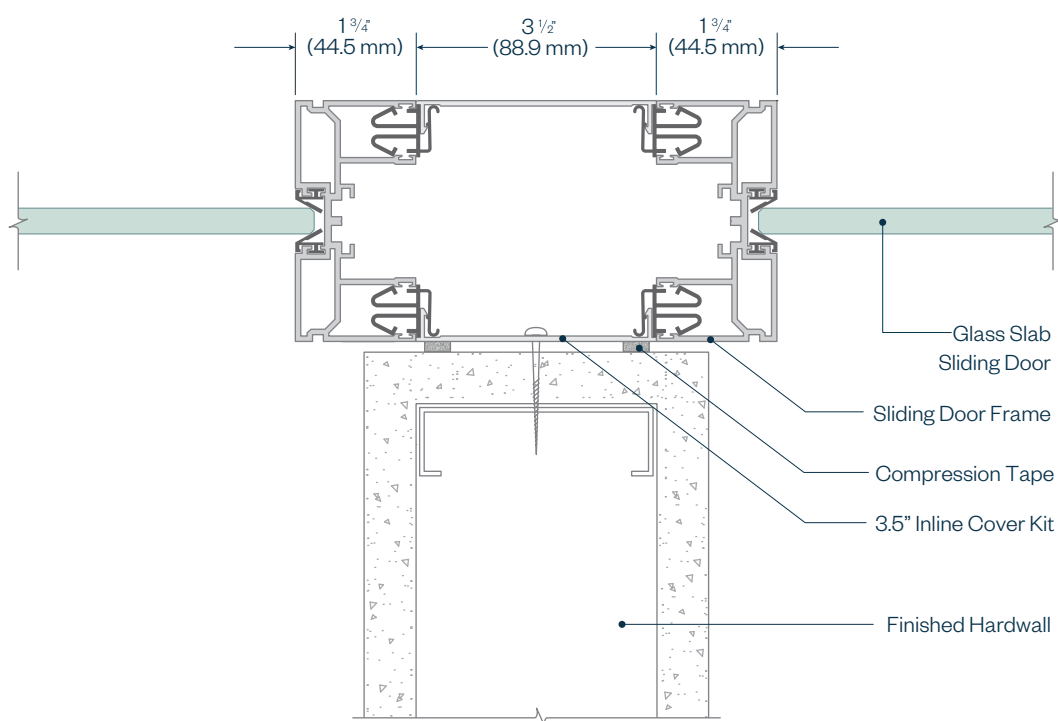

HAWORTH

# Trivati Architectural Details

Trivati Fly-By with 3.5" Cover Kit

Offset Glazed Wall Span and Glass Slab Sliding Door

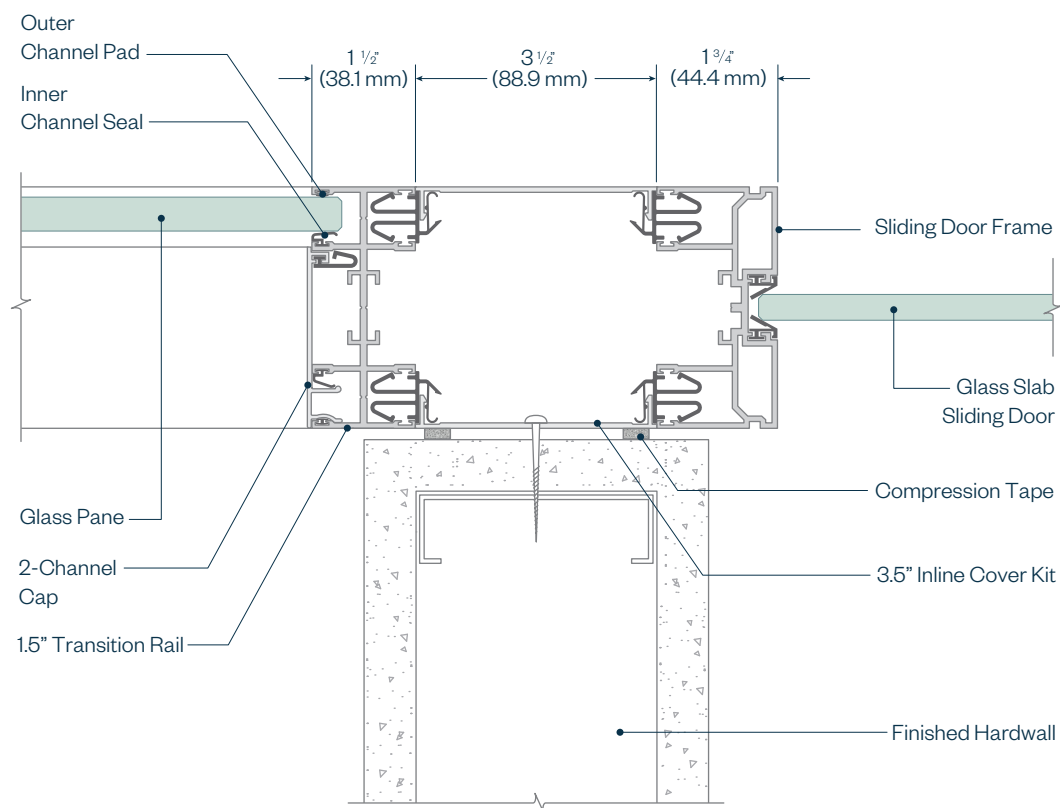



HAWORTH

# Trivati Architectural Details

## Trivati Fly-By with 3.5" Cover Kit Double Glazed Wall Spans

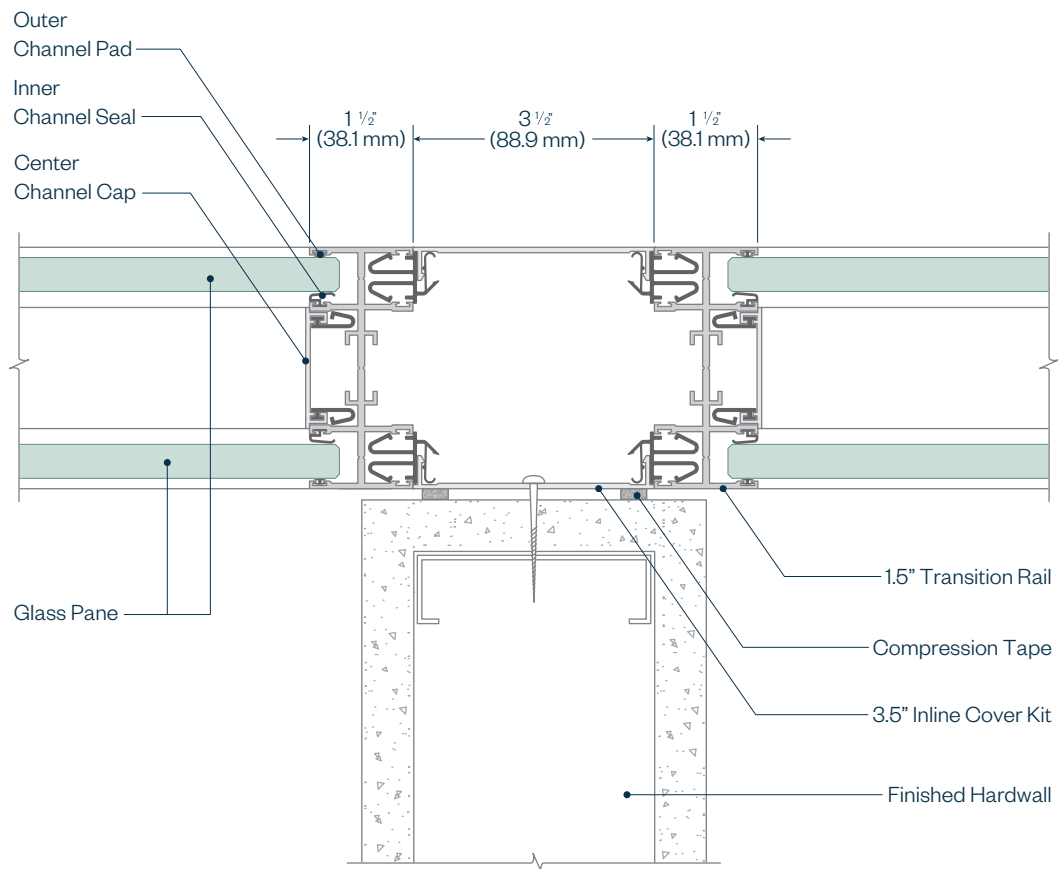

HAWORTH

# Trivati Architectural Details

## Trivati Fly-By with 3.5" Cover Kit Offset Glazed Wall Spans

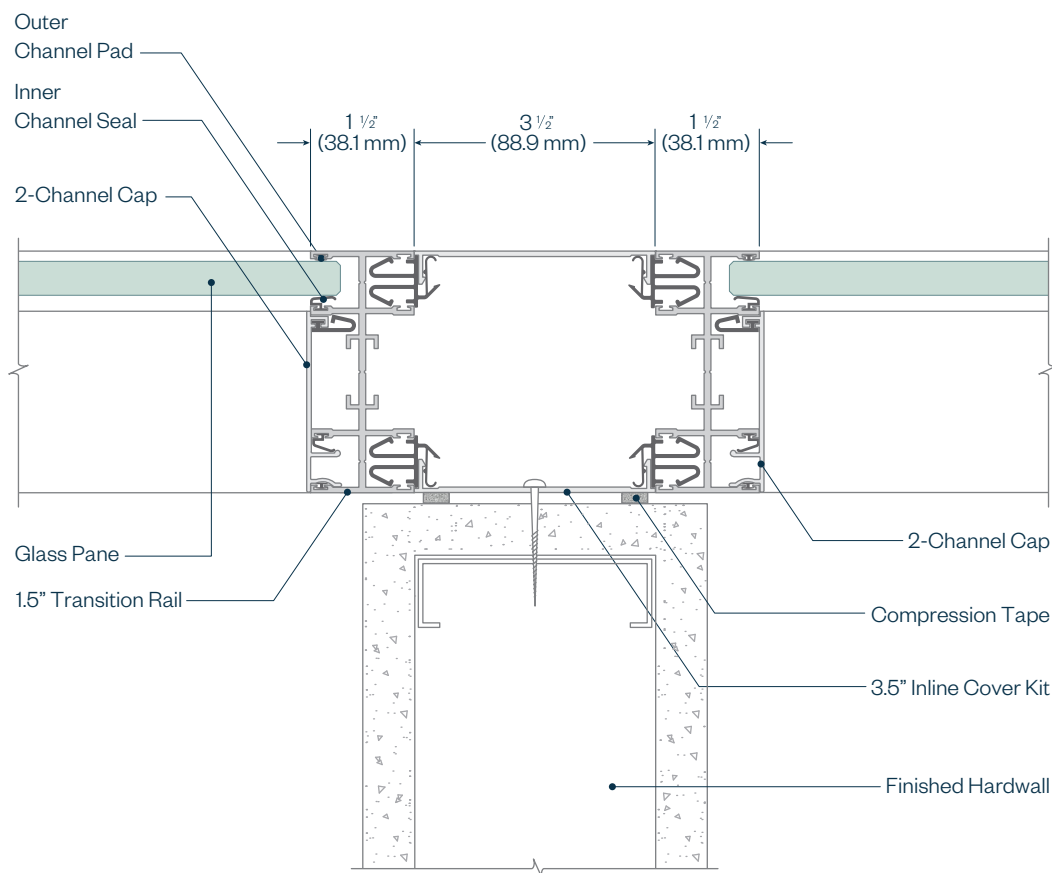

HAWORTH

# Trivati Architectural Details

## Trivati Fly-By with 3.5" Cover Kit Center Glazed Wall Spans

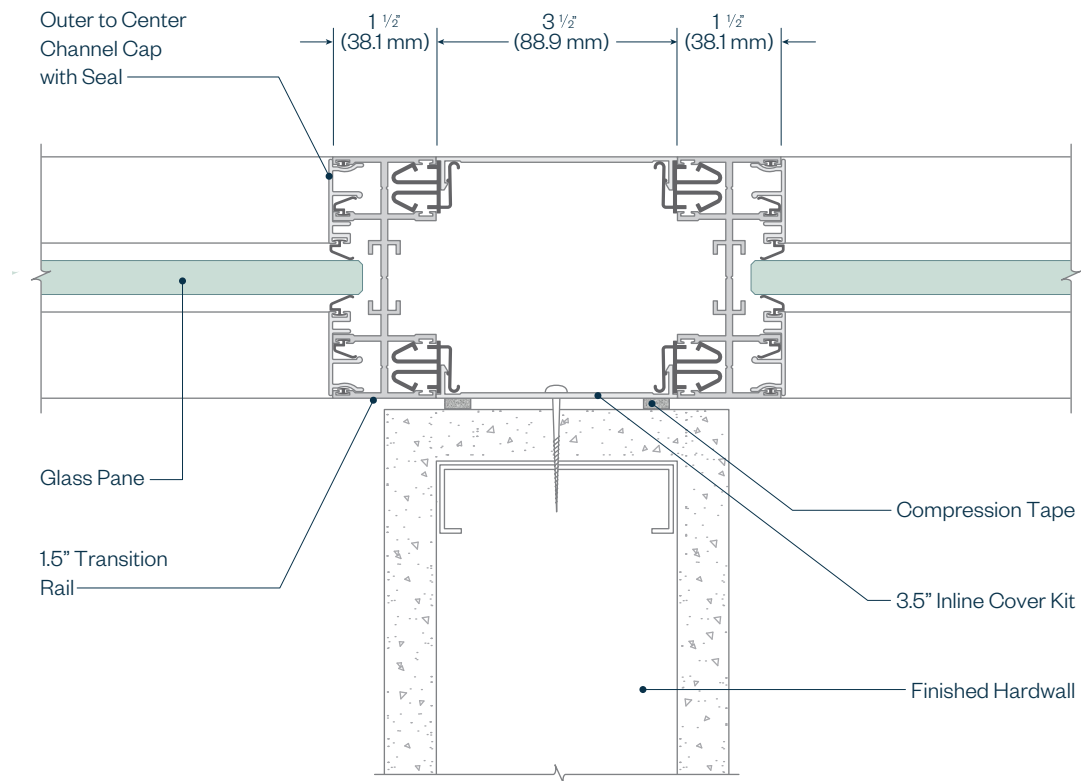

HAWORTH

# Trivati Architectural Details

## Trivati Fly-By with 5" Cover Kit Back-to-Back Double Glazed Pivot Doors

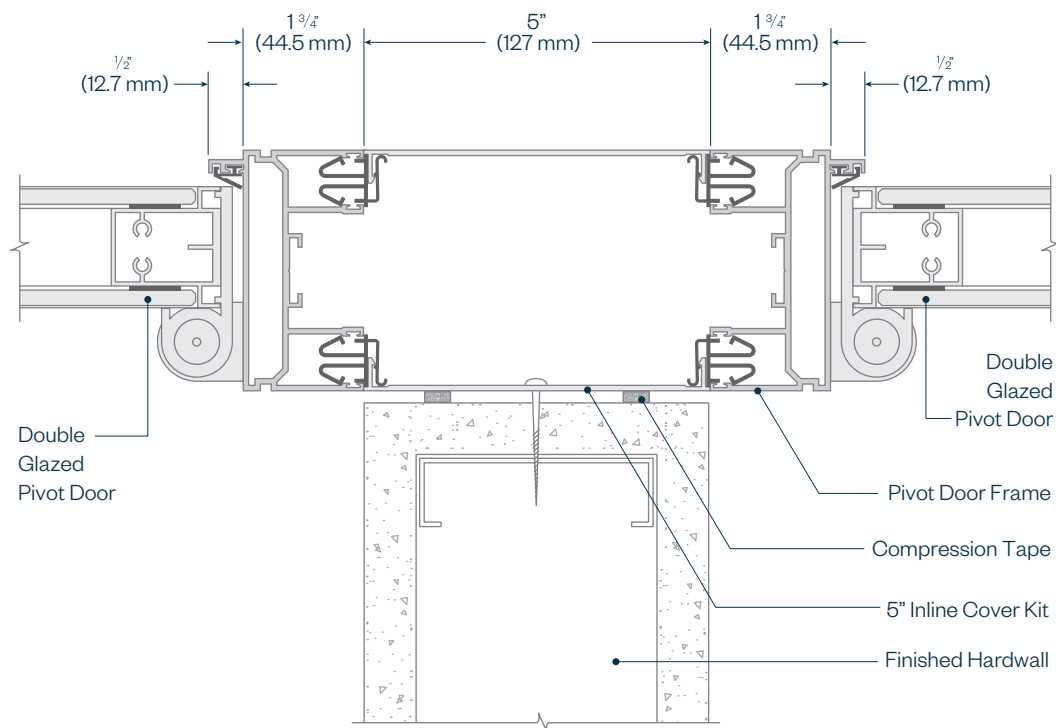

HAWORTH

# Trivati Architectural Details

Trivati Fly-By with 5" Cover Kit

Offset Glazed Wall Span and Glass Slab Pivot Door

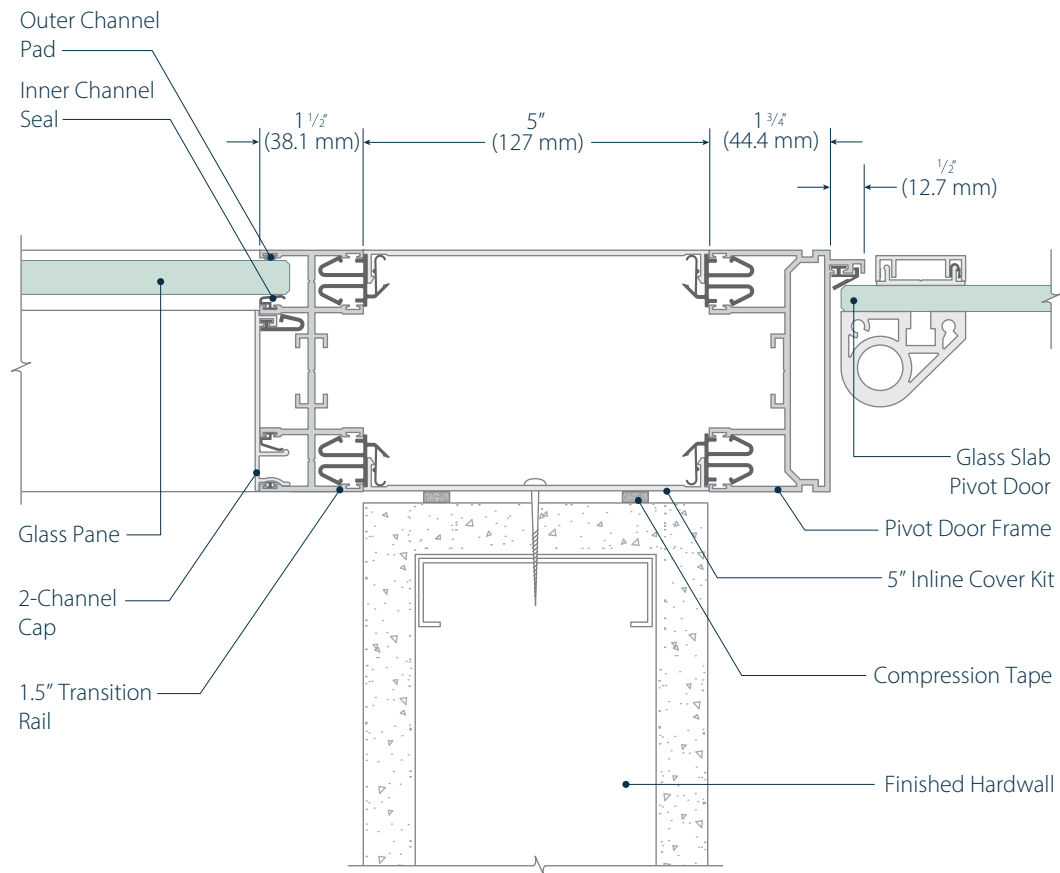

HAWORTH

# Trivati Architectural Details

Trivati Fly-By with 5" Cover Kit

Double Glazed Wall Span and Wood Pivot Door

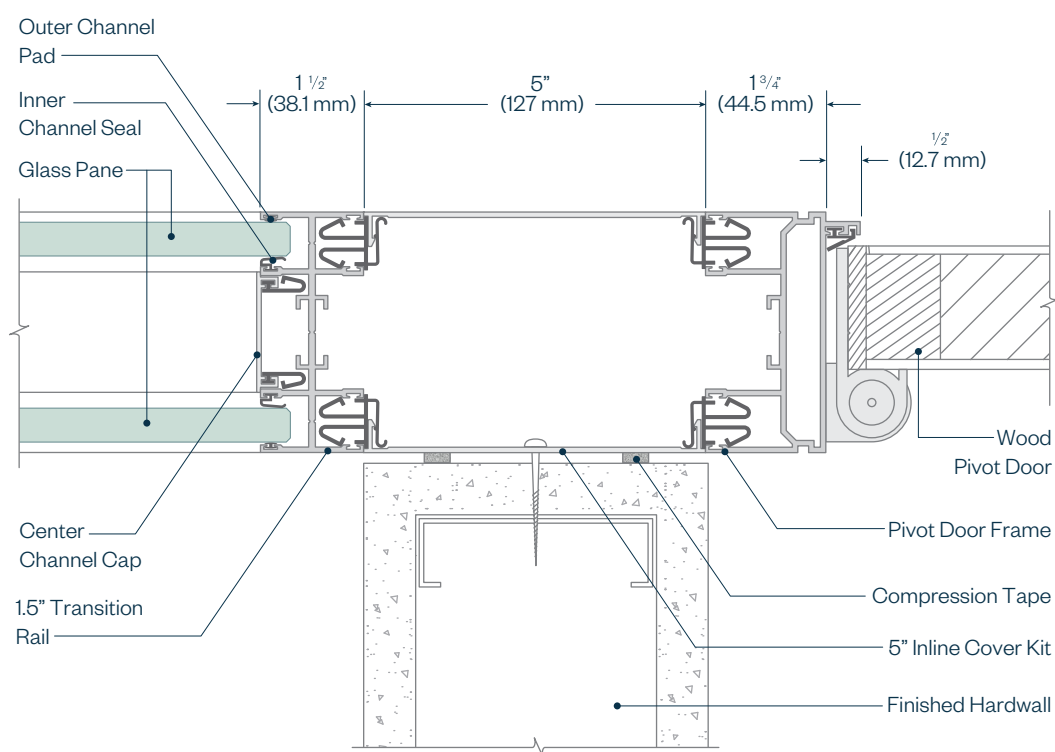

HAWORTH

# Trivati Architectural Details

## Trivati Double Glazed Wall Span to Double Glazed Sliding Door

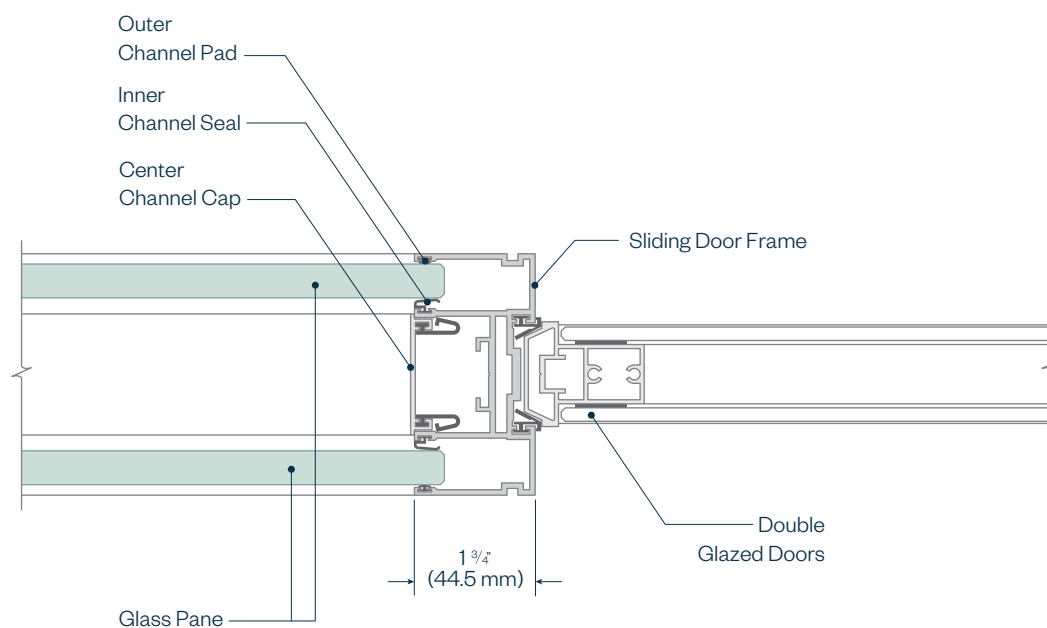

HAWORTH

# Trivati Architectural Details

## Trivati Offset Glazed Wall Span to Double Glazed Door

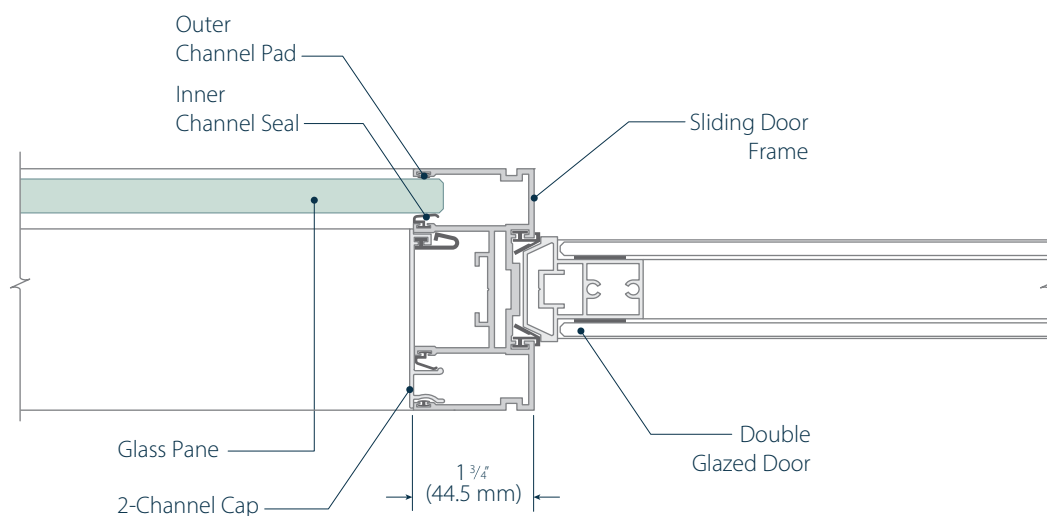



HAWORTH

# Trivati Architectural Details

## Trivati Double Glazed Wall Span to Glass Slab Sliding Door

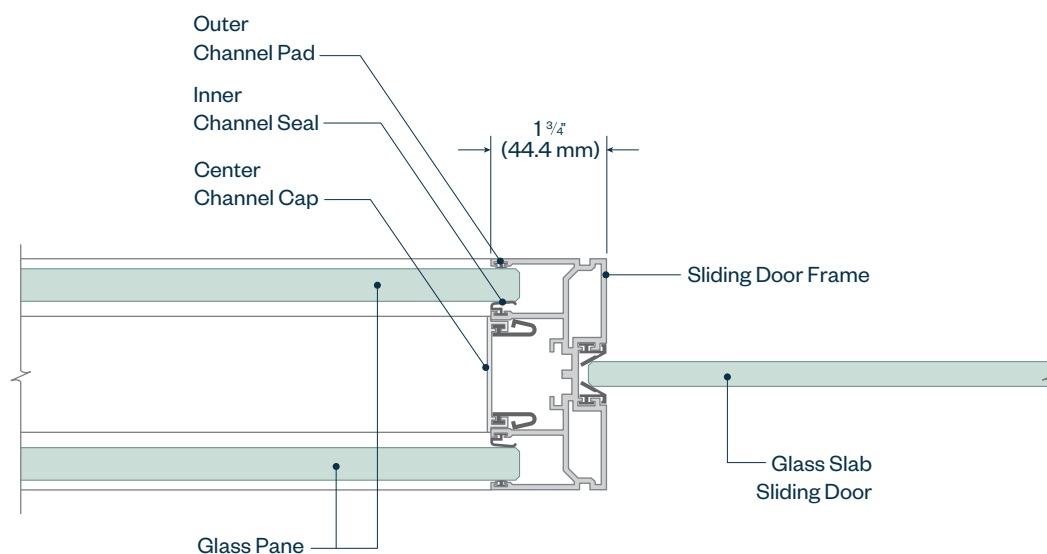

HAWORTH

# Trivati Architectural Details

## Trivati Offset Glazed Wall Span to Glass Slab Sliding Door

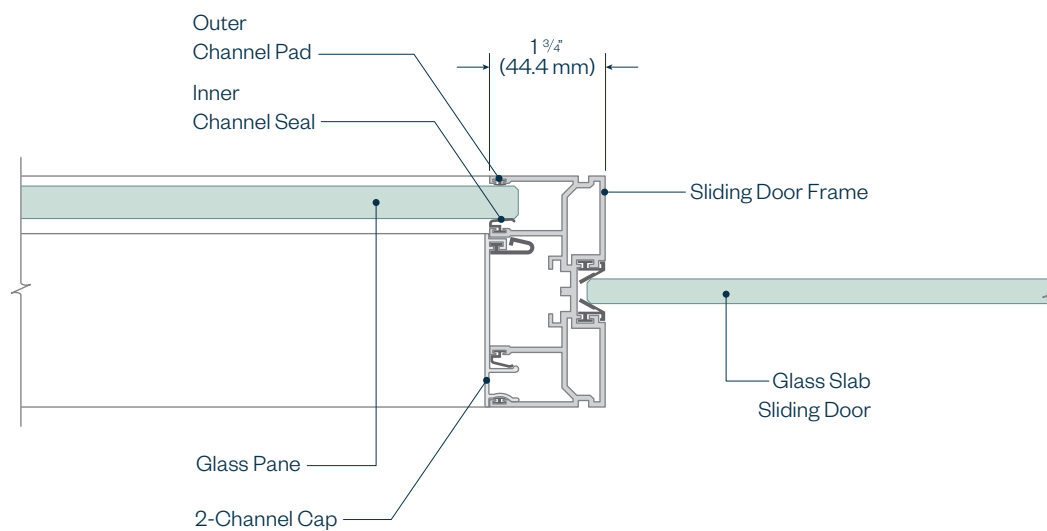

HAWORTH

# Trivati Architectural Details

## Trivati Double Glazed Wall Span to Wood Pivot Door

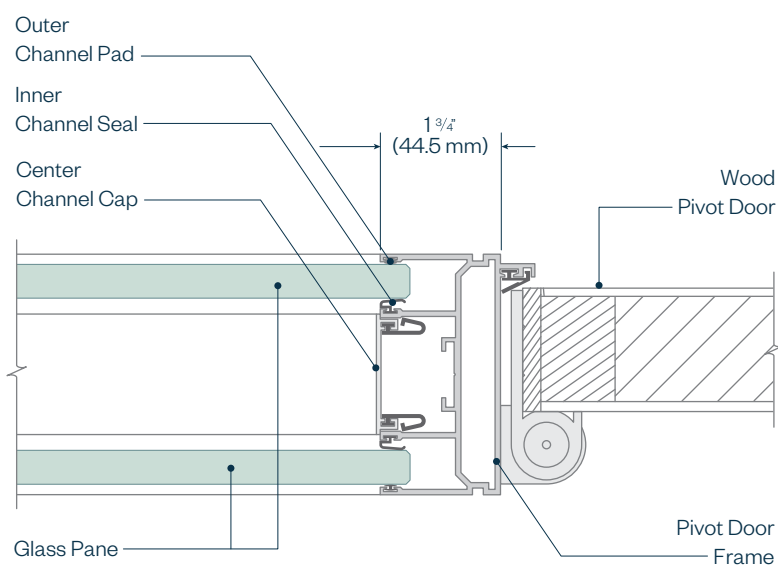

HAWORTH

# Trivati Architectural Details

## Trivati Center Glazed Wall Span to Wood Pivot Door

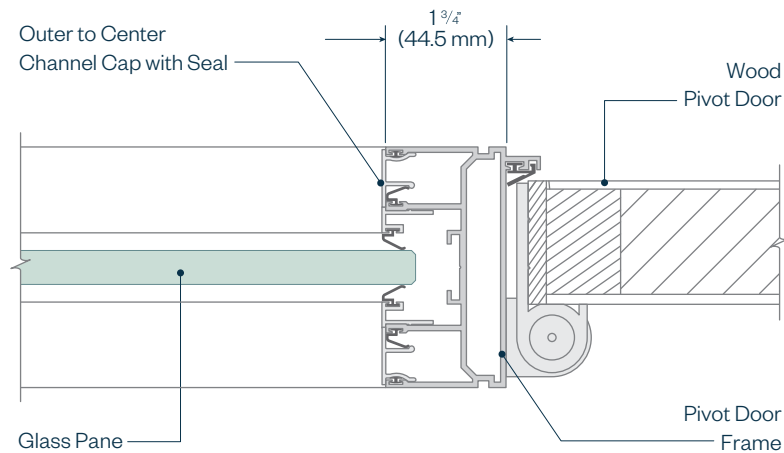

HAWORTH

# Trivati Architectural Details

## Trivati Door Frame Starter Double Glazed Sliding Door

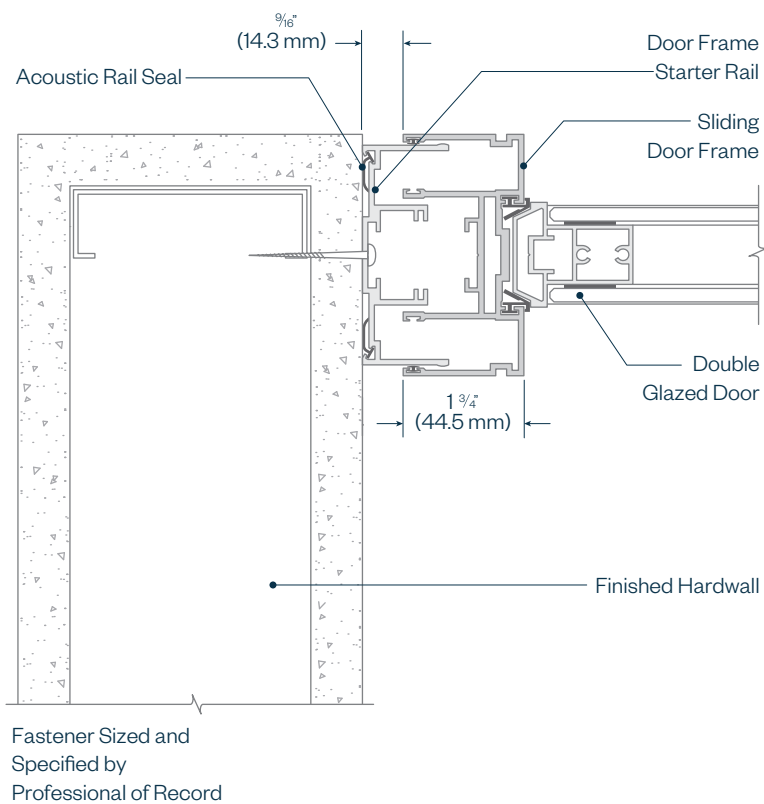

HAWORTH

# Trivati Architectural Details

## Trivati Door Frame Starter Double Glazed Pivot Door

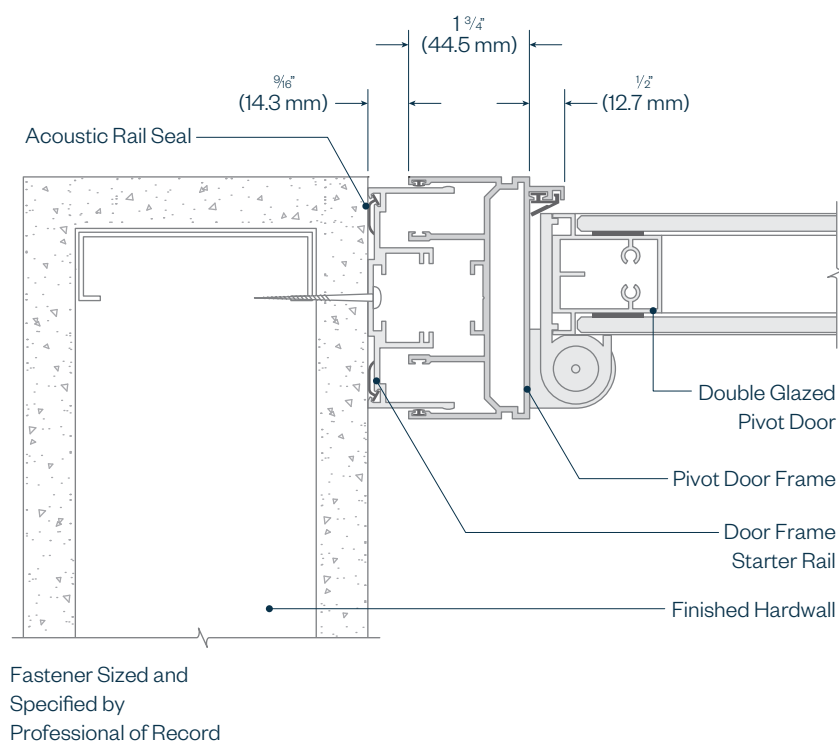

HAWORTH

# Trivati Architectural Details

## Trivati Door Frame Starter Glass Slab Sliding Door

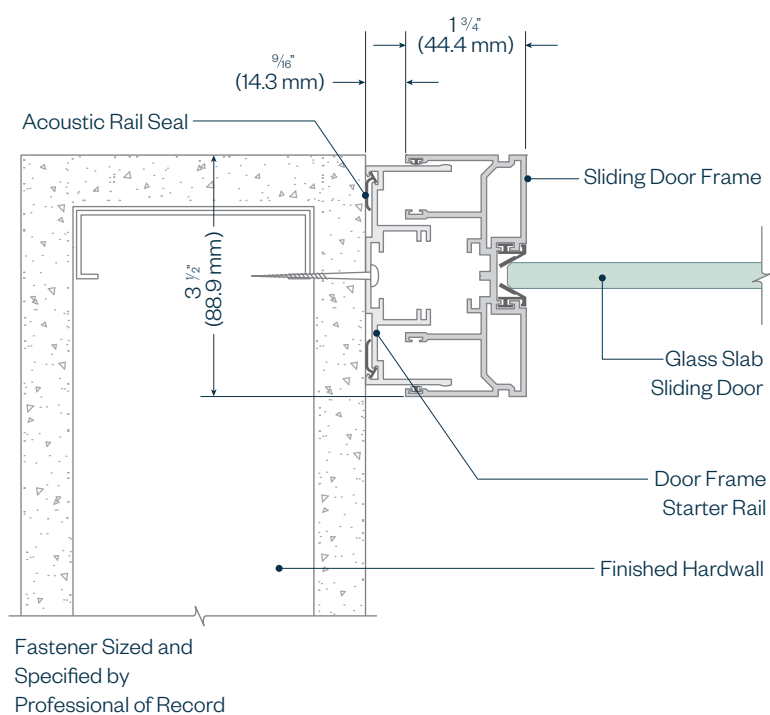

HAWORTH

# Trivati Architectural Details

## Trivati 2.5" Starter with Removable Clad Double Glazed Wall Span

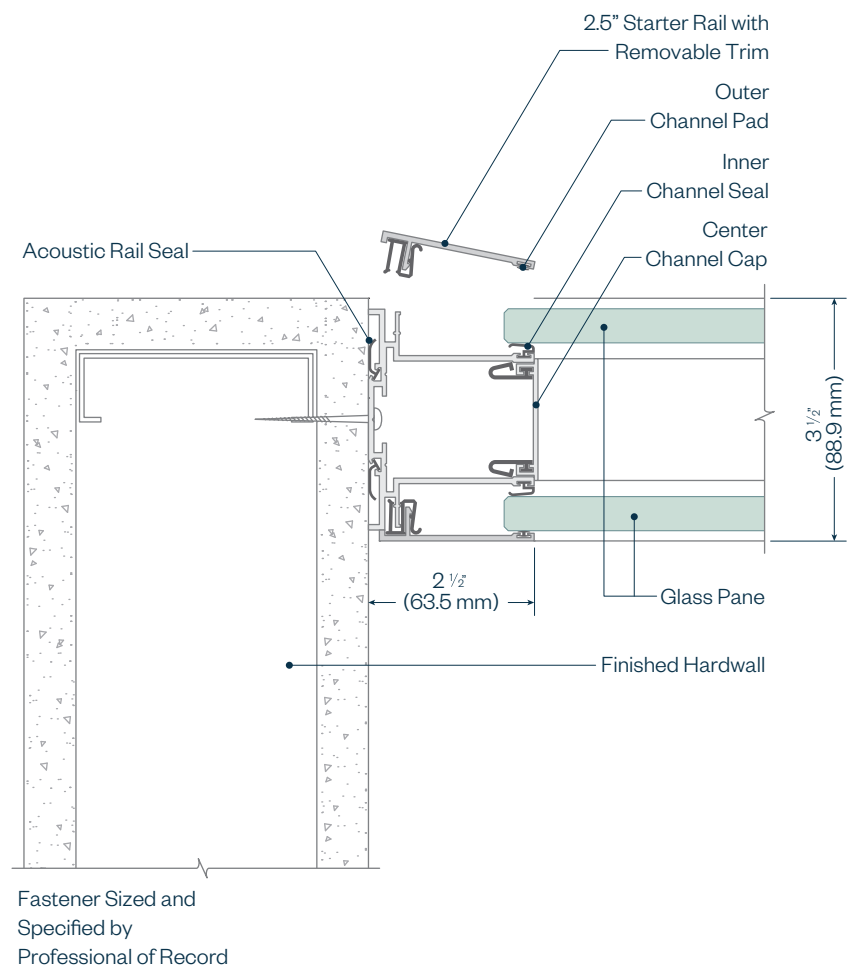



HAWORTH

# Trivati Architectural Details

## Trivati 2.5" Starter with Removable Clad Offset Glazed Wall Span

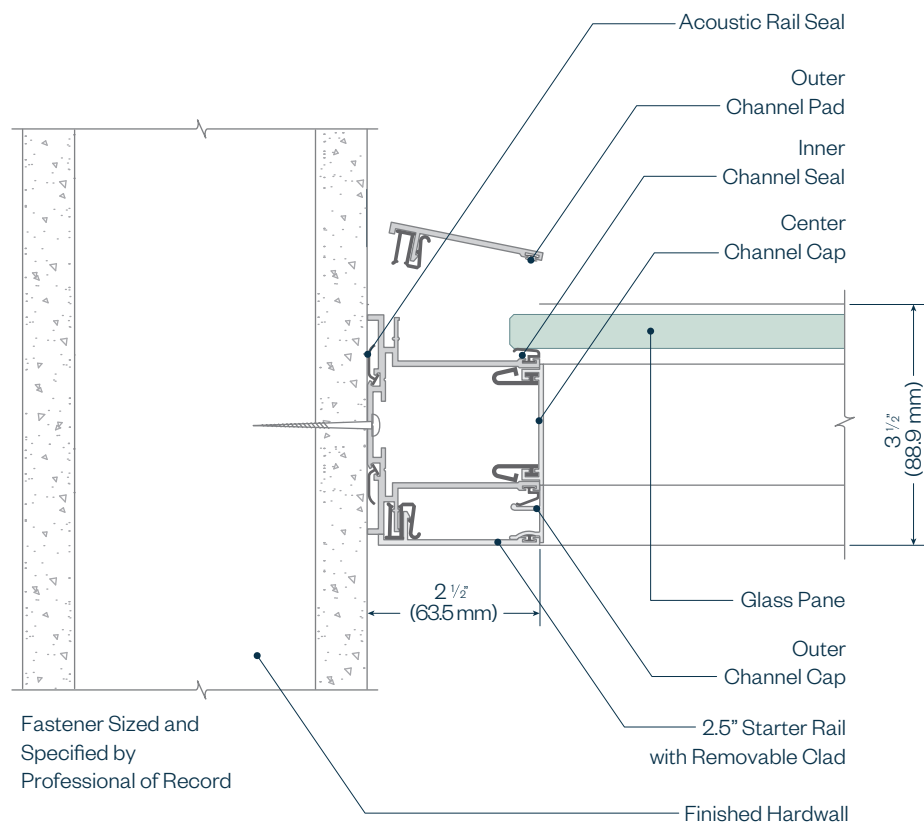

HAWORTH

# Trivati Architectural Details

## Trivati 1.5" Starter with Removable Clad Double Glazed Wall Span

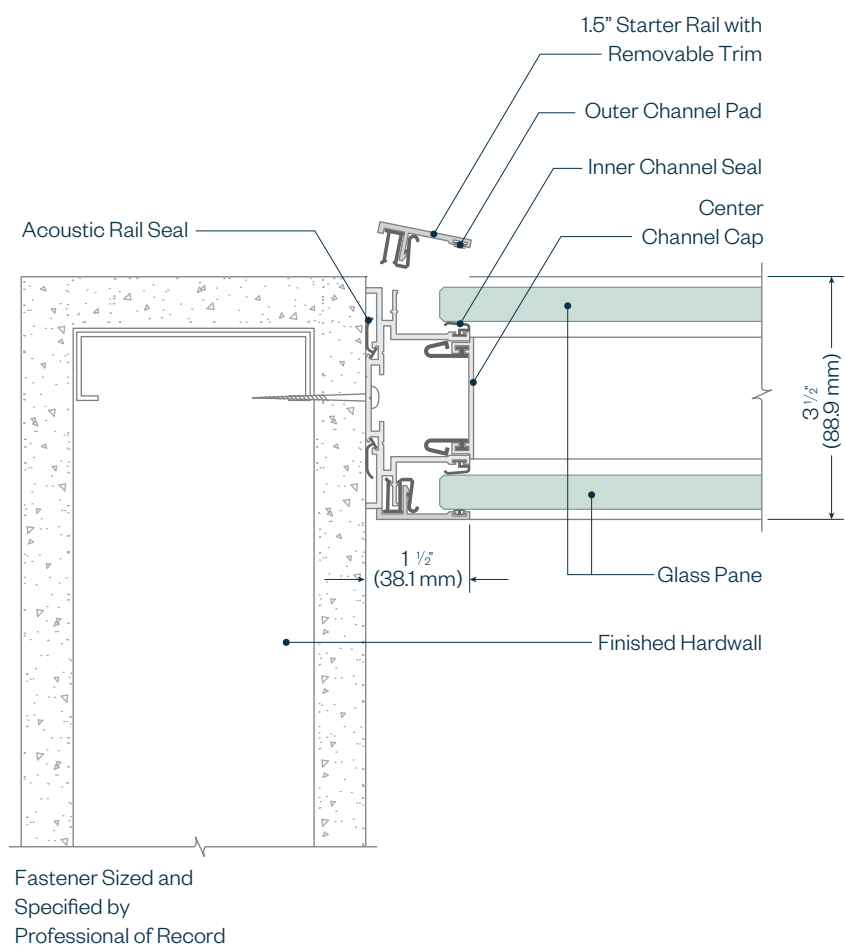

HAWORTH

# Trivati Architectural Details

Trivati 1.5" Starter with Removable Clad  
Offset Glazed Wall Span

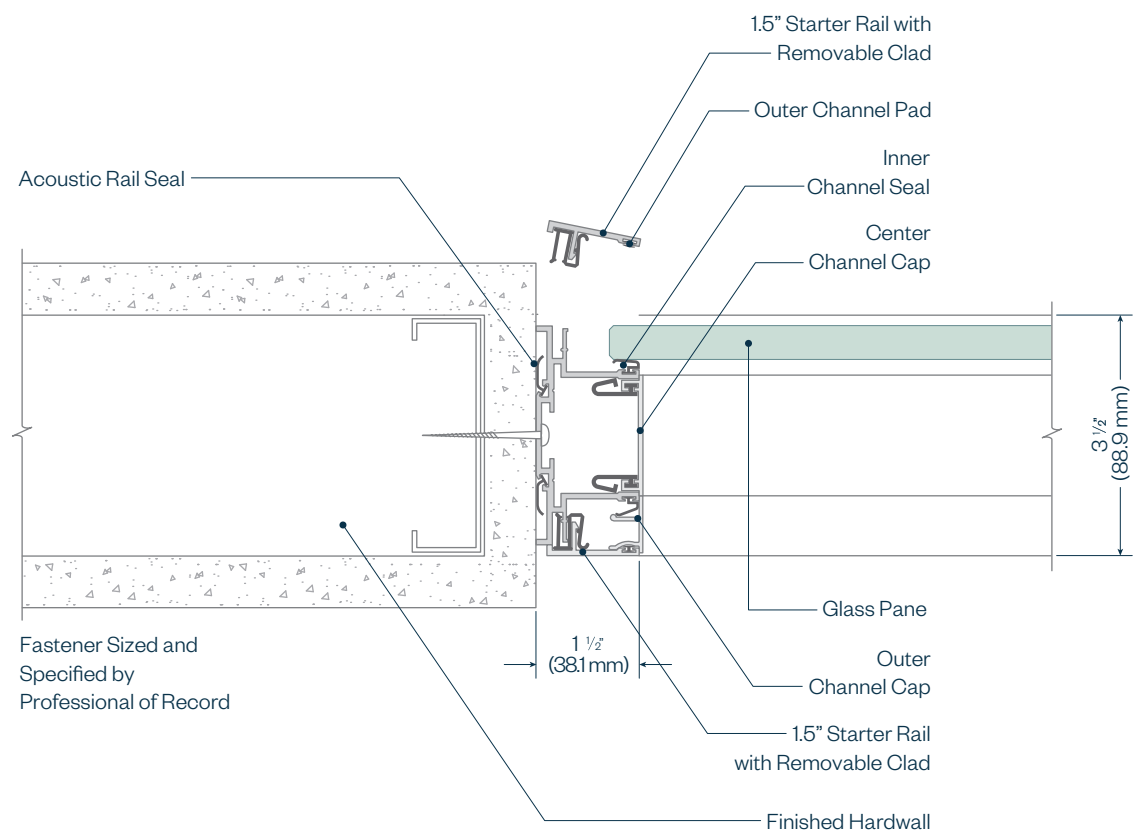

HAWORTH

# Trivati Architectural Details

## Trivati 2.5" Starter Double Glazed Wall Span

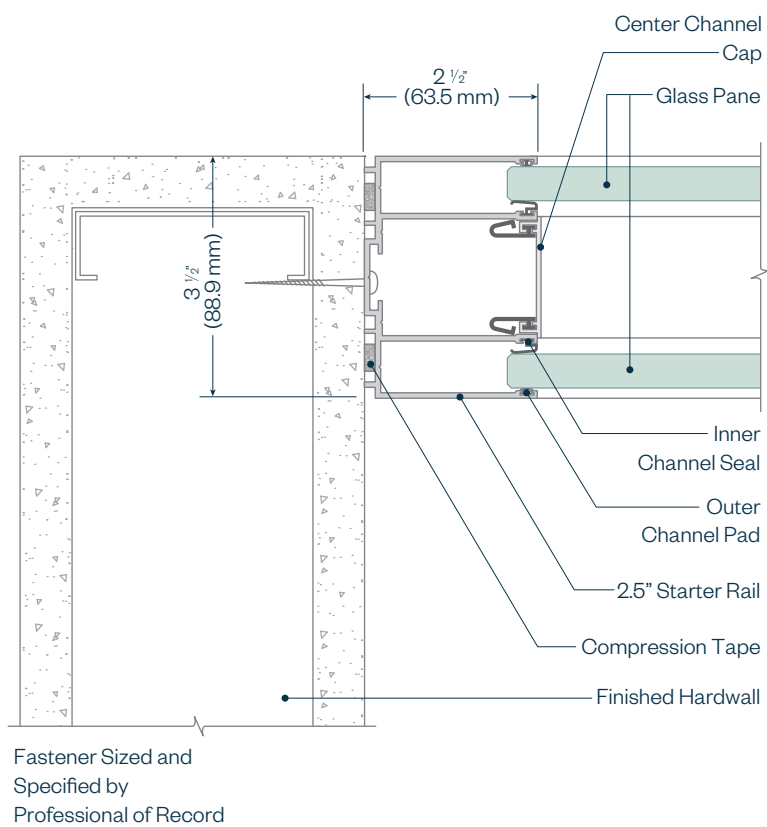

HAWORTH

# Trivati Architectural Details

## Trivati 2.5" Starter Offset Glazed Wall Span

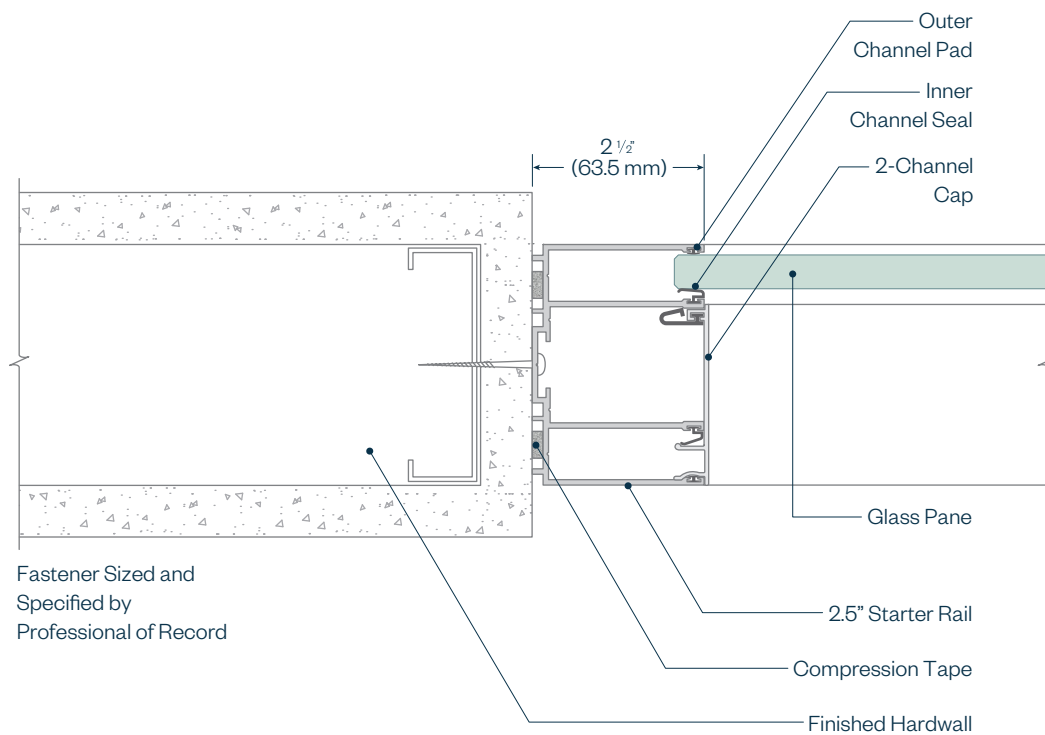

HAWORTH

# Trivati Architectural Details

## Trivati 1.5" Starter Double Glazed Wall Span

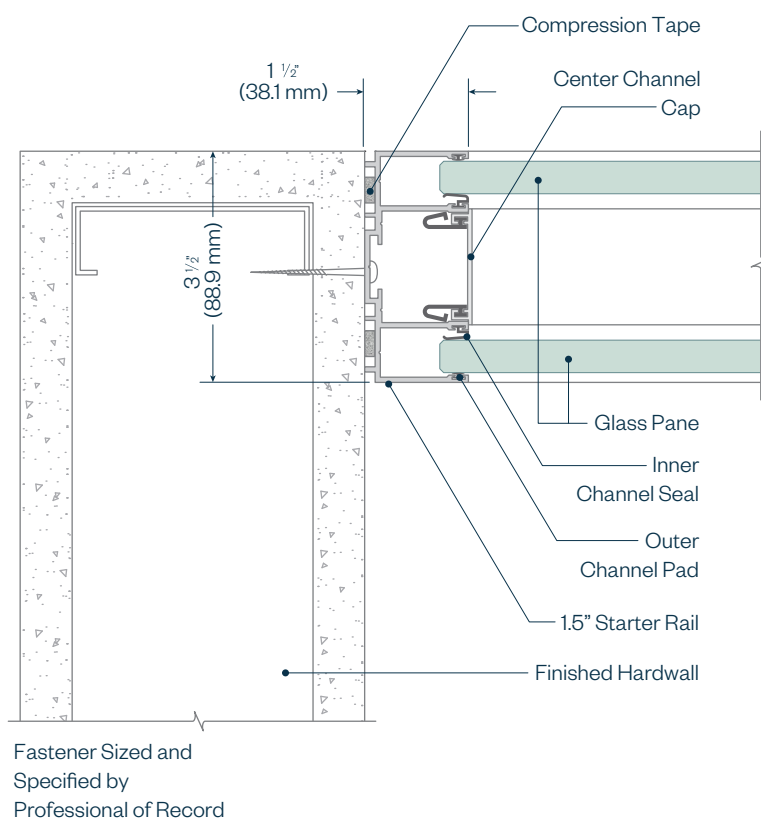

HAWORTH

# Trivati Architectural Details

## Trivati 1.5" Starter Offset Glazed Wall Span

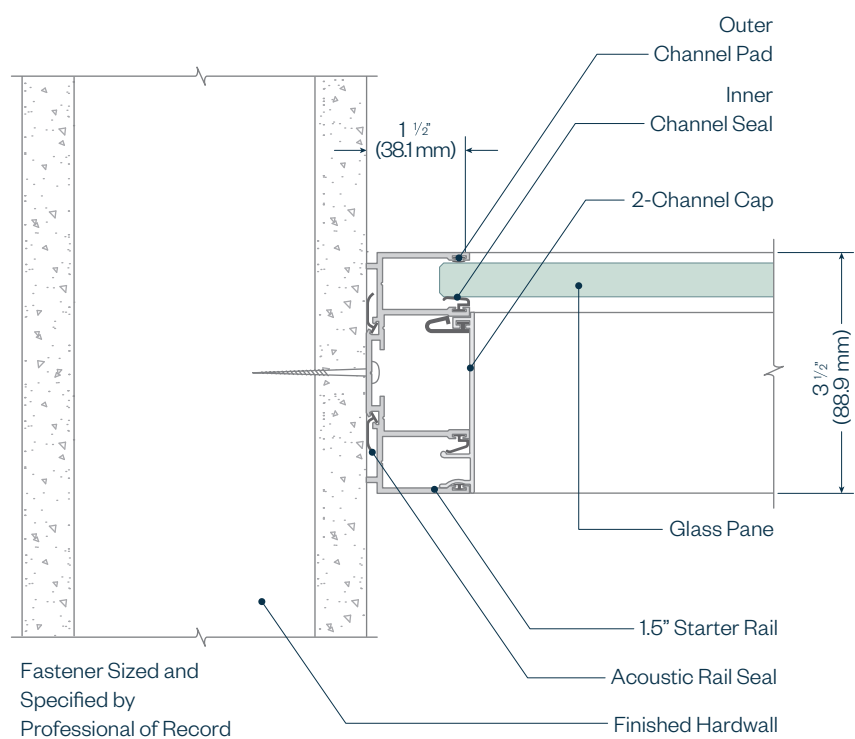

HAWORTH

# Trivati Architectural Details

## 1-Channel Trivati 2.5" Starter

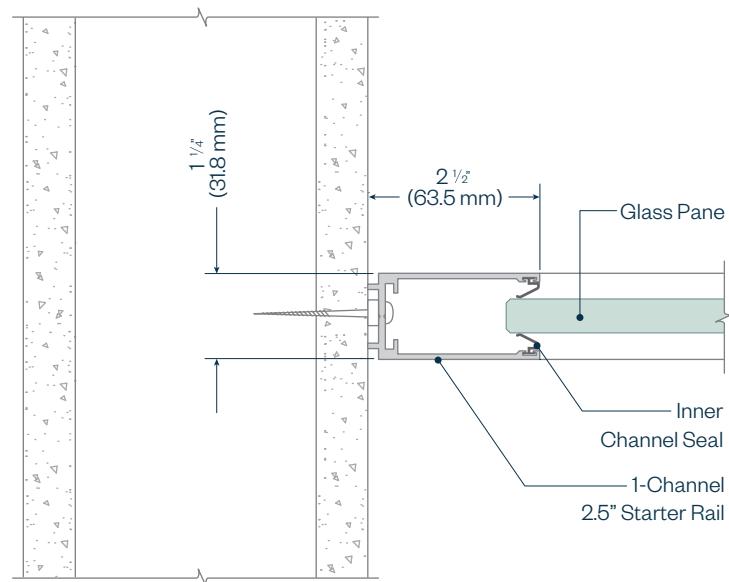

Fastener Sized and  
Specified by  
Professional of Record



HAWORTH

# Trivati Architectural Details

Trivati 90° Corner Post Transition

Offset Glazed Wall Span to Double Glazed Sliding Door

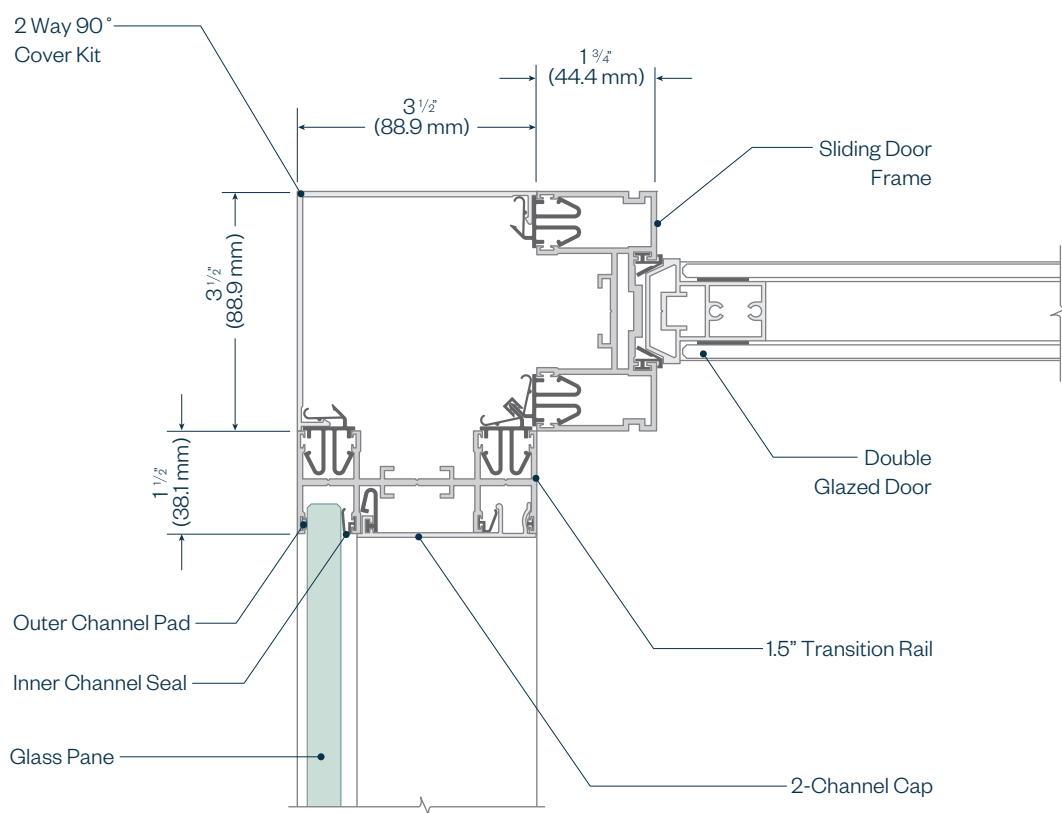

HAWORTH

# Trivati Architectural Details

Trivati 90° Corner Post Transition

Double Glazed Wall Span to Glass Slab Pivot Door

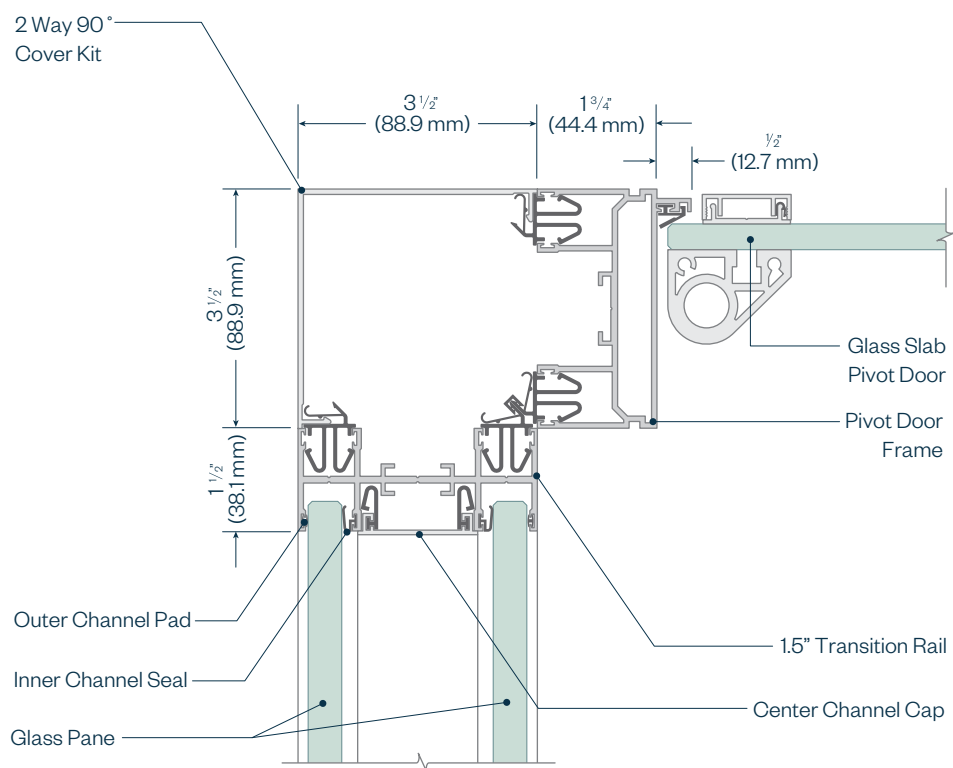

HAWORTH

# Trivati Architectural Details

Trivati 90° Corner Post Transition

Double Glazed Wall Span to Double Glazed Wall Span

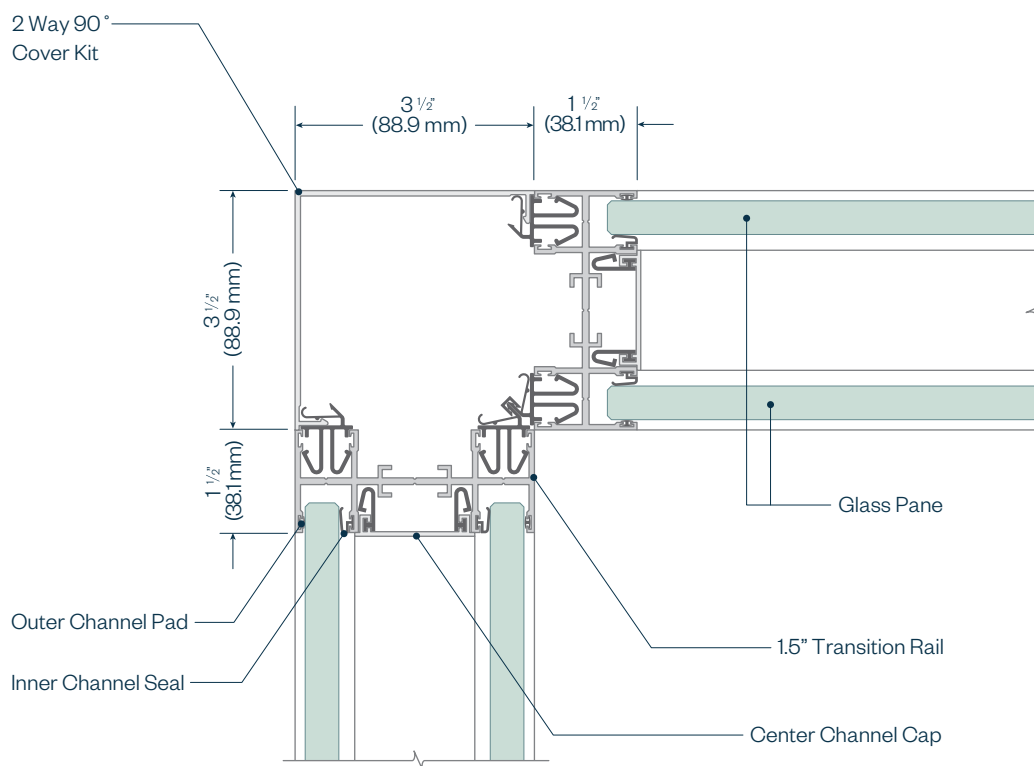

HAWORTH

# Trivati Architectural Details

Trivati 90° Corner Post Transition

Offset Glazed Wall Span to Double Glazed Wall Span

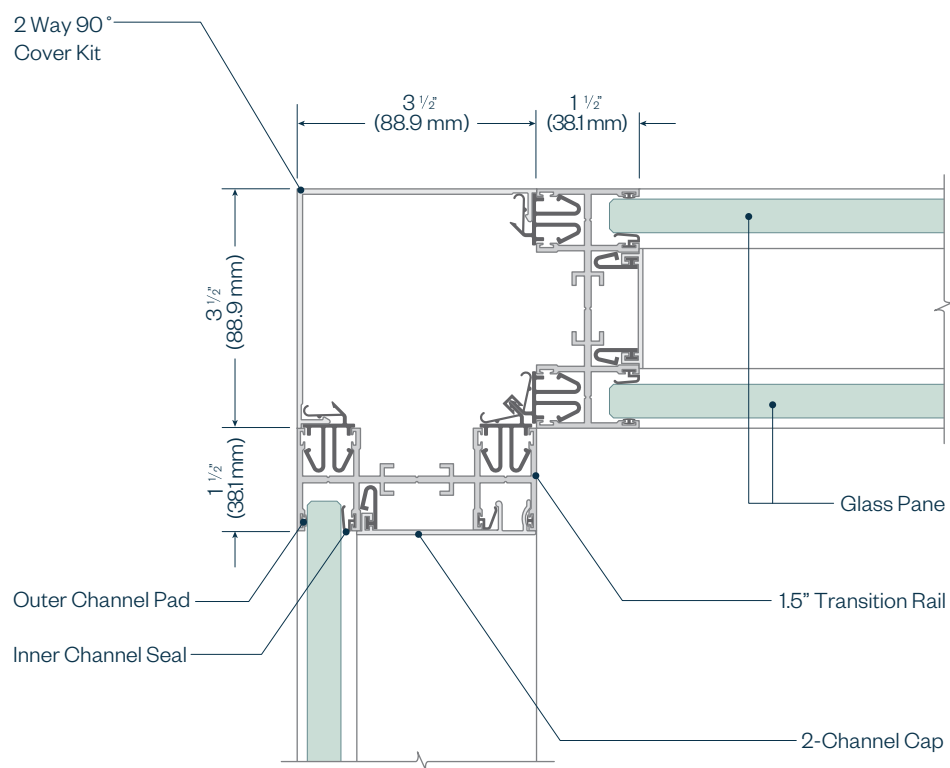

HAWORTH

# Trivati Architectural Details

## Trivati 90° Corner Post Transition

### Offset Glazed Wall Span to Offset Glazed Wall Span

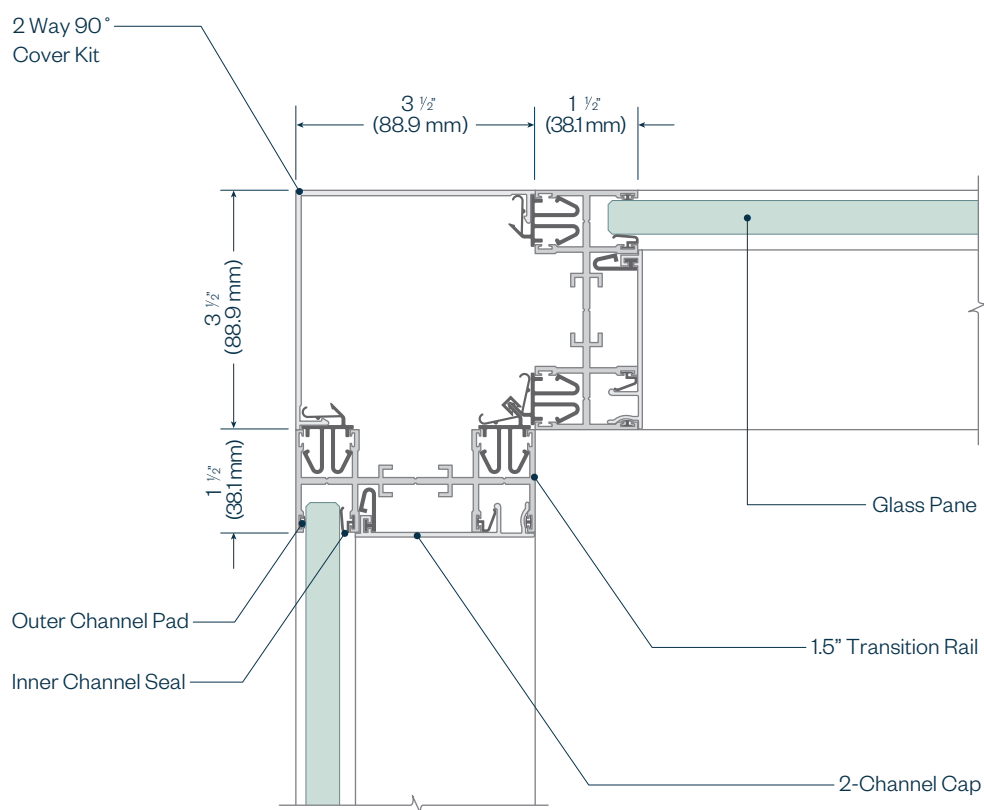

HAWORTH

# Trivati Architectural Details

Trivati 3-Way 90° with 3.5" Cover Kit

Double Glazed Pivot Door and Double Glazed Wall Spans

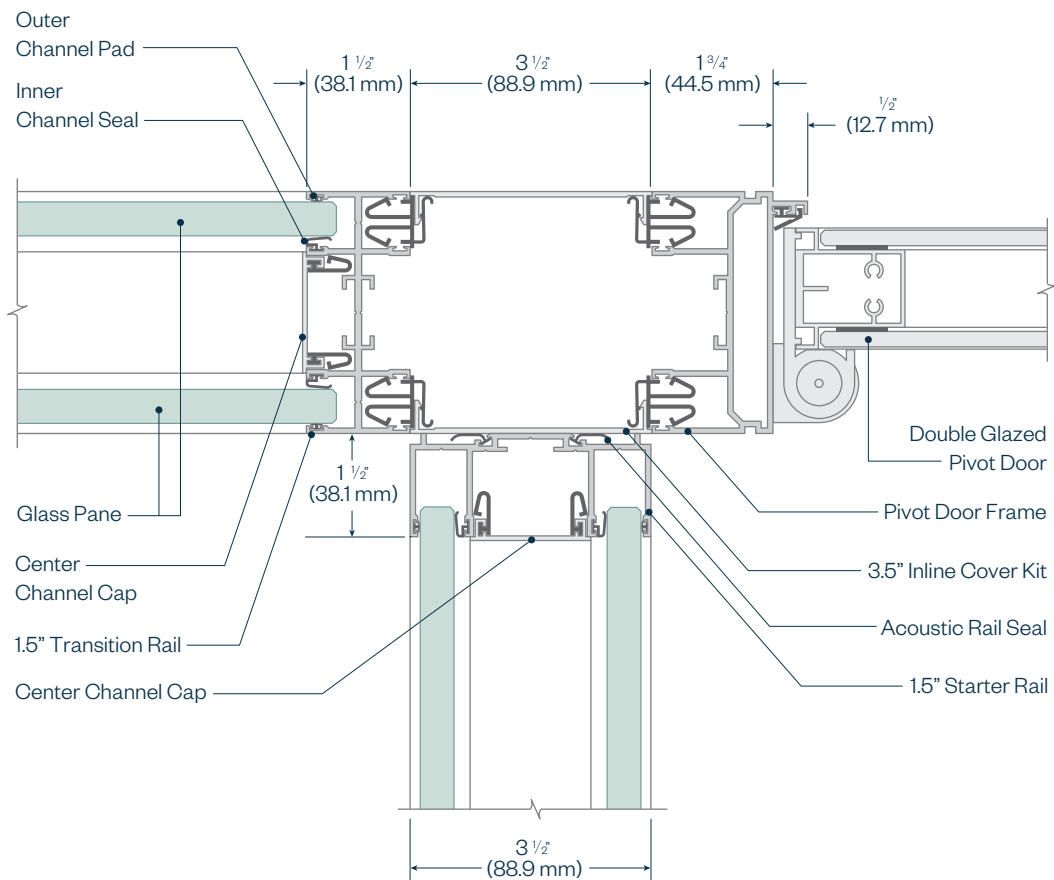

HAWORTH

# Trivati Architectural Details

Trivati 3-Way 90° with 3.5" Cover Kit

Glass Slab Pivot Door and Double Glazed Wall Spans

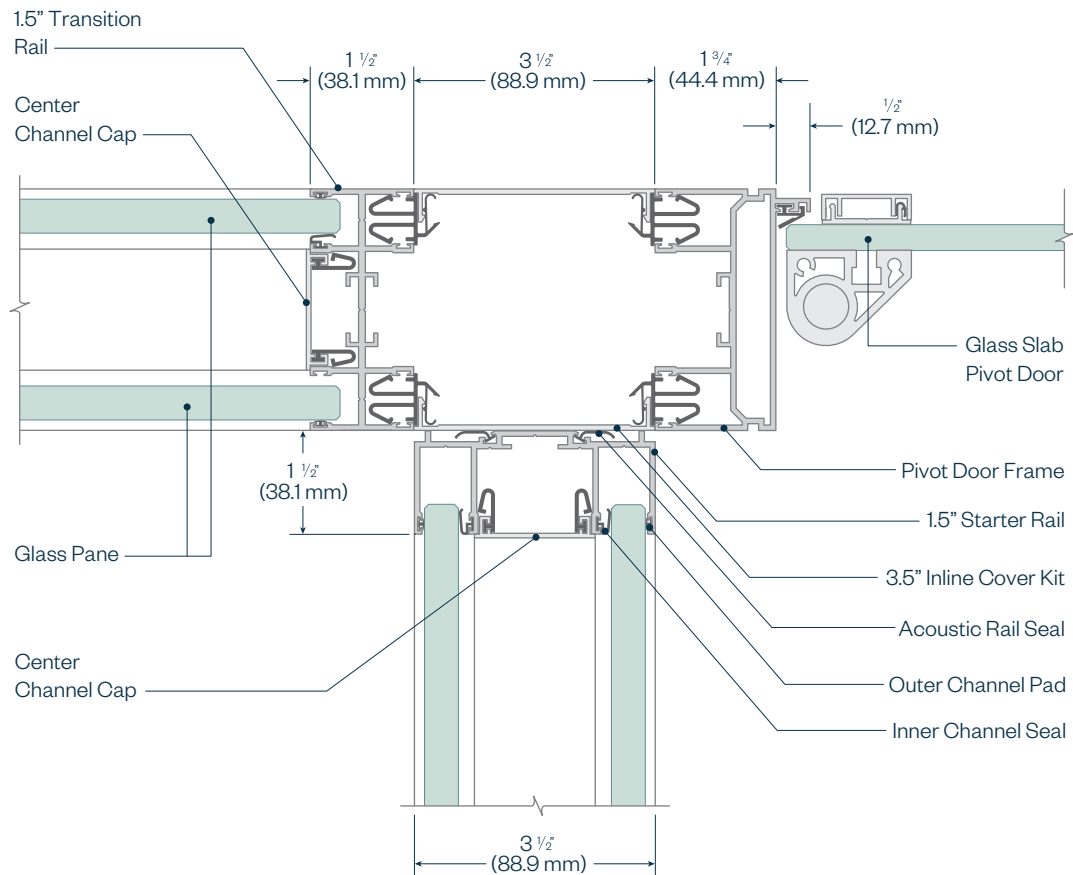

HAWORTH

# Trivati Architectural Details

Trivati 3-Way 90° with 3.5" Cover Kit

Wood Glazed Pivot Door and Double Glazed Wall Spans

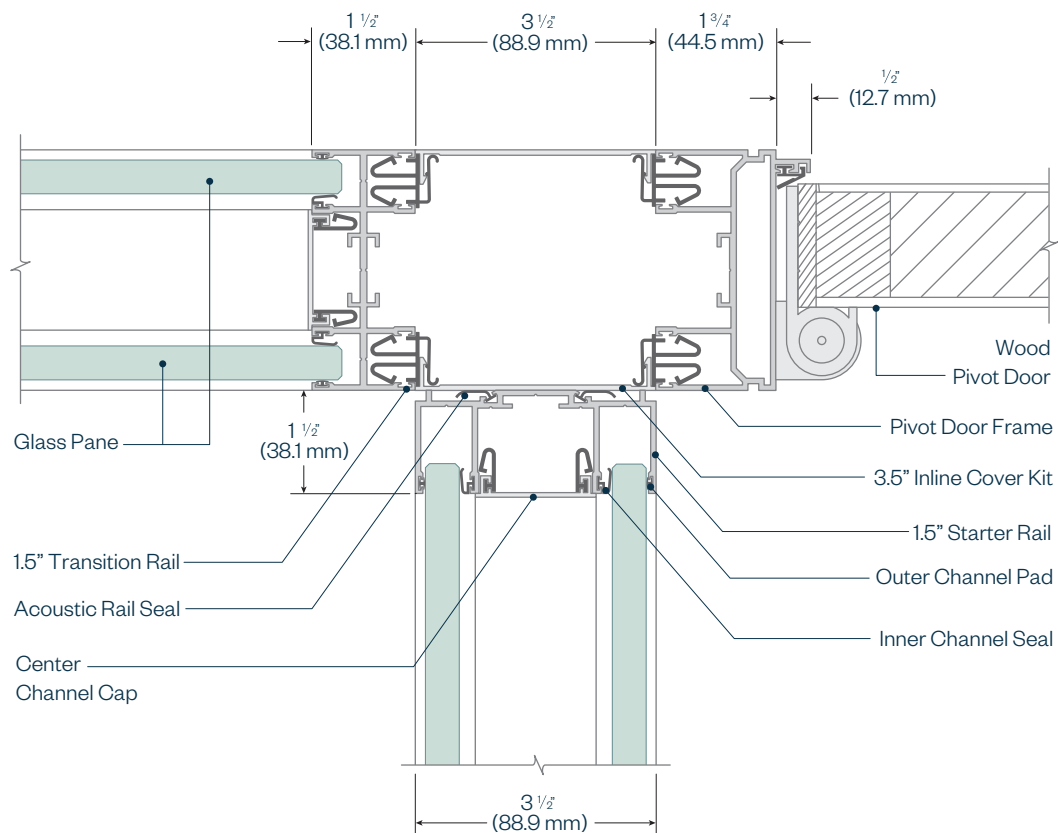



HAWORTH

# Trivati Architectural Details

Trivati 3-Way 90° with 3.5" Cover Kit

Back-to-Back Glass Slab Pivot Doors and Center Glazed Wall Span

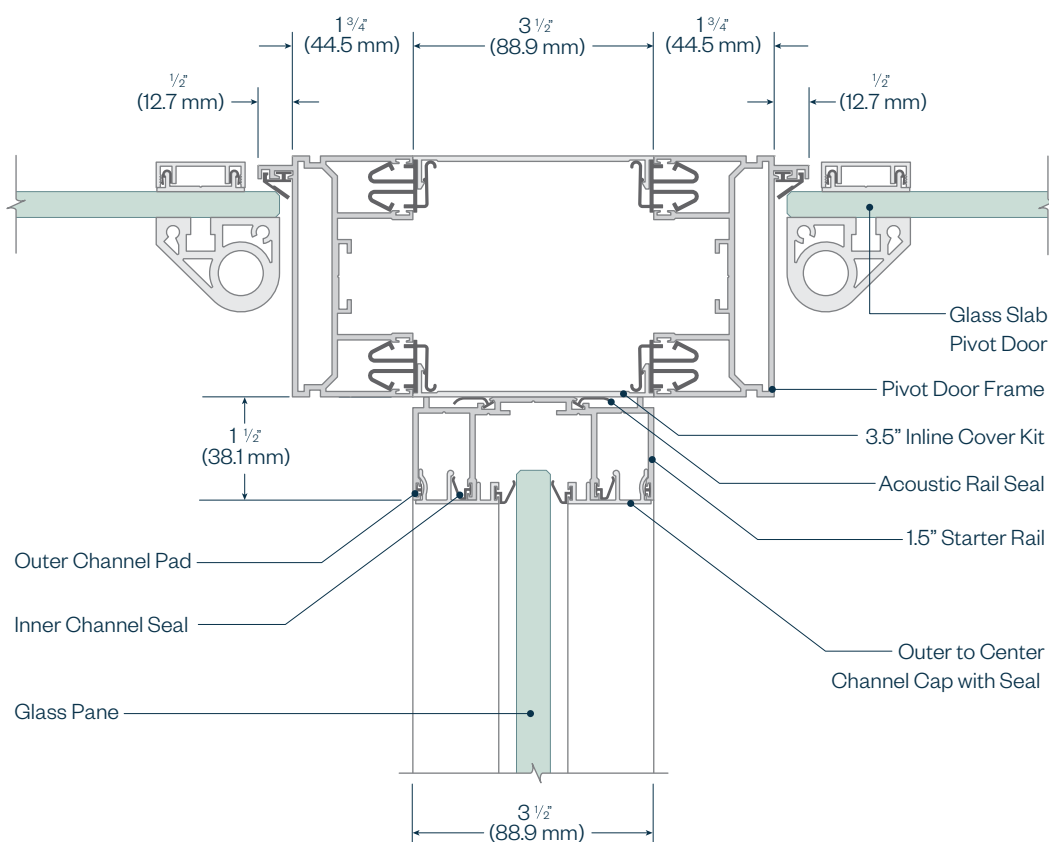

HAWORTH

# Trivati Architectural Details

Trivati 3-Way 90° with 3.5" Cover Kit

Back-to-Back Wood Pivot Doors and Double Glazed Wall Span

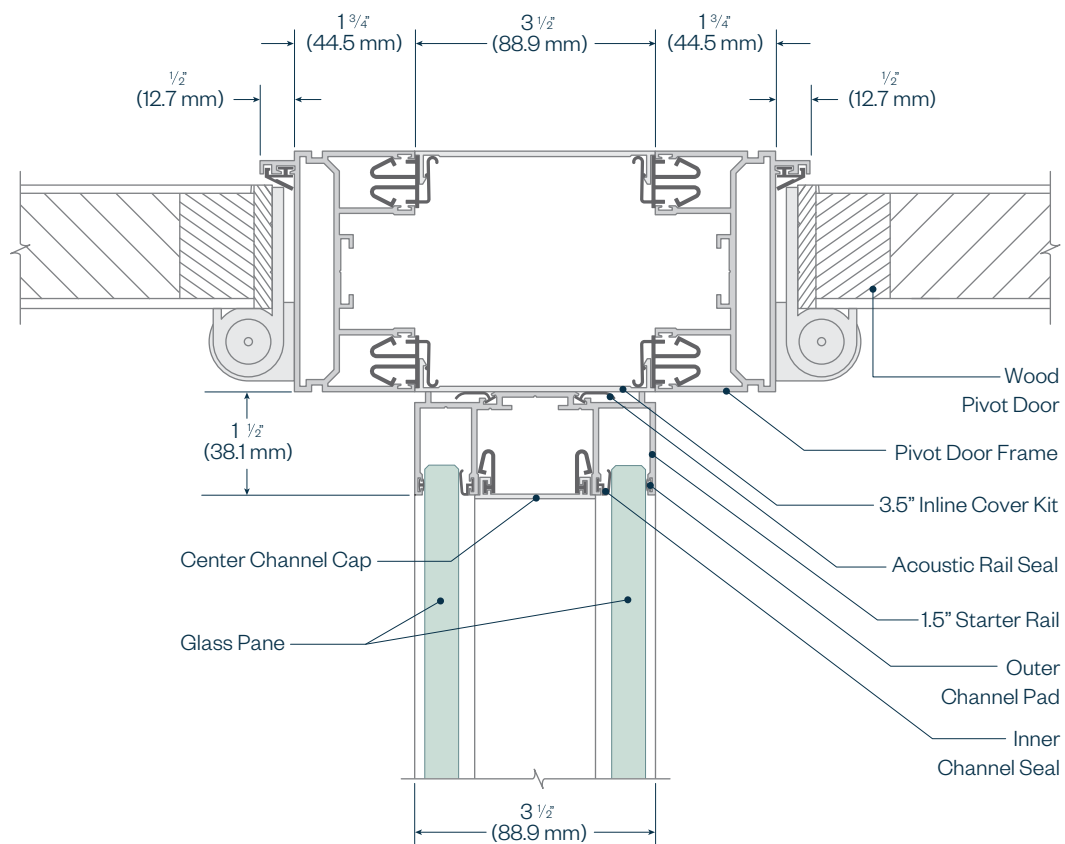

HAWORTH

# Trivati Architectural Details

Trivati 3-Way 90° with 3.5" Cover Kit

Back-to-Back Double Glazed Sliding Doors and Offset Glazed Wall Span

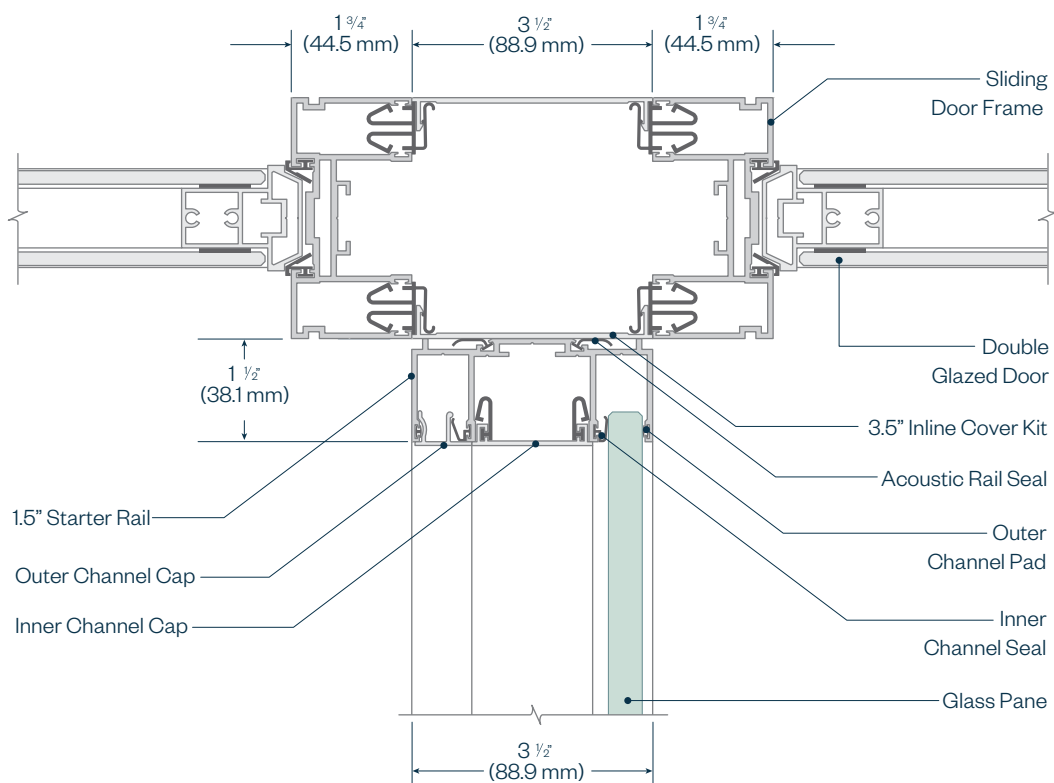

HAWORTH

# Trivati Architectural Details

Trivati 3-Way 90° with 3.5" Cover Kit

Back-to-Back Glass Slab Sliding Doors and Double Glazed Wall Span

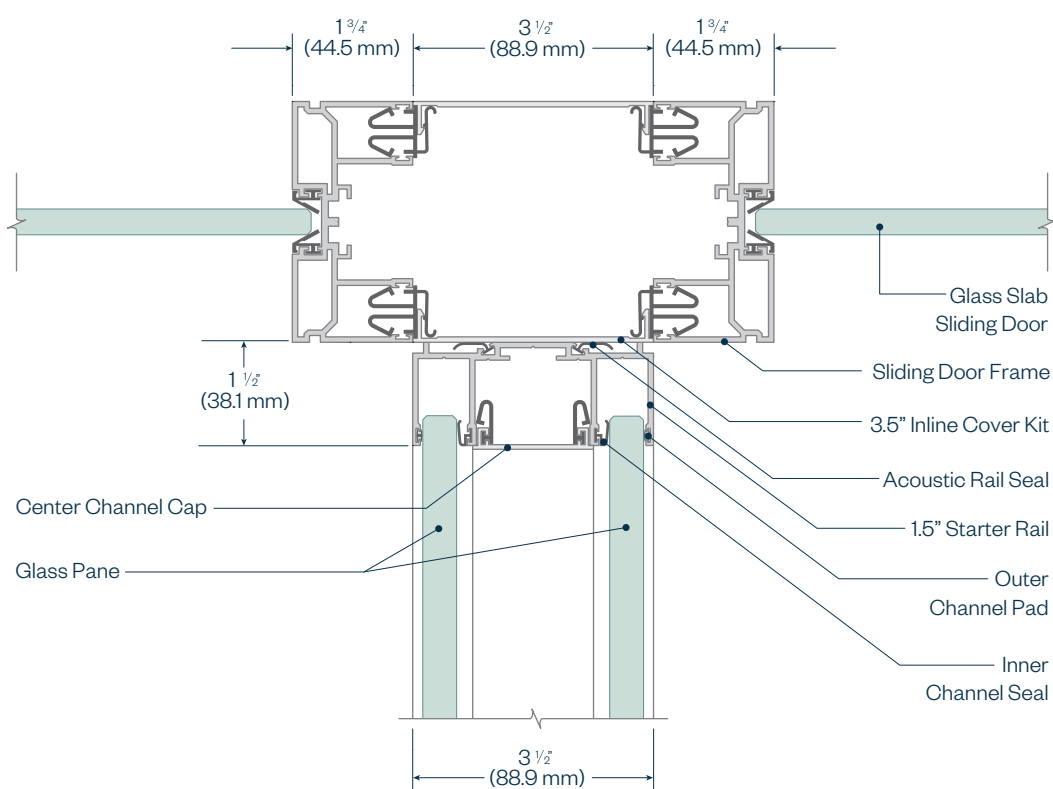

HAWORTH

# Trivati Architectural Details

Trivati 3-Way 90° with 3.5" Cover Kit

Double Glazed Sliding Door, Double Glazed Wall Span and Center Glazed Wall Span

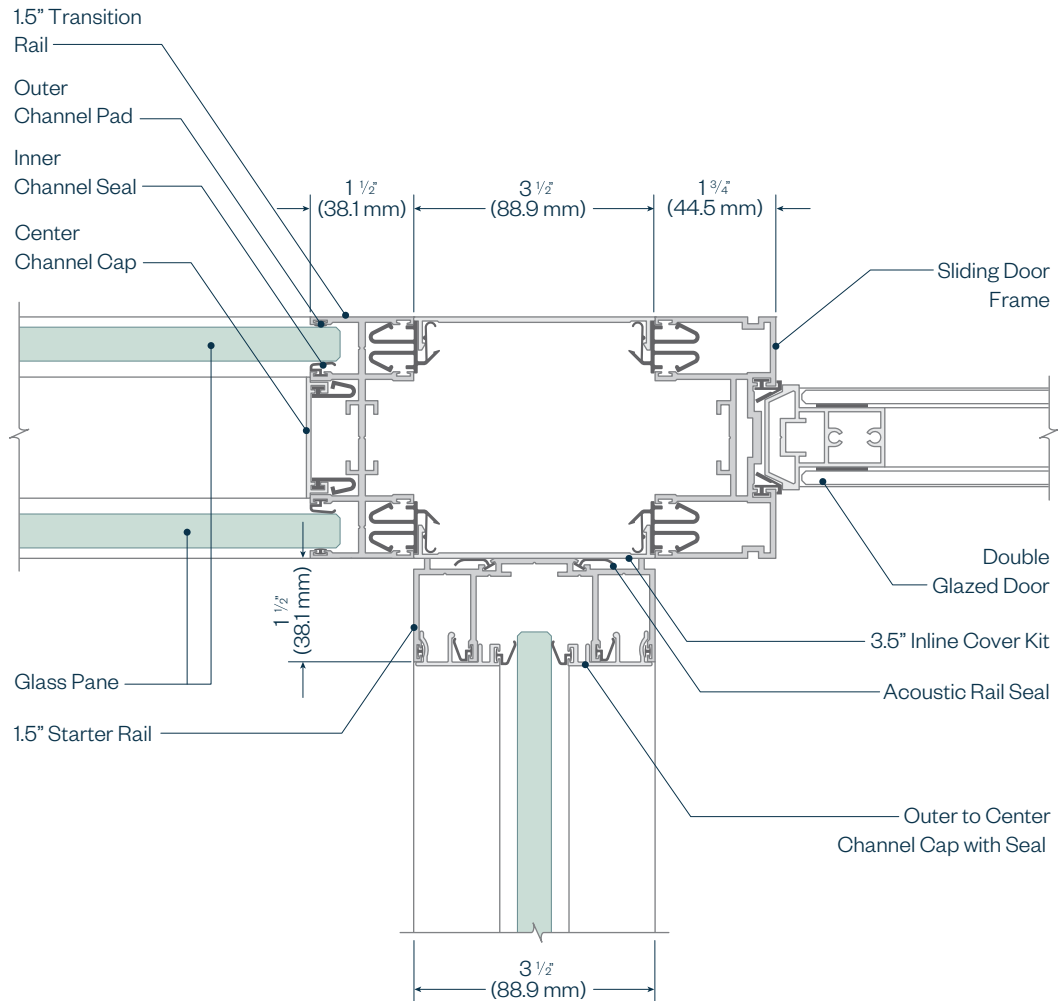

HAWORTH

# Trivati Architectural Details

Trivati 3-Way 90° with 3.5" Cover Kit

Glass Slab Sliding Door, Offset Glazed Wall Span and Center Glazed Wall Span

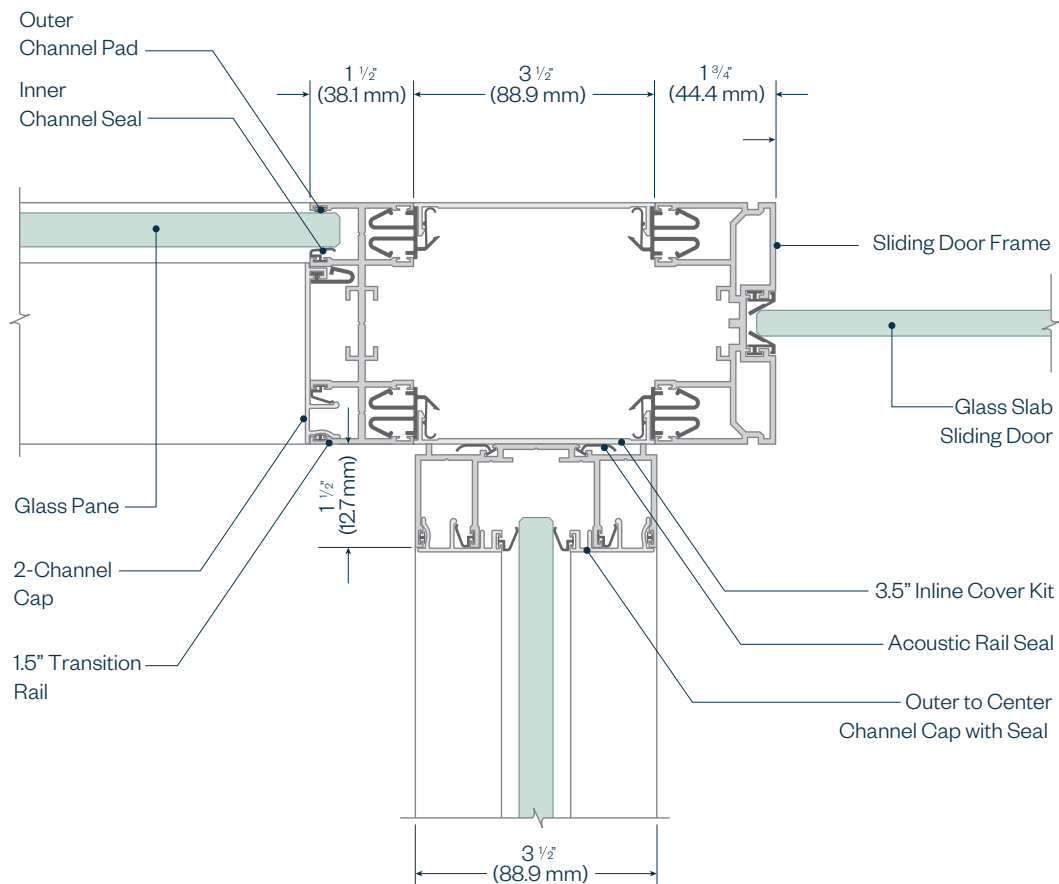

HAWORTH

# Trivati Architectural Details

## Trivati 3-Way 90° with 1-Channel Transition Rail

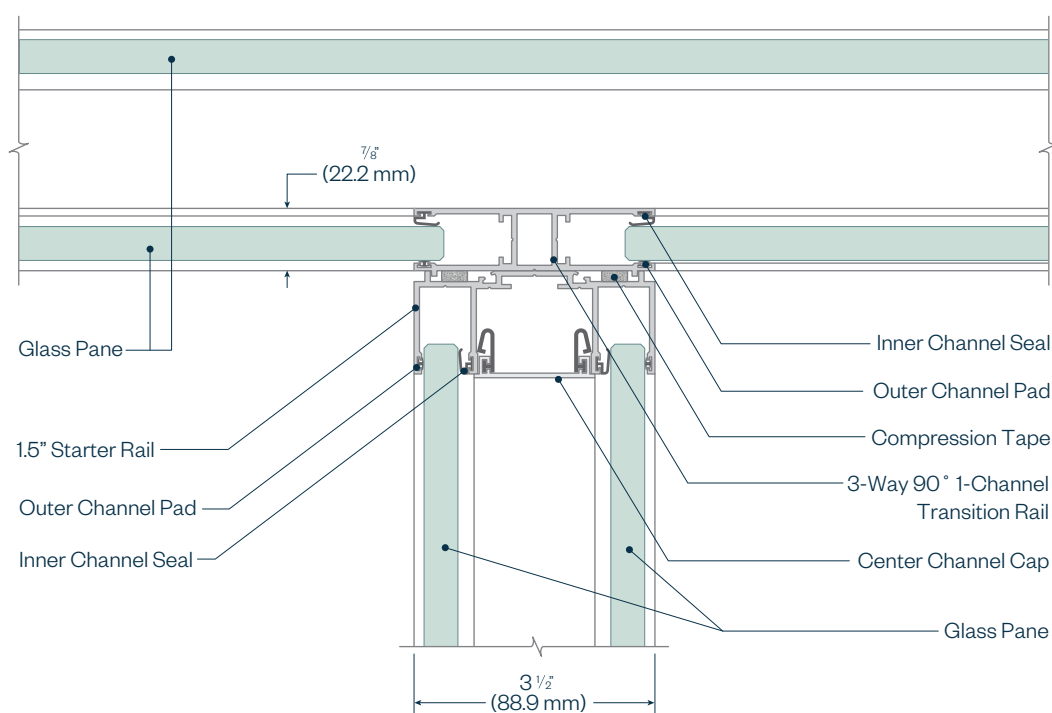

HAWORTH

# Trivati Architectural Details

## Trivati 3-Way 90° with 3.5" Cover Kit Double Glazed Wall Spans

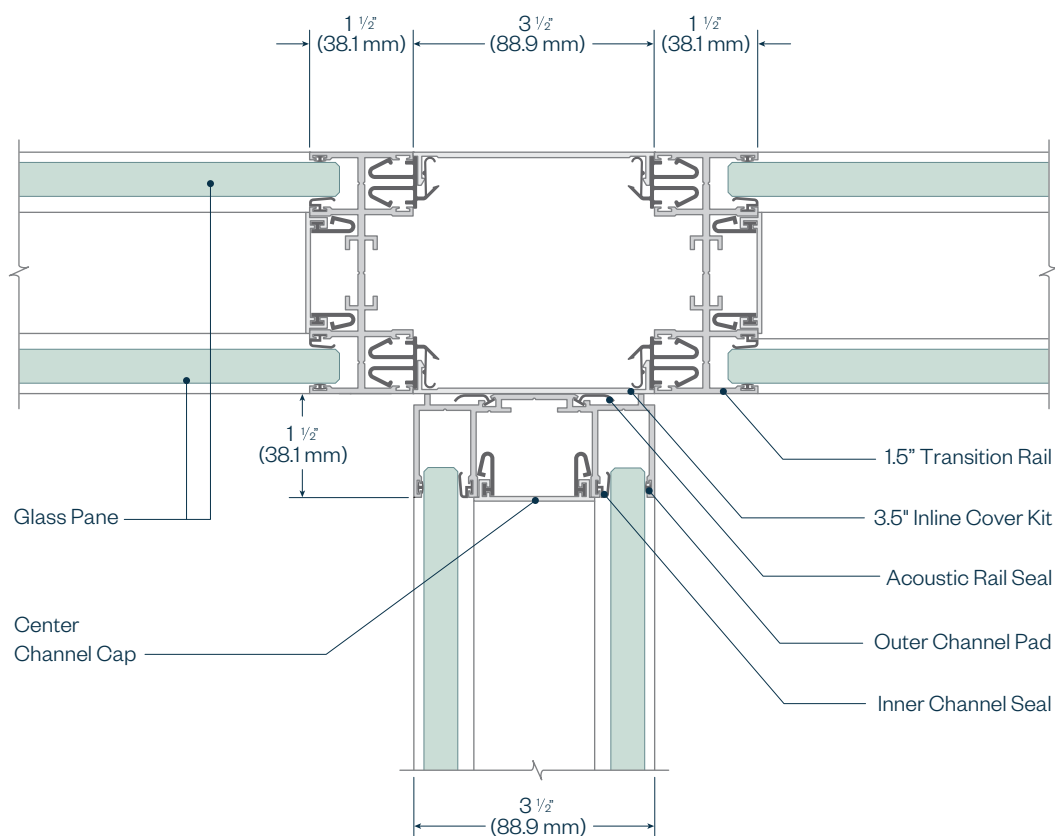



HAWORTH

# Trivati Architectural Details

Trivati 3-Way 90° with 3.5" Cover Kit

Offset Glazed Wall Spans and Center Glazed Wall Span

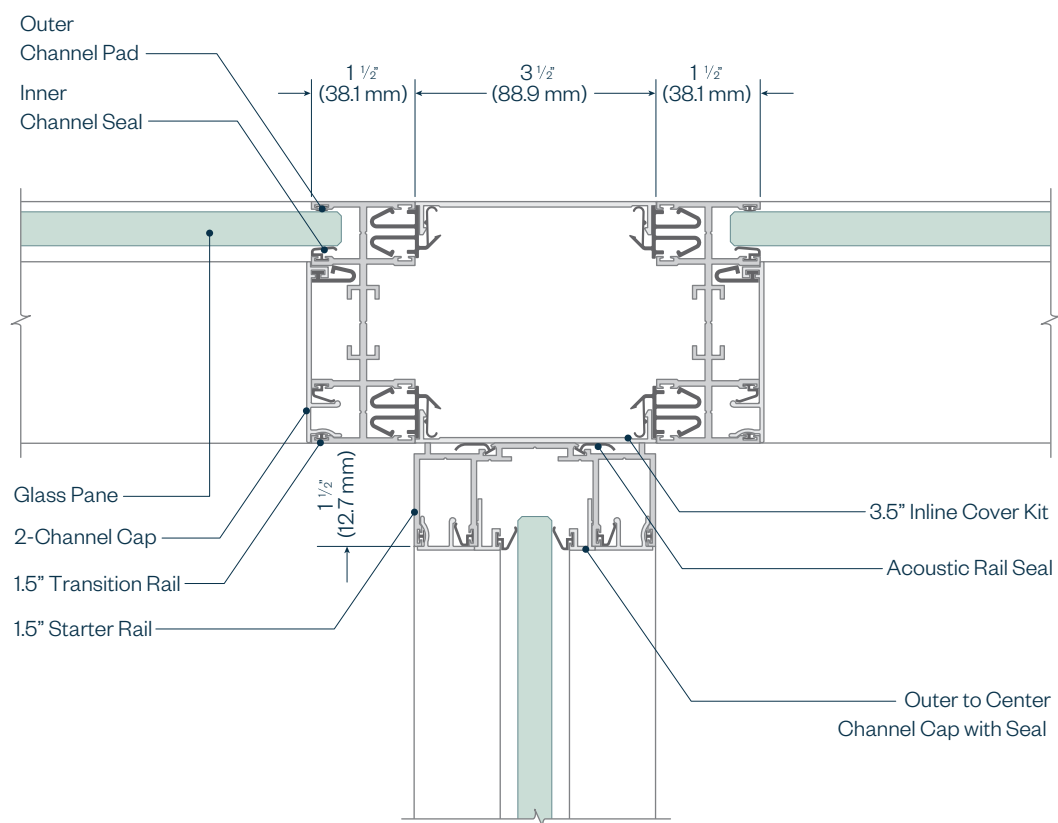

HAWORTH

# Trivati Architectural Details

## Trivati 3-Way 90° with 3.5" Cover Kit Center Glazed Wall Spans

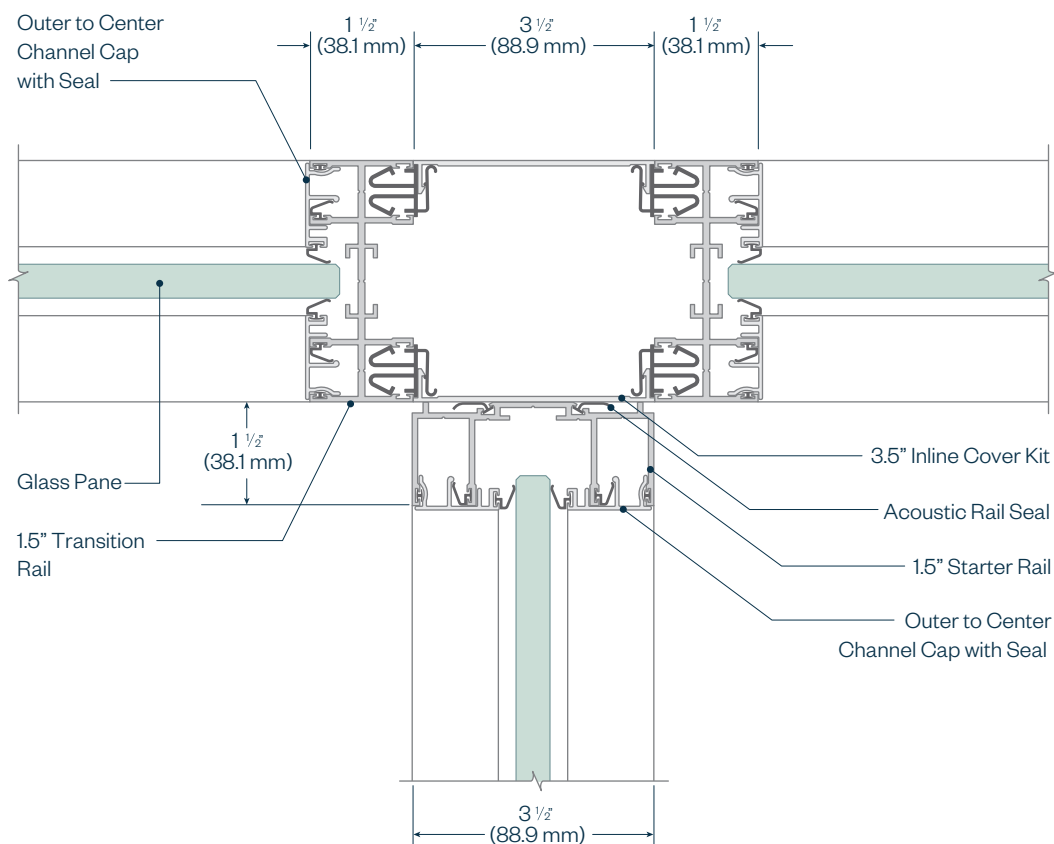

HAWORTH

# Trivati Architectural Details

## Trivati End of Run Double Glazed Wall Span

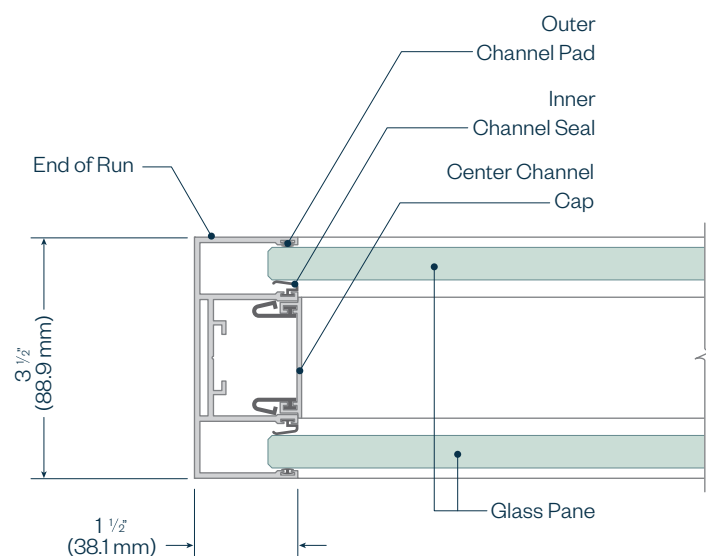

HAWORTH

# Trivati Architectural Details

## Trivati End of Run Offset Glazed Wall Span

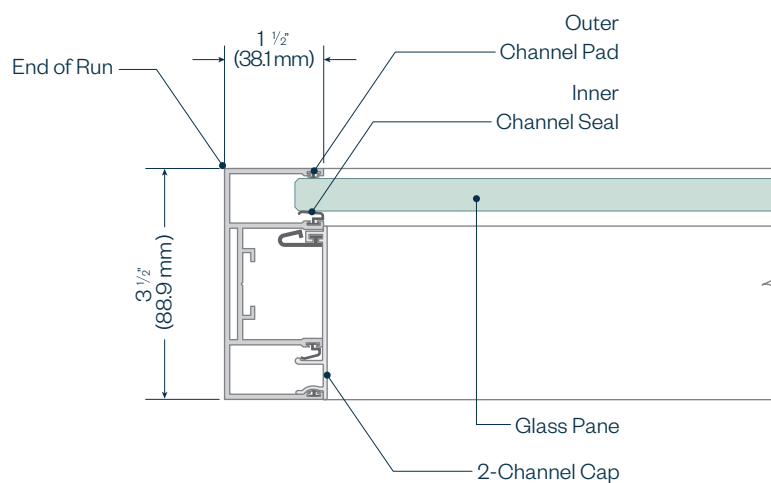

HAWORTH

# Trivati Architectural Details

## Ceiling Tile Detail - Vertical Section

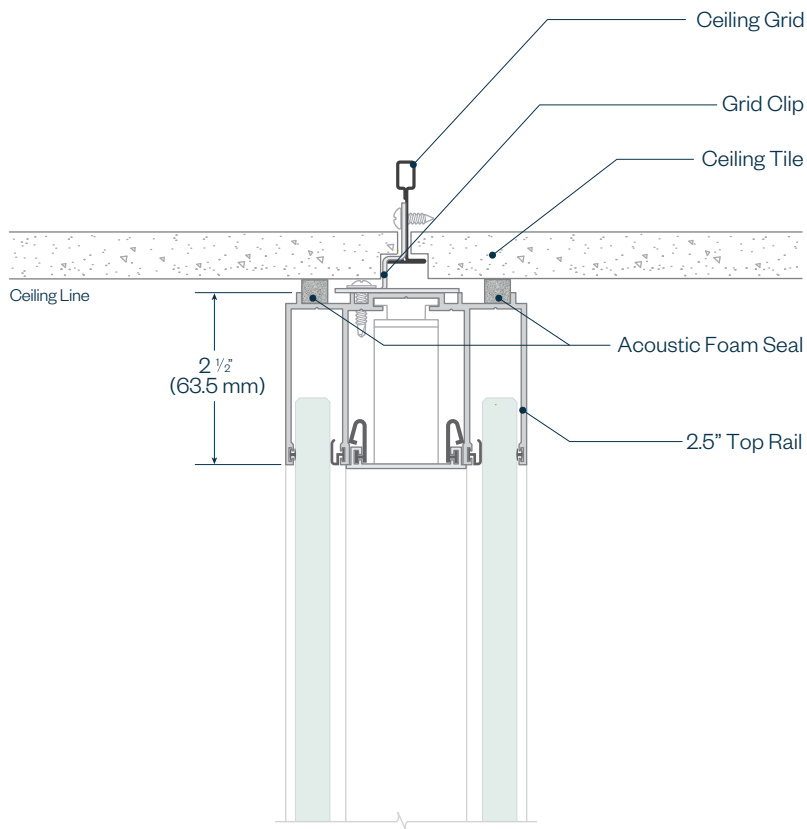

HAWORTH

# Trivati Architectural Details

## GWB Ceiling Detail - Vertical Section

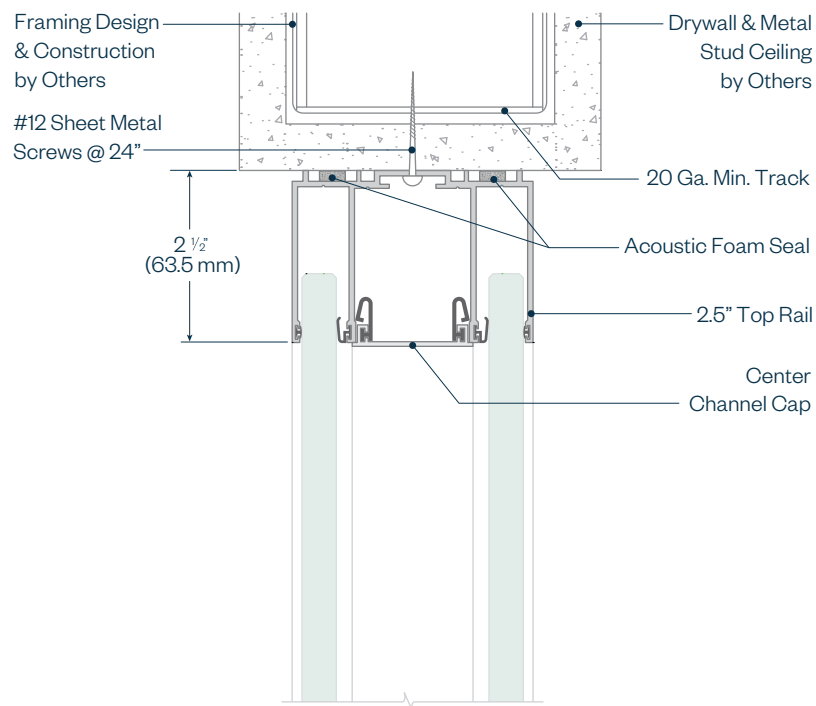

HAWORTH

# Trivati Architectural Details

## Double Sliding Door Turnbuckle Support

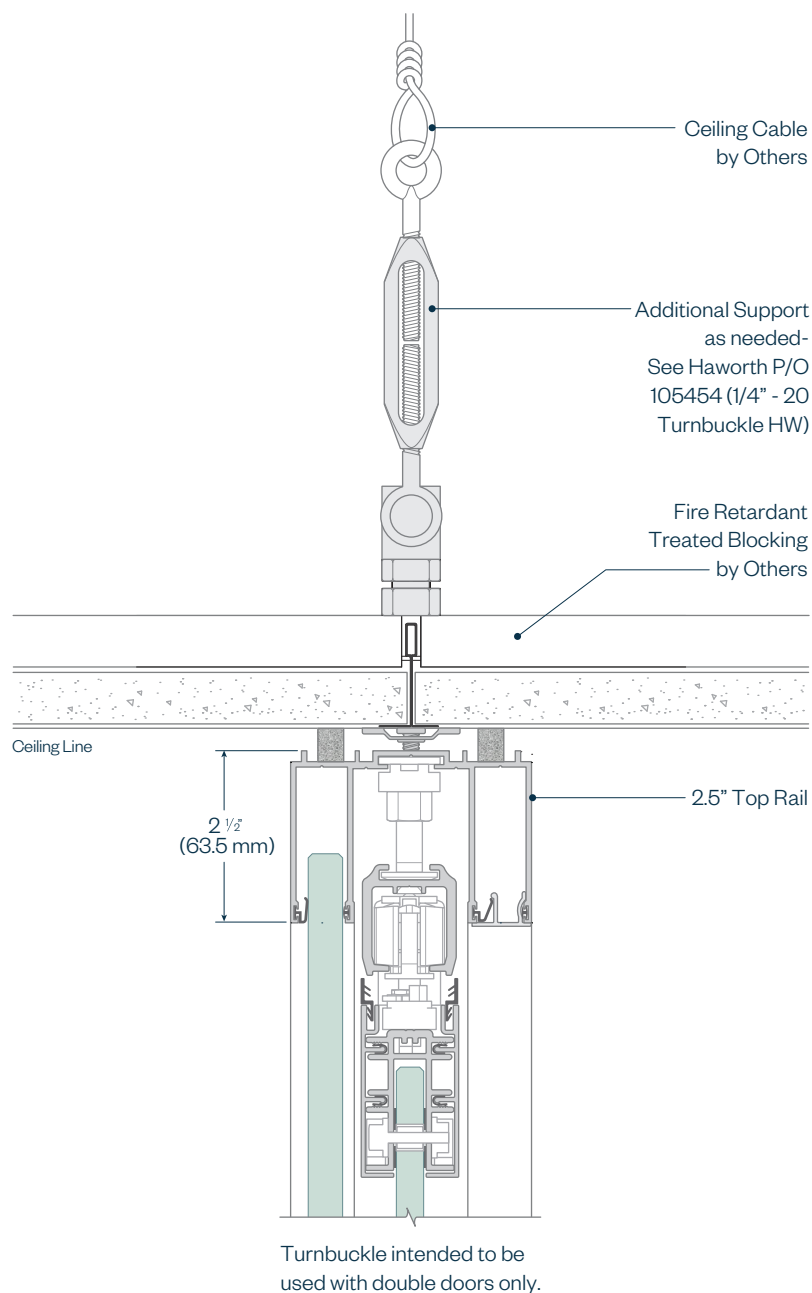

HAWORTH

# Trivati Architectural Details

## Lateral Bracing - Vertical Section

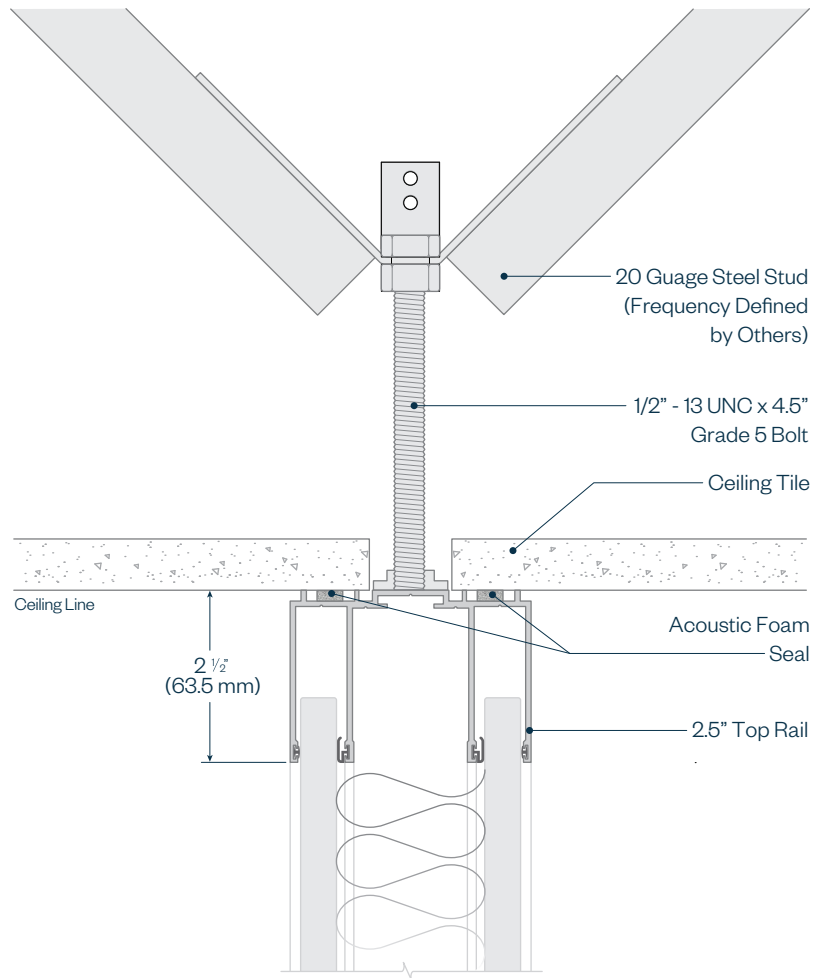

Base building construction must be in accordance to local site building code requirements.

Details for lateral bracing are shown as a guide and are not project specific. It is the responsibility of the engineer of record to determine appropriate interpretation/application of information provided in these drawings based on project requirements.