

HAWORTH

# Enclose & EFG Architectural Details

## Panel Types

- o 2 Channel Enclose Frameless Glass Double Glazed
- o 2 Channel Enclose Frameless Glass Offset Glazed
- o Enclose Frameless Glass
- o Enclose Frameless Glass Stack
- o Enclose Glass Panel
- o Enclose Solid Panel
- o Enclose Glass Panel with Muntins
- o Enclose Clerestory
- o Enclose Combi Panel with Transom
- o Enclose Glass Stack
- o Enclose Solid Stack

## Doors

- o Enclose Frameless Glass Double Glazed Pivot Door
- o Enclose Frameless Glass Slab Sliding Door
- o Enclose Frameless Glass Slab Pivot Door
- o Enclose Frameless Glass Aluminum Glazed Sliding Door
- o Enclose Frameless Glass Aluminum Glazed Butt-Hinge Door
- o Enclose Glass Slab Sliding Door
- o Enclose Glass Slab Pivot Door
- o Enclose Aluminum Glazed Sliding Door
- o Enclose Aluminum Glazed Butt-Hinge Door
- o Enclose Wood Butt-Hinge Door
- o Enclose Glass Slab Pivot Door with Glass Transom

## Starters

- o Starter - Compressible 2 Channel Enclose Frameless Glass
- o Starter - Compressible Enclose Frameless Glass
- o Starter - Compressible Enclose Glass
- o Starter - Compressible Enclose Solid
- o Starter - Low Profile
- o Starter - Adjustable
- o Starter - Enclose Cuttable
- o Starter - Mullion Expandable Cladding
- o Starter - Hardwall Expandable Cladding
- o Starter - Center Chamfer
- o Starter - Flush Flyby

# Enclose & EFG Architectural Details

## Floor and Ceiling Typicals

- o Enclose Frameless Glass Ceiling Connection - Tile
- o Enclose Frameless Glass Ceiling Connection - Drywall
- o Enclose Ceiling Connection - Tile
- o Enclose Ceiling Connection - Drywall
- o 2 Channel Enclose Frameless Glass Floor Connection
- o Enclose Frameless Glass Floor Connection
- o Enclose Glass Panel Floor Connection - Carpet
- o Enclose Glass Panel Floor Connection - Hard
- o Enclose Solid Panel Floor Connection - Carpet
- o Enclose Freestanding
- o Enclose Freestanding - Chinook

## Lateral Bracing

- o Lateral Bracing - Ceiling with Wire Ties Only
- o Lateral Bracing - Ceiling with Kicker Studs
- o Lateral Bracing - Ceiling with Compression Strut
- o Lateral Bracing - Carpet
- o Lateral Bracing - Hard Floor
- o Lateral Bracing - Compressible Starter

HAWORTH

# Enclose & EFG Architectural Details

## 2 Channel Enclose Frameless Glass Double Glazed

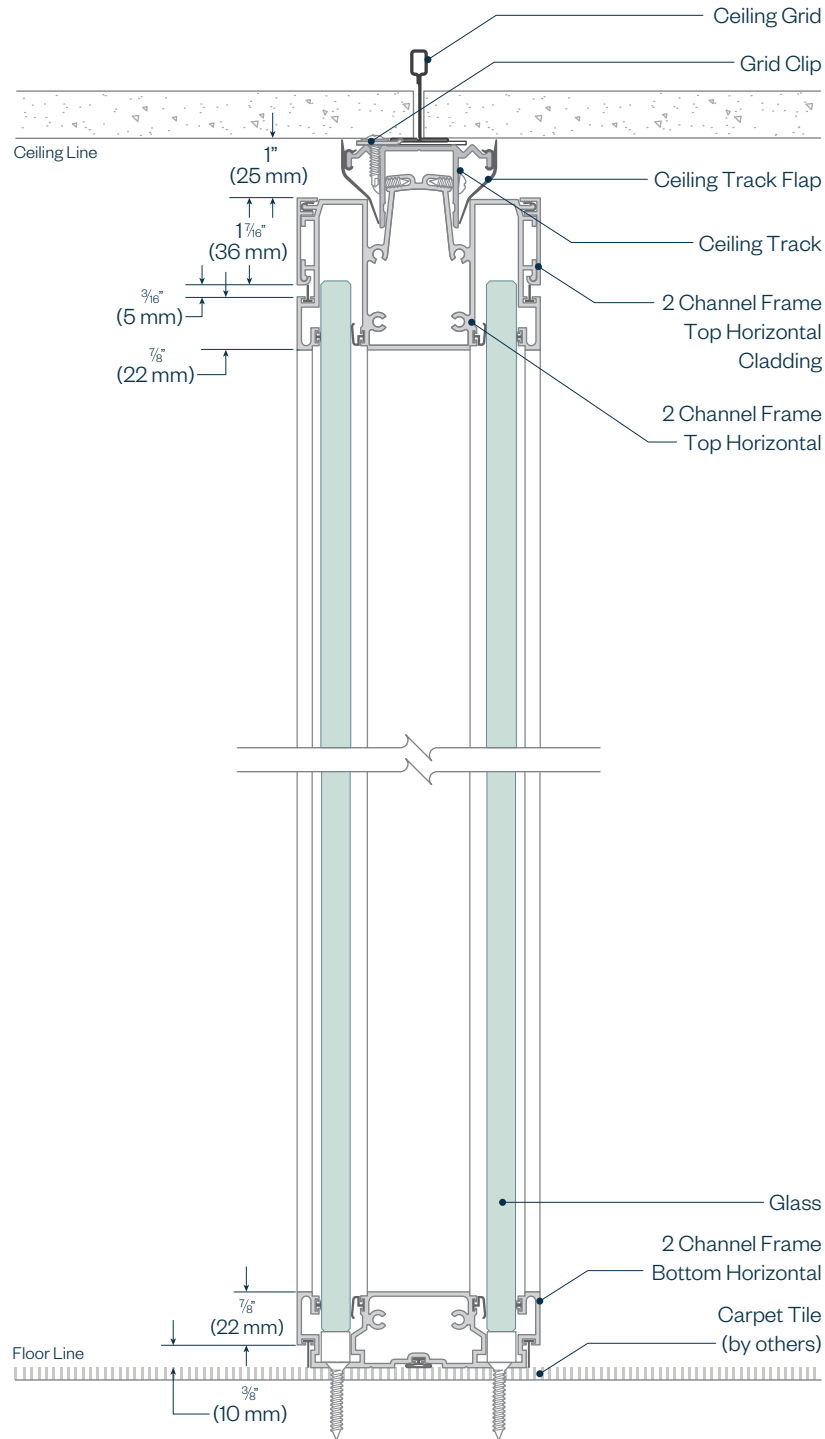

# Enclose & EFG Architectural Details

## 2 Channel Enclose Frameless Glass Offset Glazed

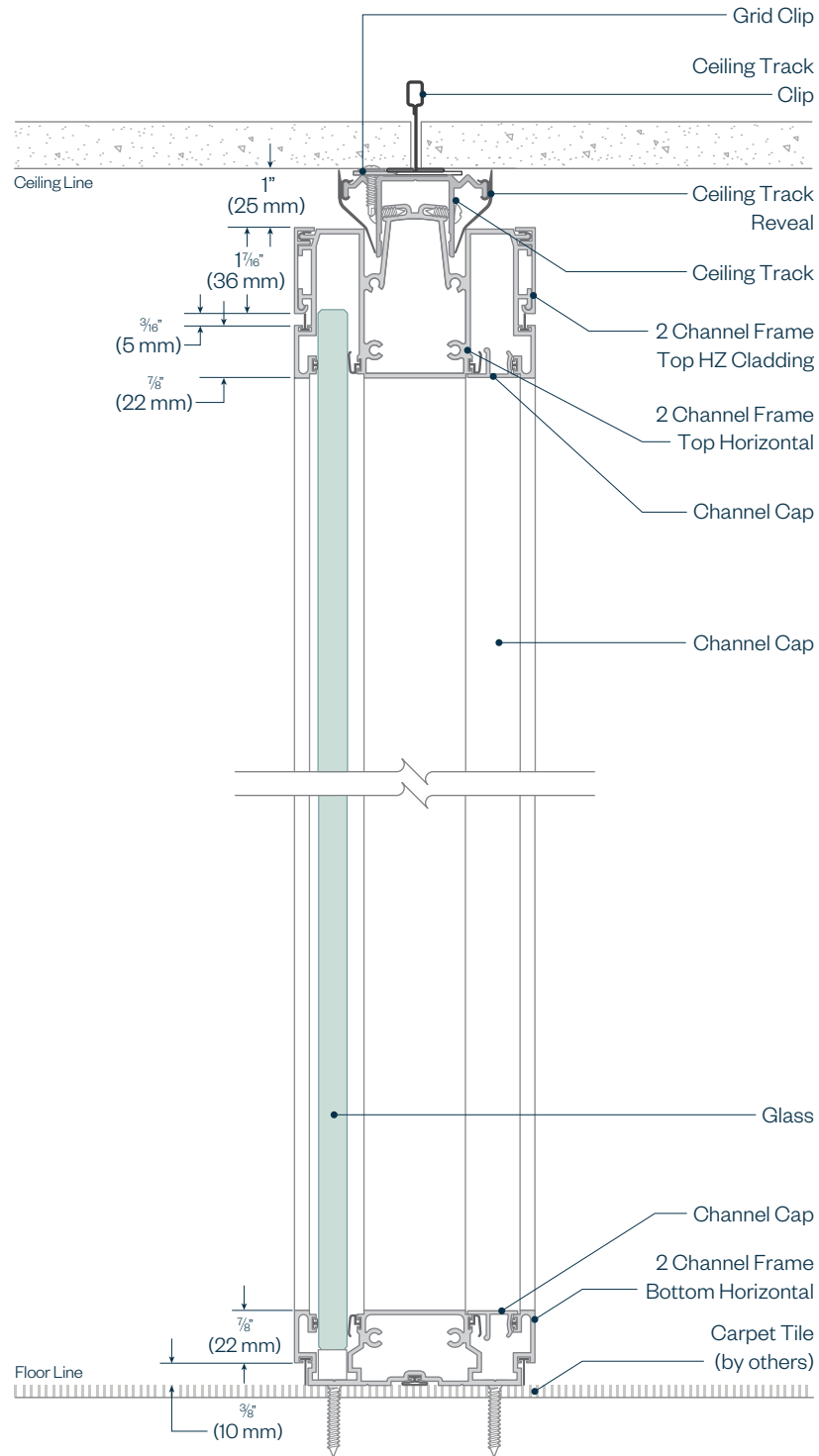

HAWORTH

# Enclose & EFG Architectural Details

## Enclose Frameless Glass

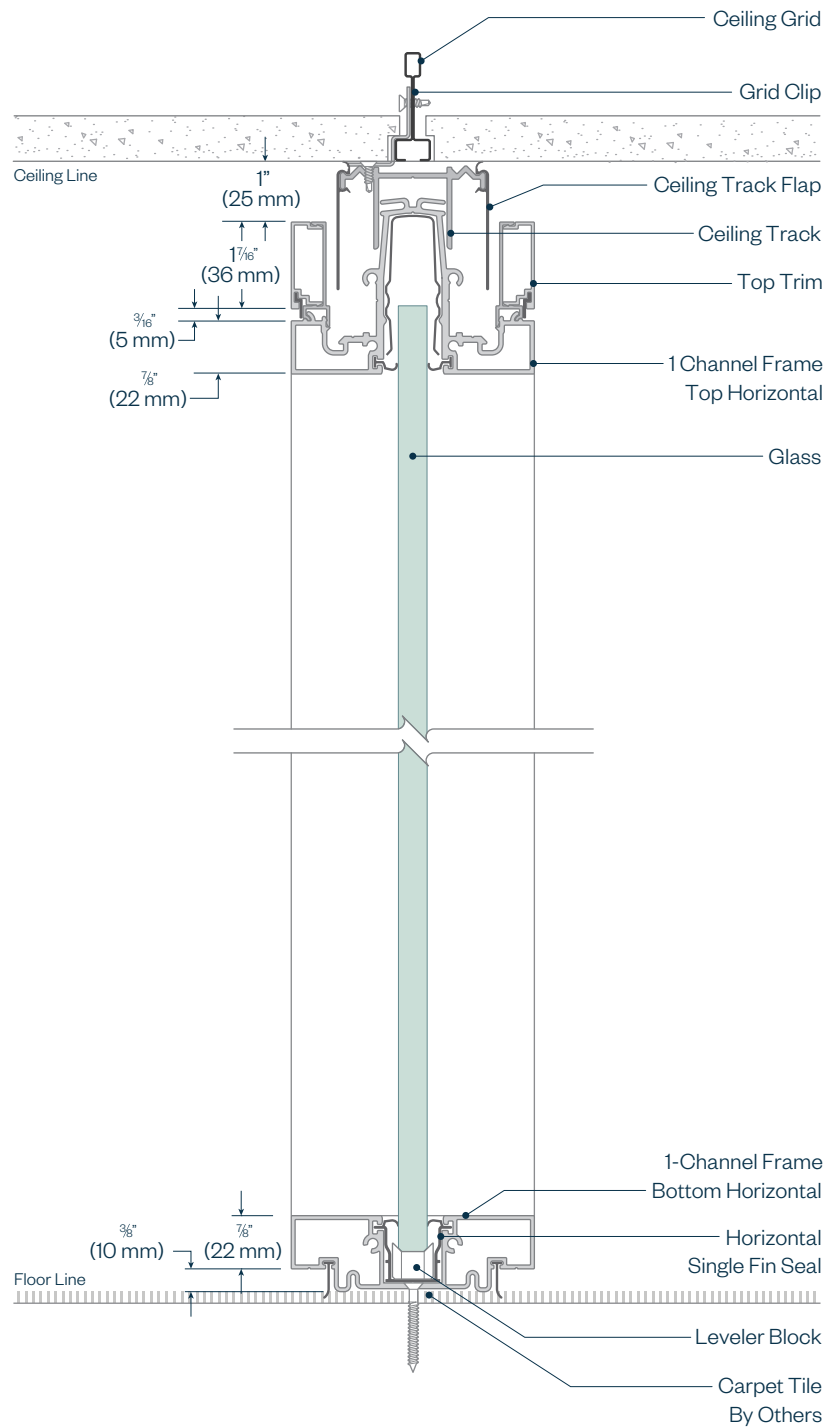

HAWORTH

# Enclose & EFG Architectural Details

## Enclose Frameless Glass Stack

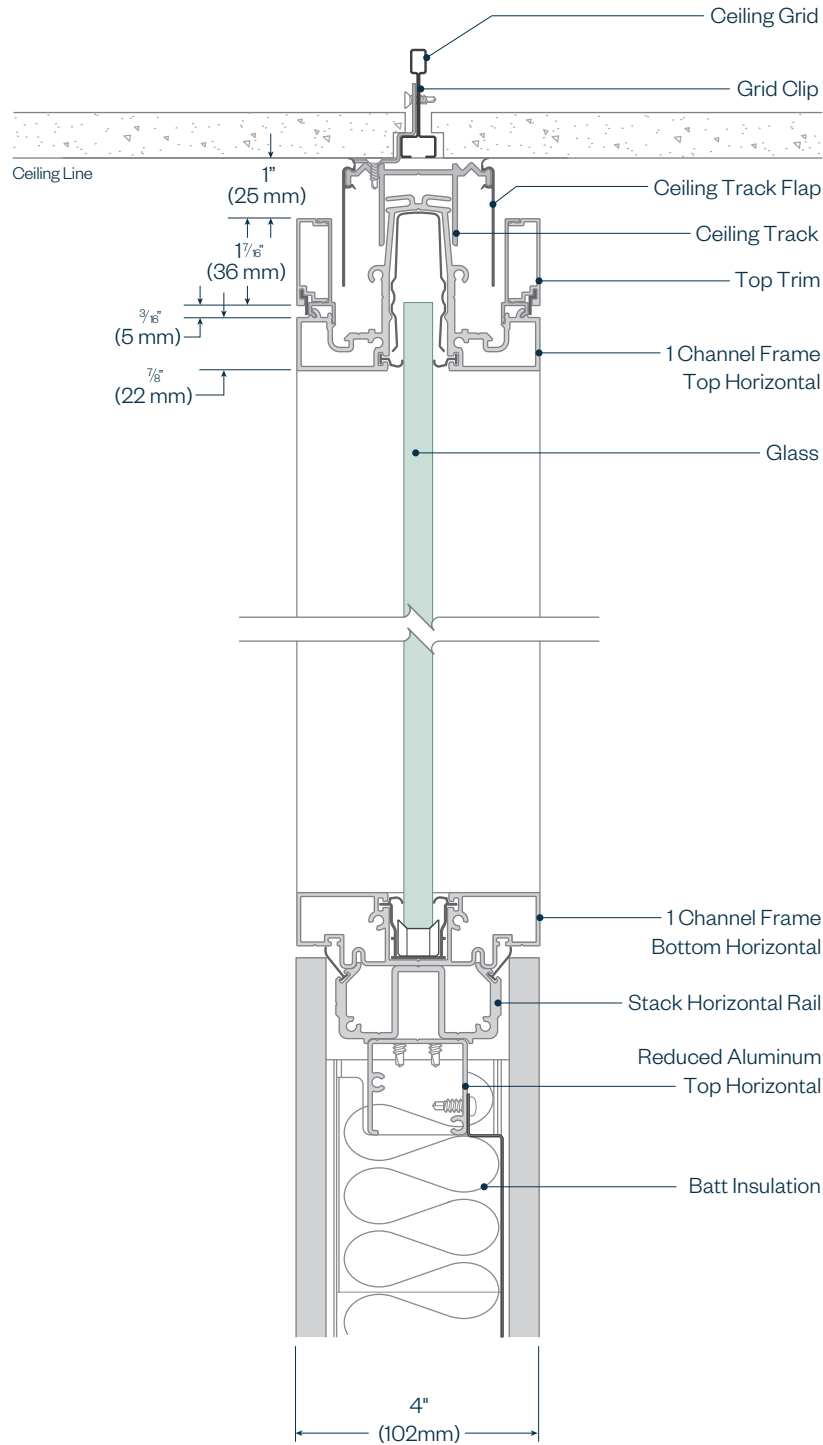

# Enclose & EFG Architectural Details

## Enclose Glass Panel

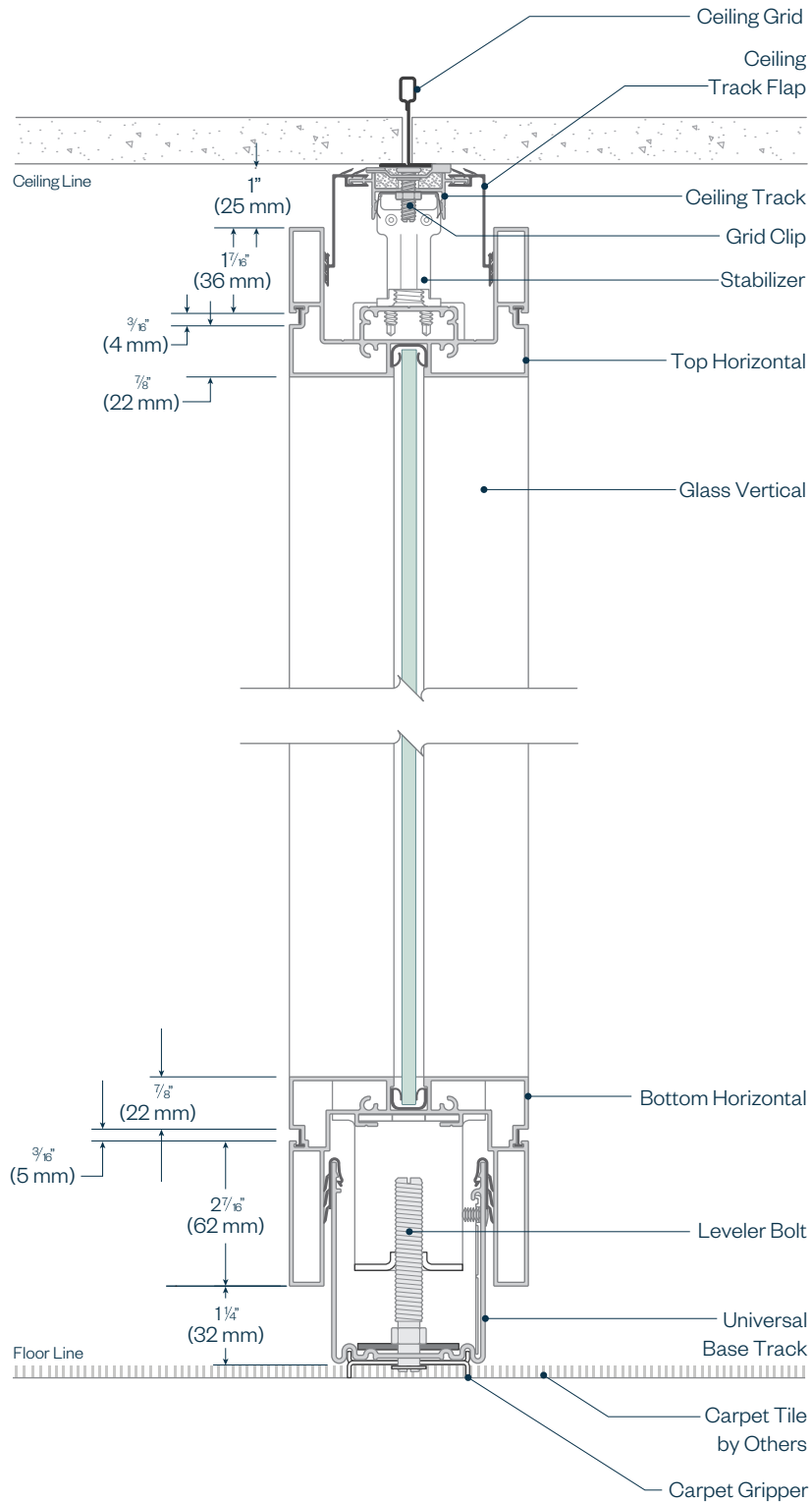

HAWORTH

# Enclose & EFG Architectural Details

## Enclose Solid Panel

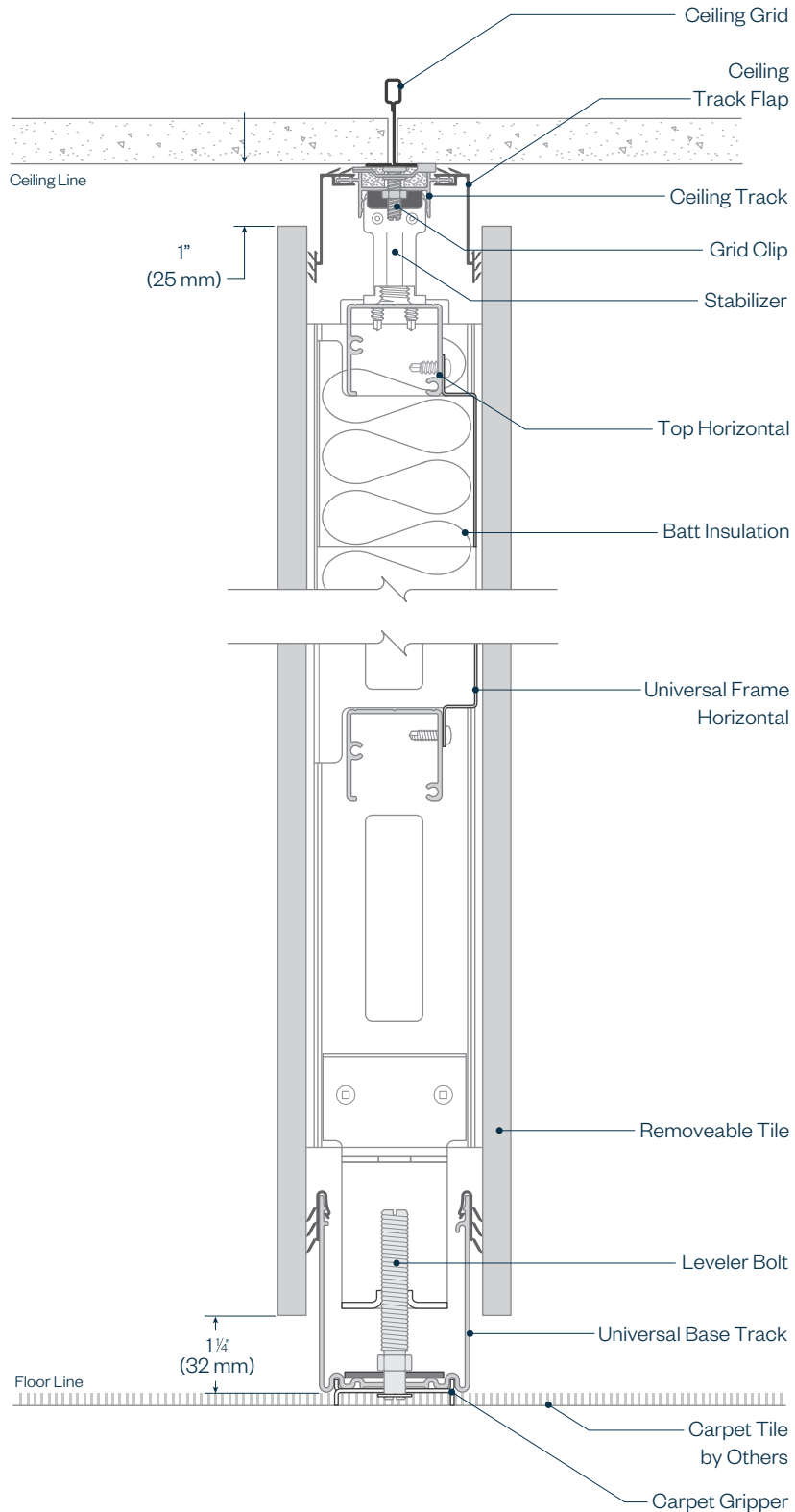



# Enclose & EFG Architectural Details

## Enclose Glass Panel with Muntins

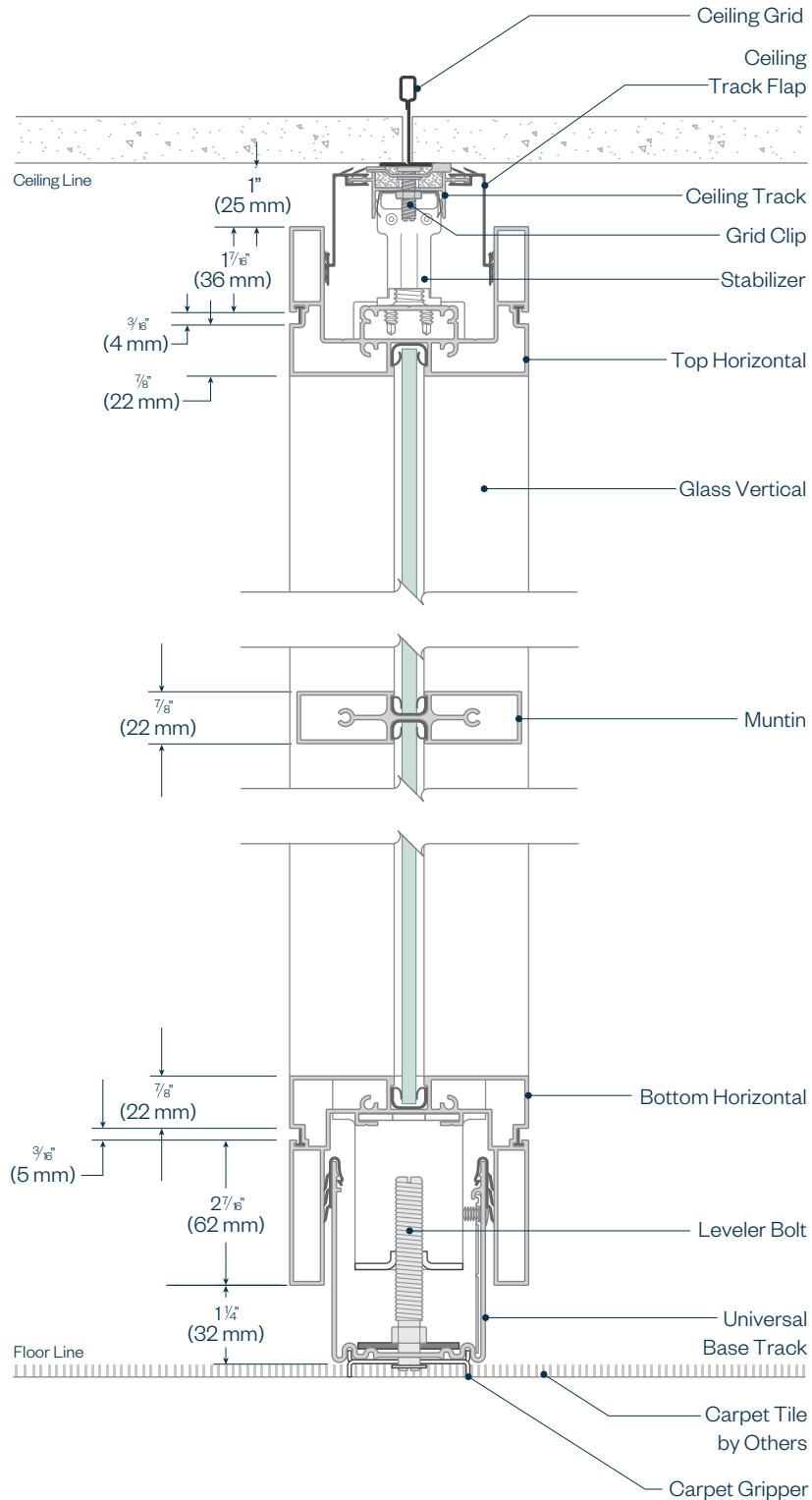

HAWORTH

# Enclose & EFG Architectural Details

## Enclose Clerestory

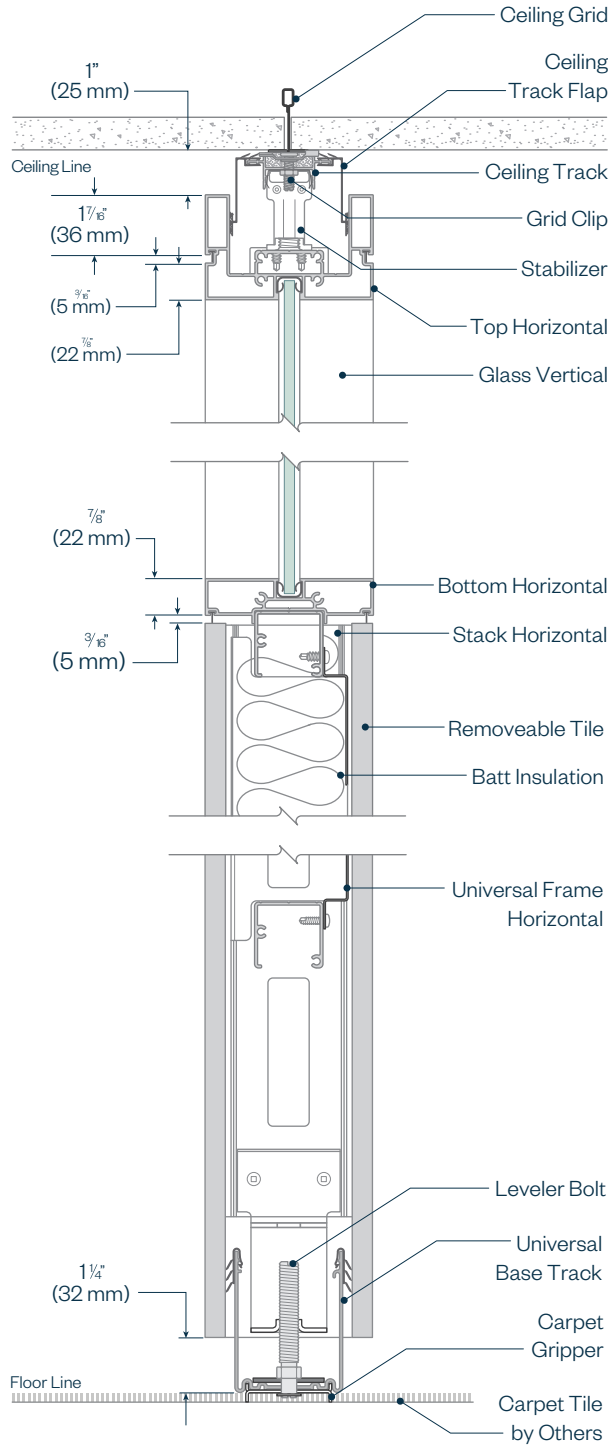

HAWORTH

# Enclose & EFG Architectural Details

## Enclose Combi Panel with Transom

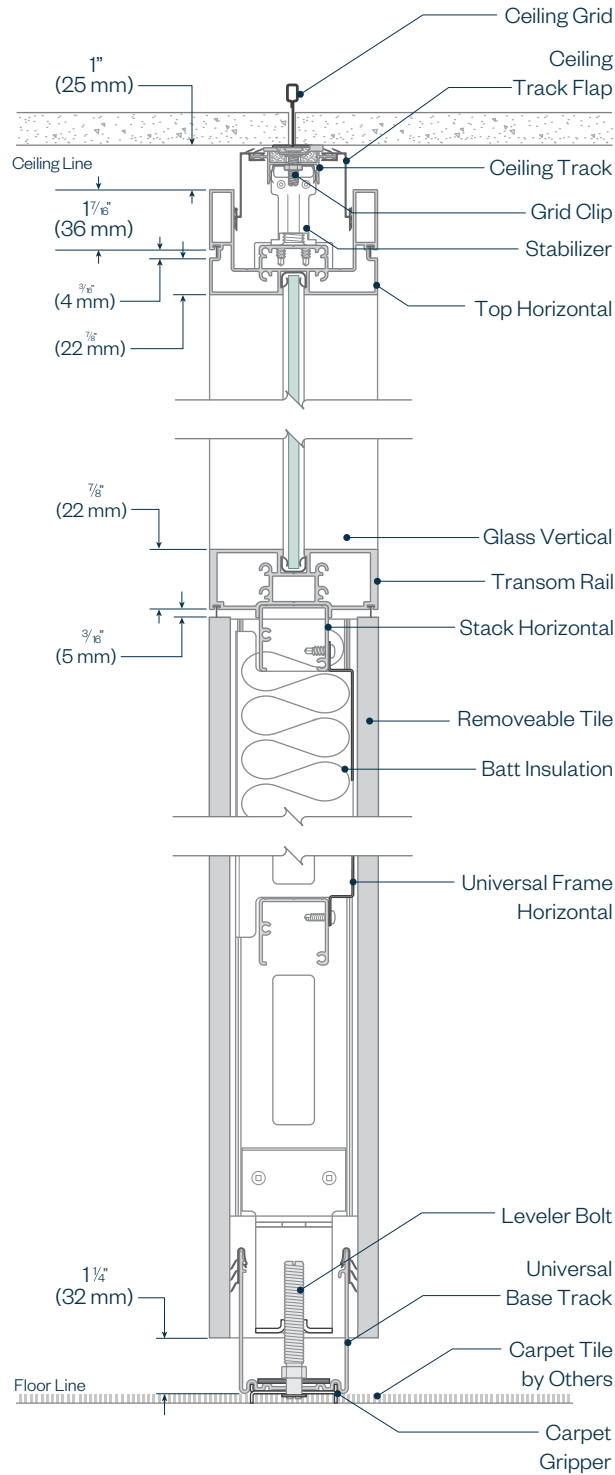

HAWORTH

# Enclose & EFG Architectural Details

## Enclose Glass Stack

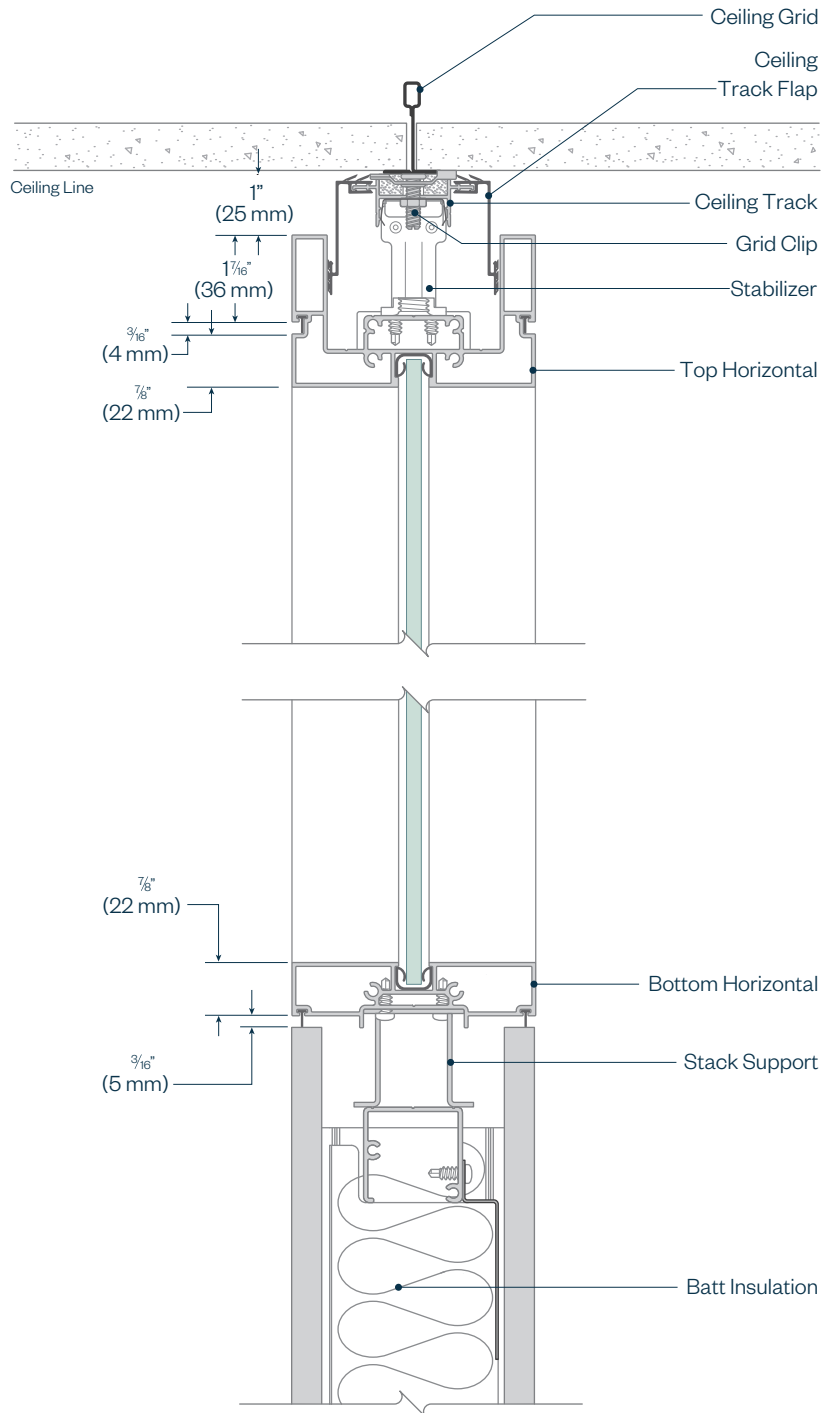

HAWORTH

# Enclose & EFG Architectural Details

## Enclose Solid Stack

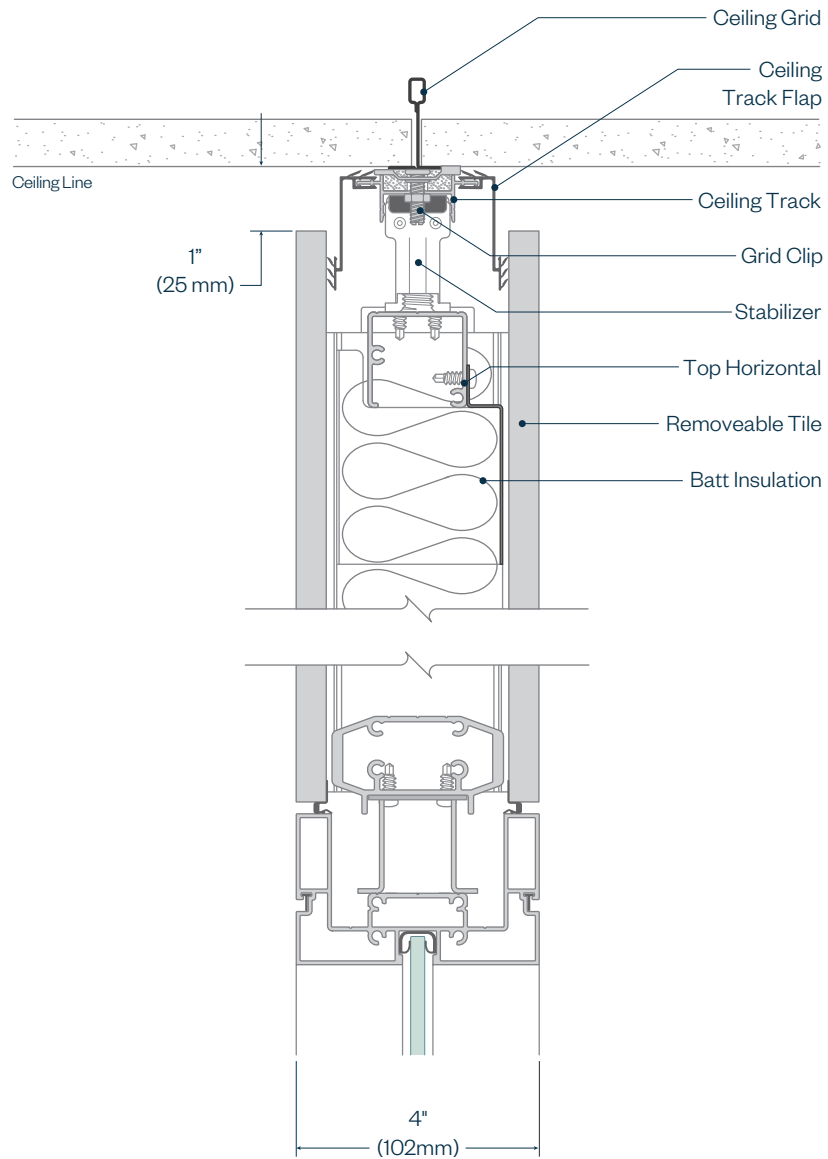

HAWORTH

# Enclose & EFG Architectural Details

## Enclose Frameless Glass Double Glazed Pivot Door

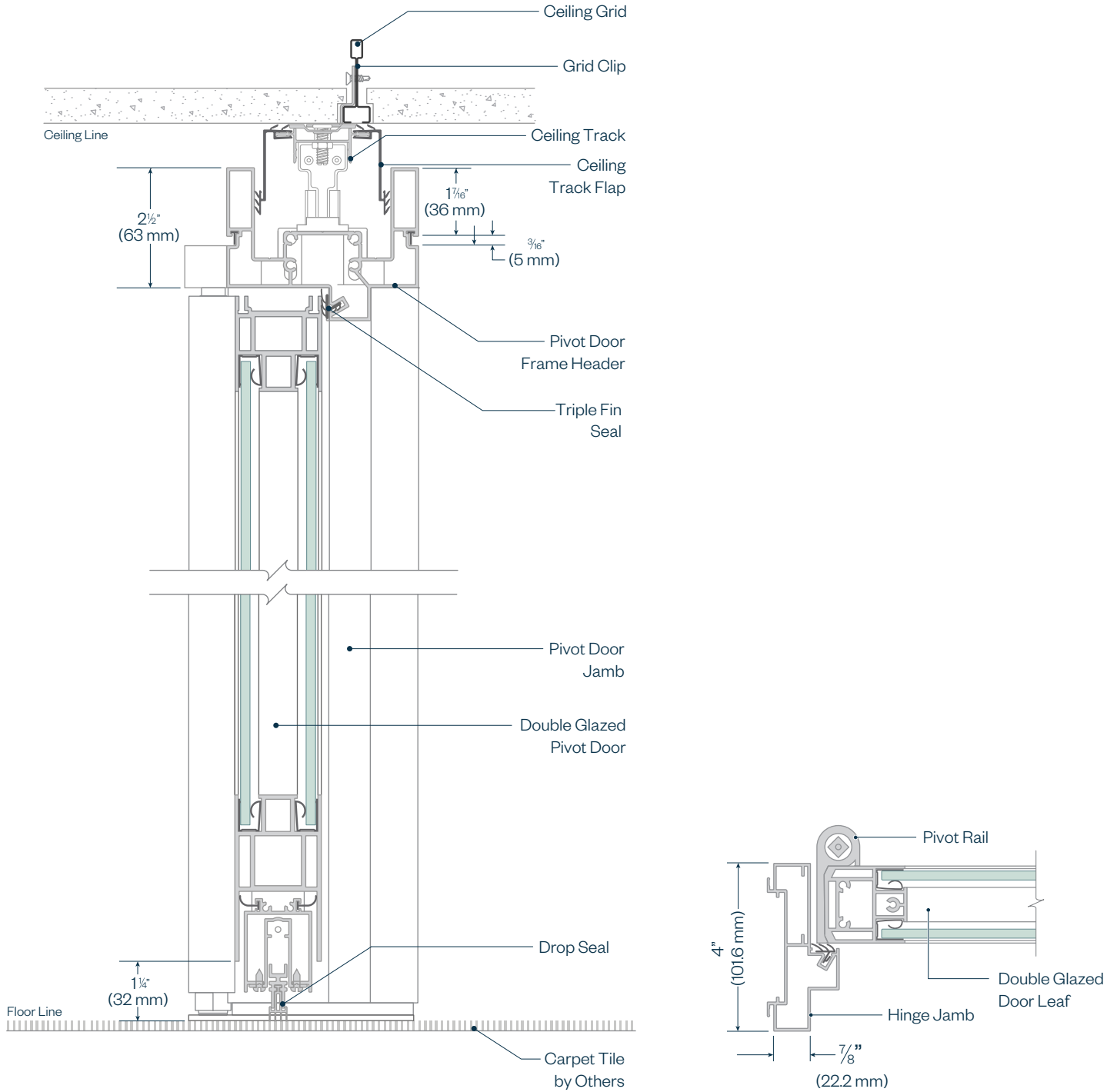

HAWORTH

# Enclose & EFG Architectural Details

## Enclose Frameless Glass Slab Sliding Door

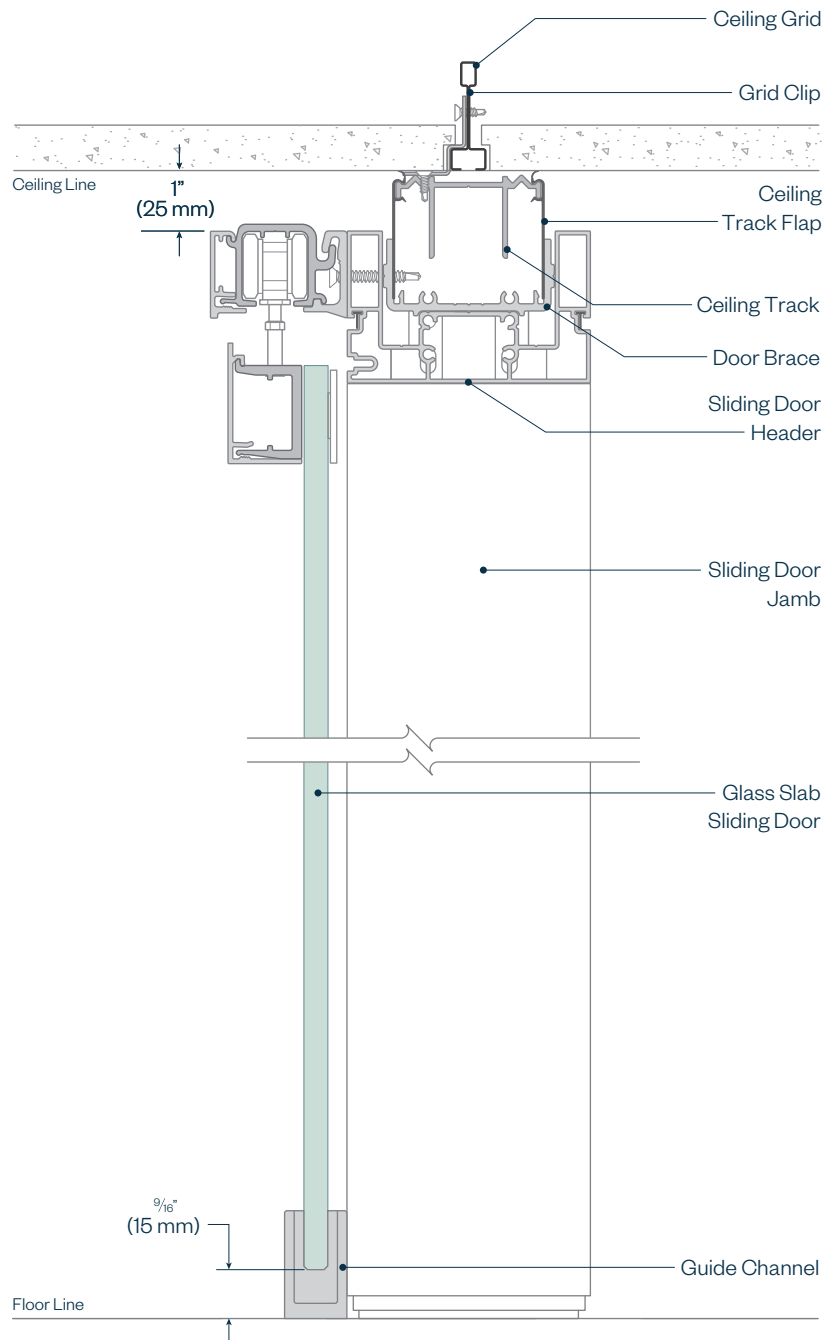

HAWORTH

# Enclose & EFG Architectural Details

## Enclose Frameless Glass Slab Pivot Door

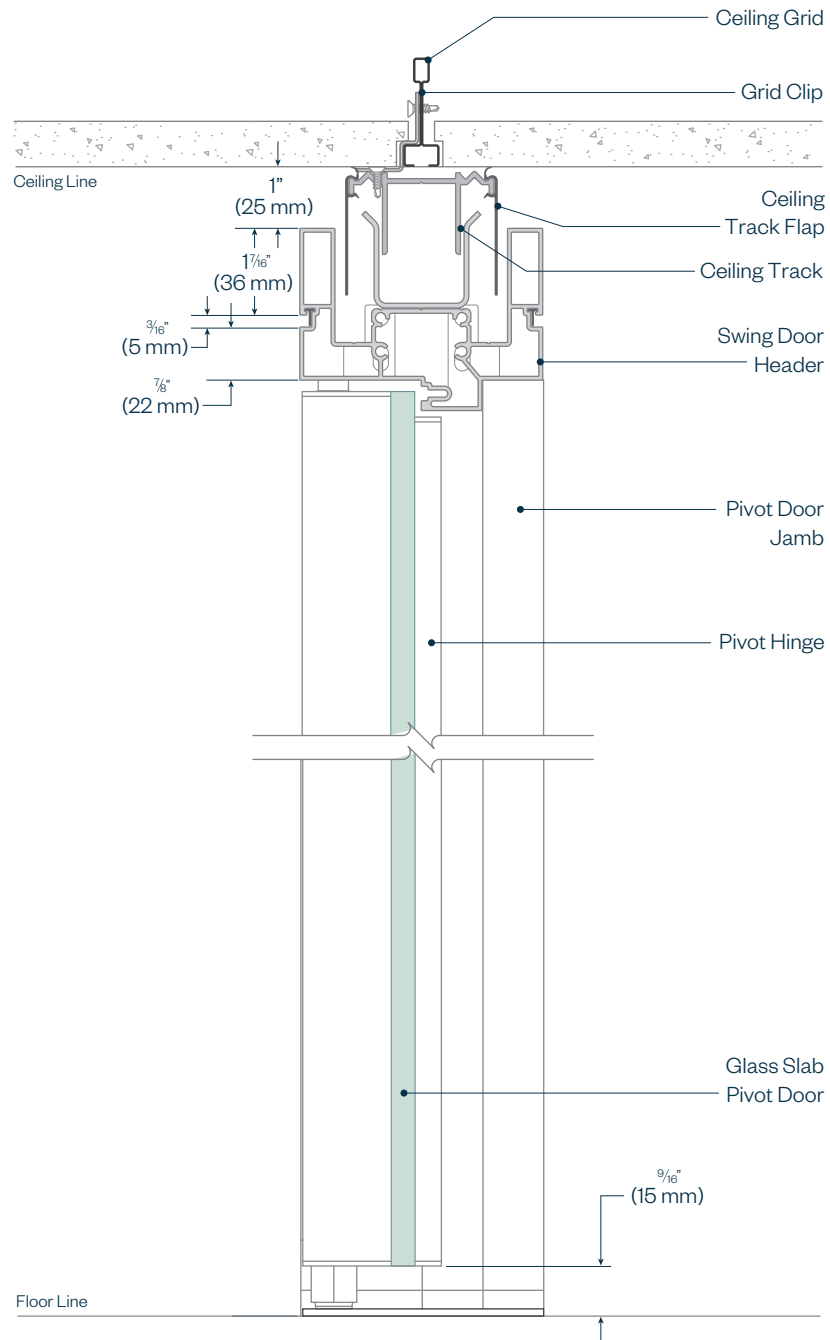



HAWORTH

# Enclose & EFG Architectural Details

## Enclose Frameless Glass Aluminum Glazed Sliding Door

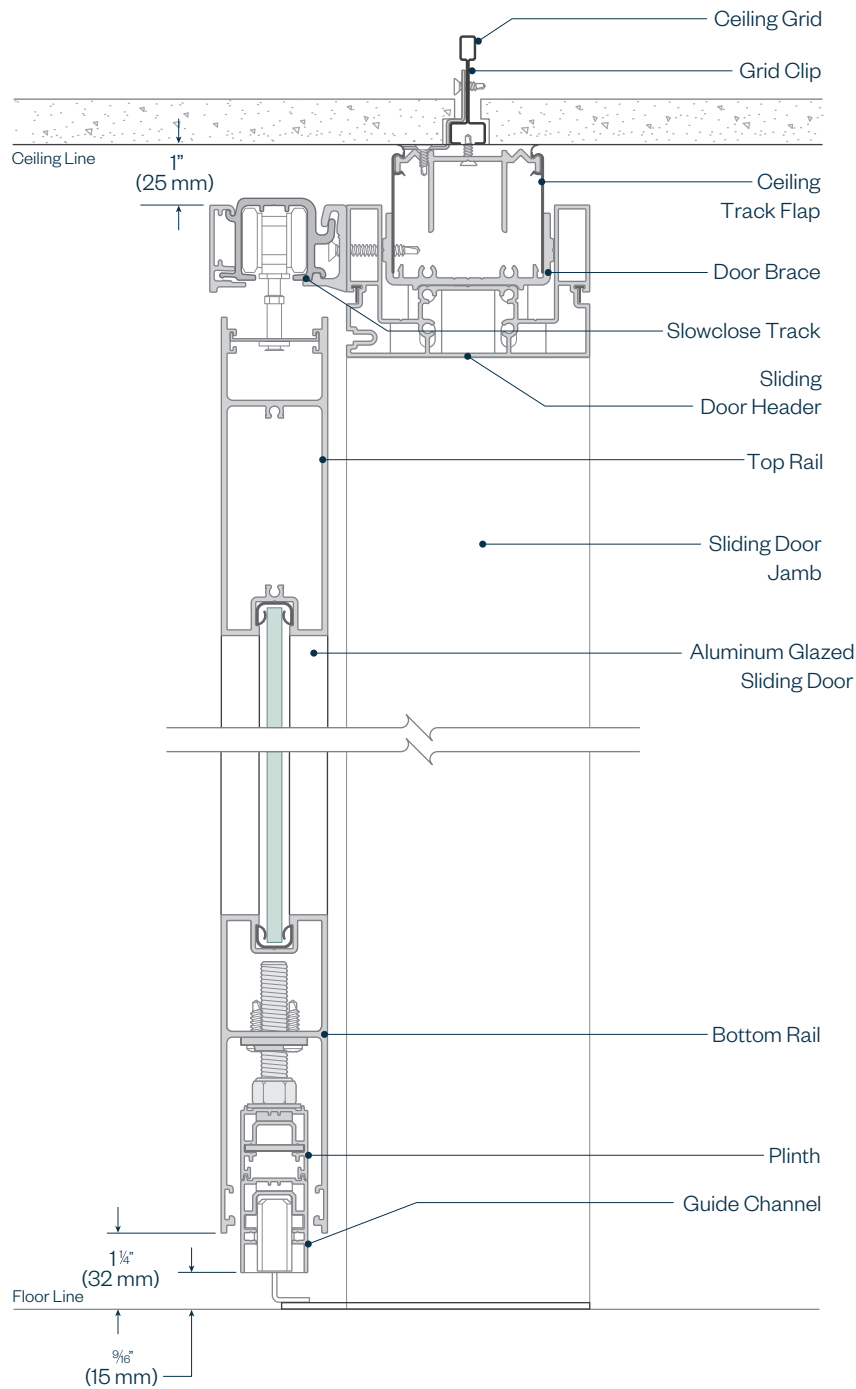

HAWORTH

# Enclose & EFG Architectural Details

## Enclose Frameless Glass Aluminum Glazed Butt-Hinge Door

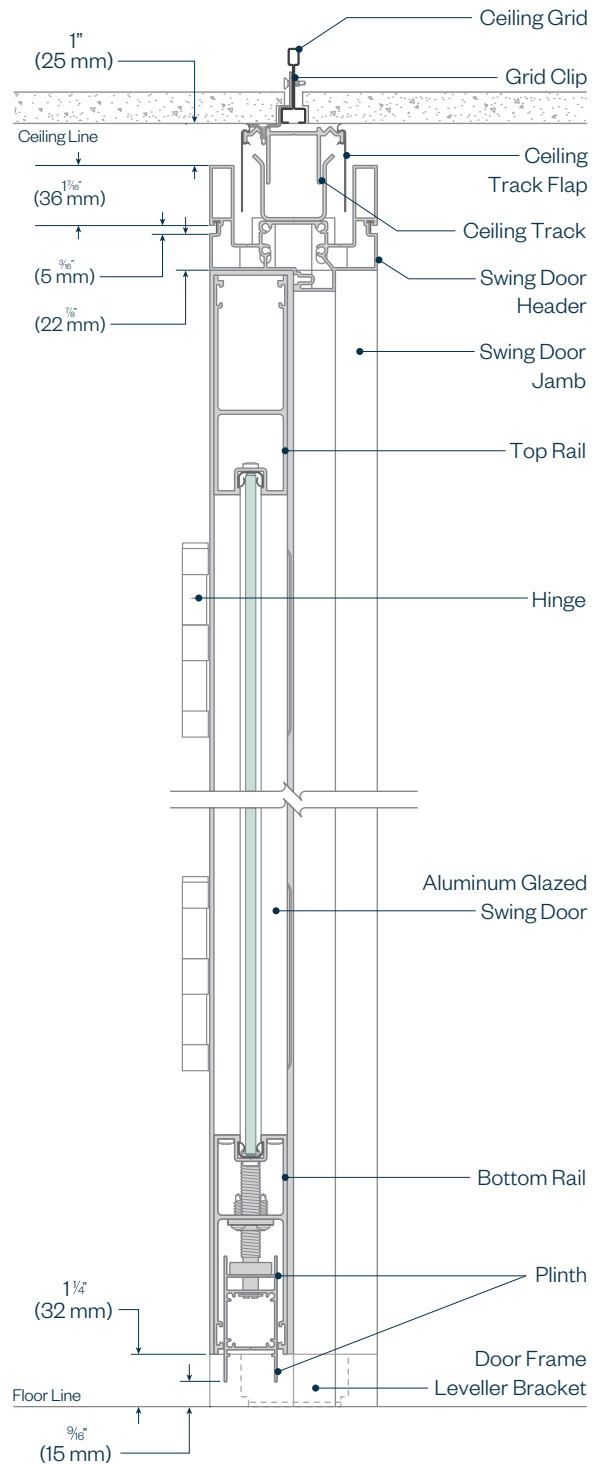

HAWORTH

# Enclose & EFG Architectural Details

## Enclose Glass Slab Sliding Door

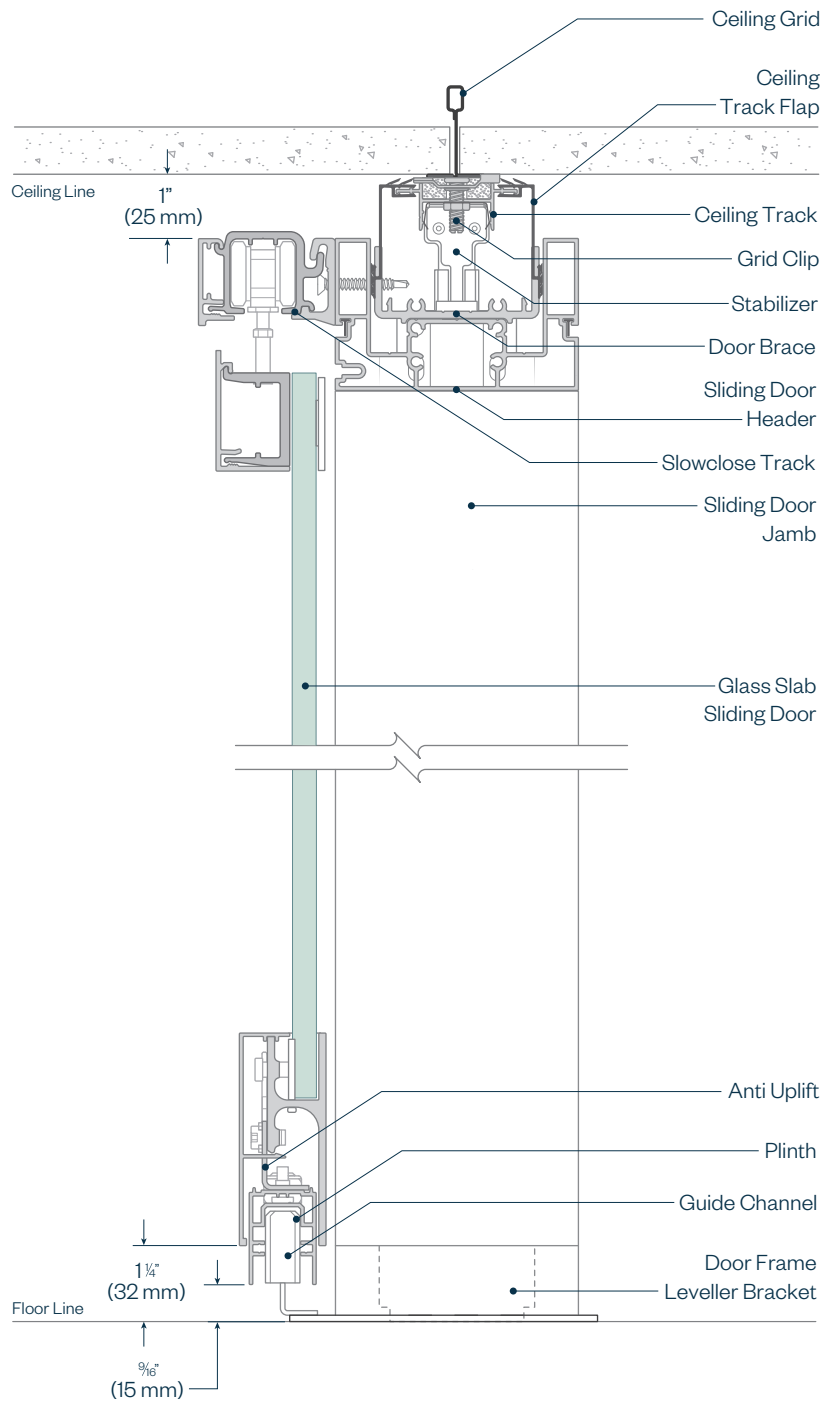

HAWORTH

# Enclose & EFG Architectural Details

## Enclose Glass Slab Pivot Door

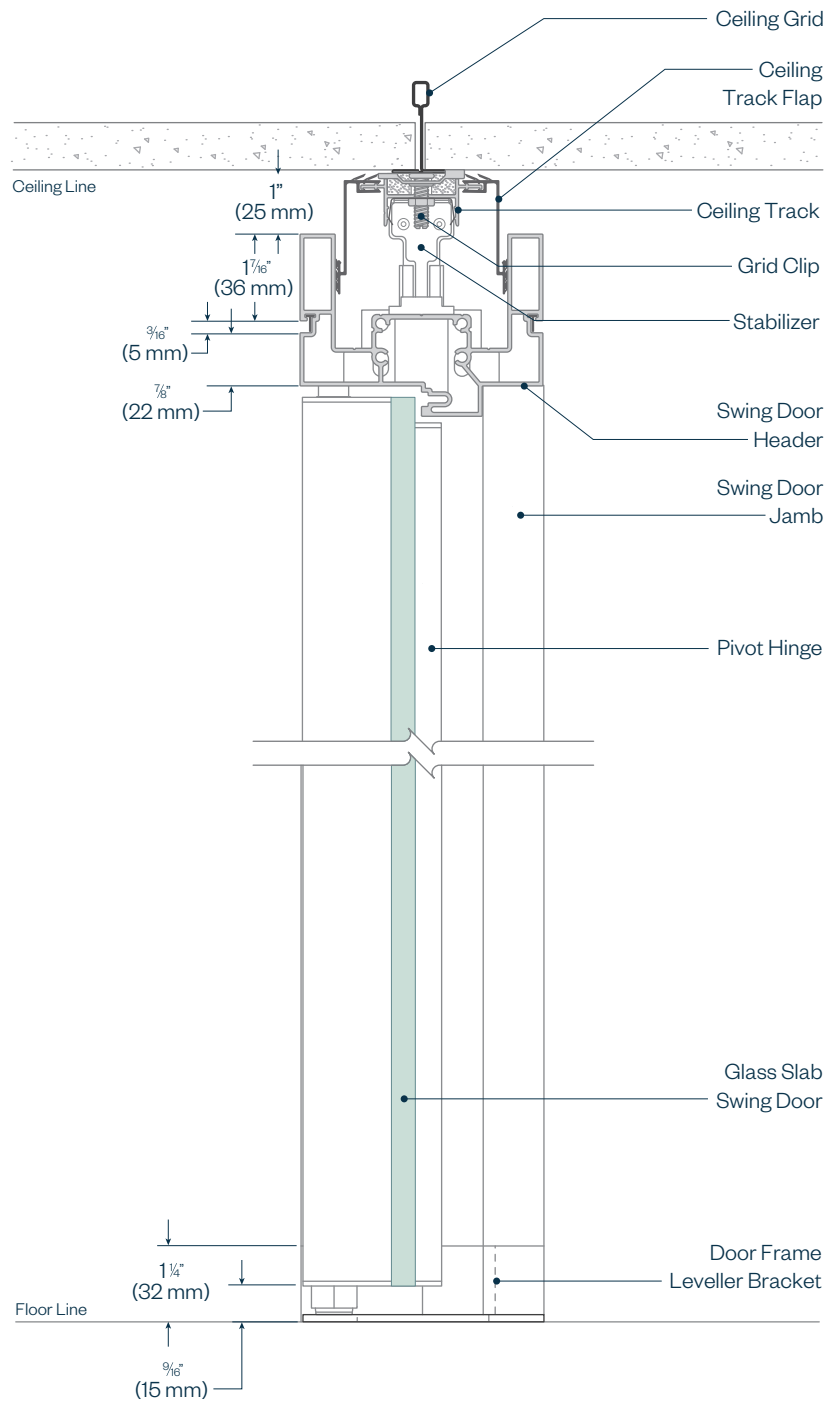

HAWORTH

# Enclose & EFG Architectural Details

## Enclose Aluminum Glazed Sliding Door

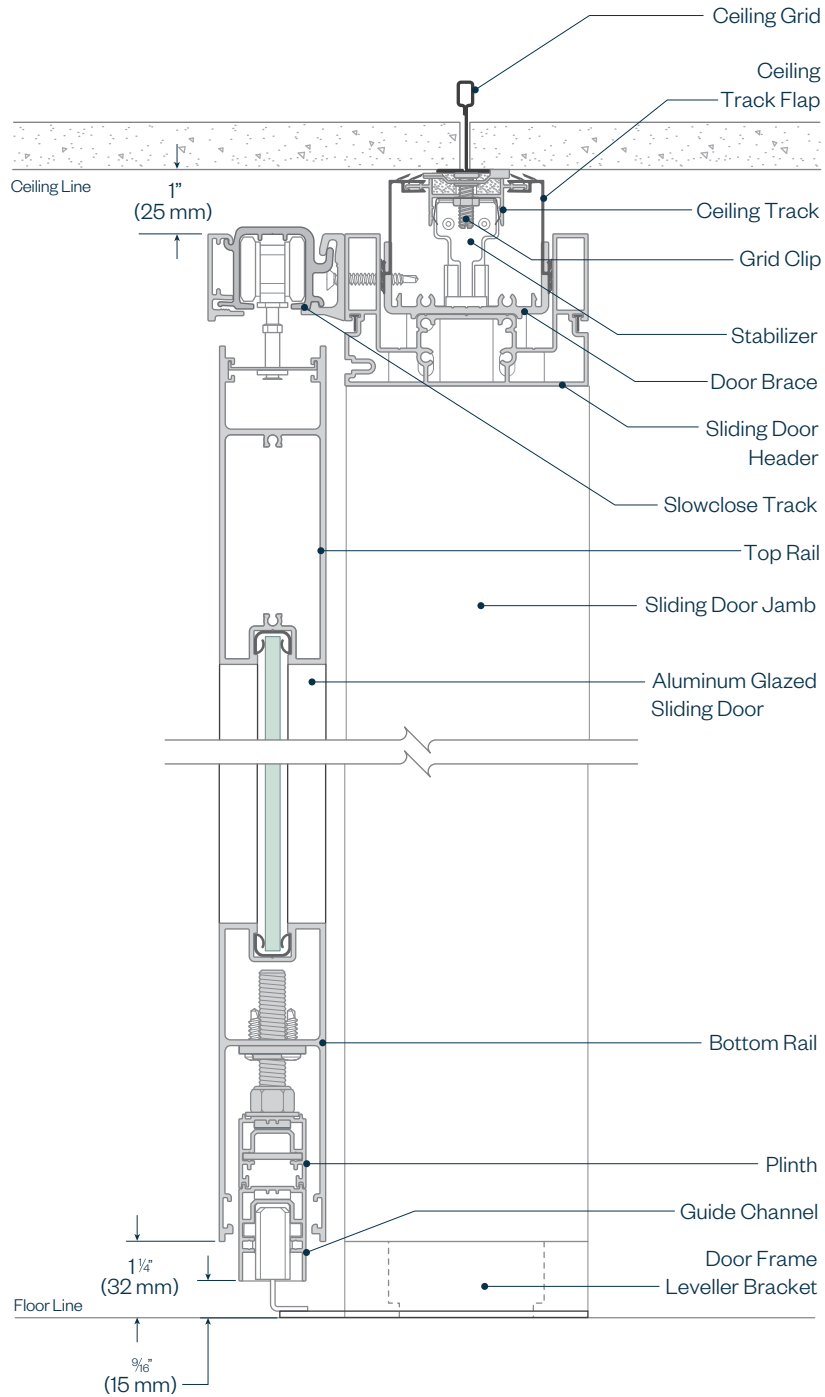

HAWORTH

# Enclose & EFG Architectural Details

## Enclose Aluminum Glazed Butt-Hinge Door

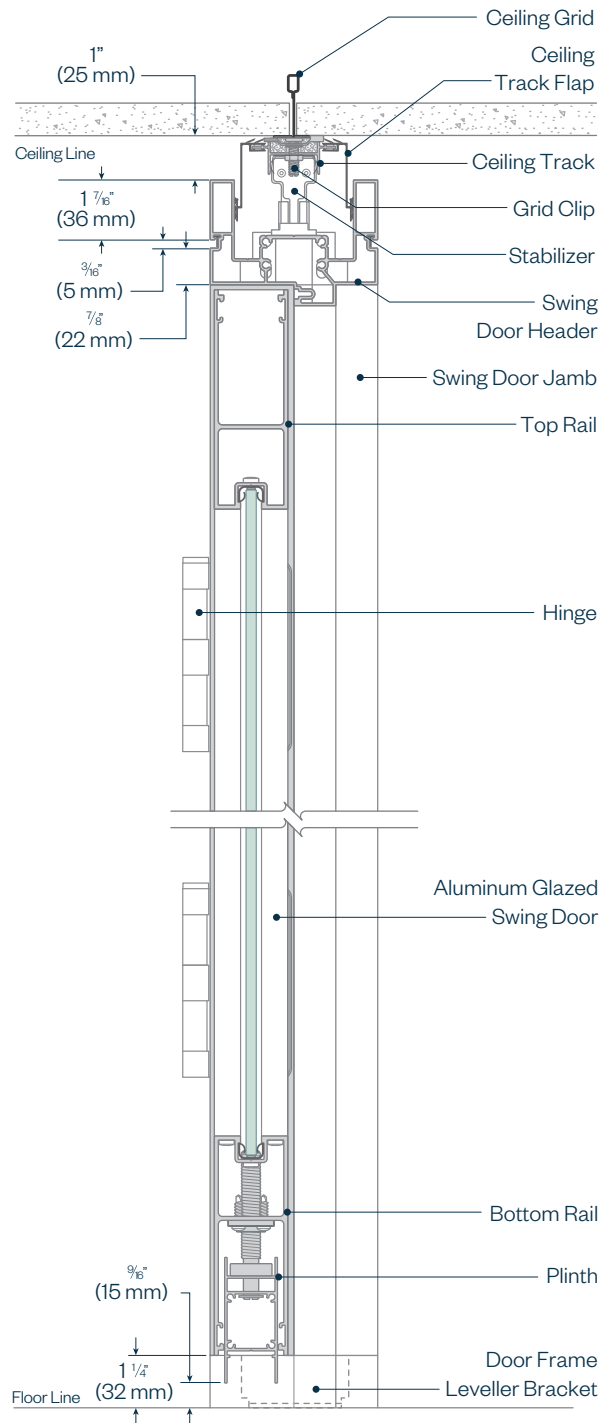

HAWORTH

# Enclose & EFG Architectural Details

## Enclose Wood Butt-Hinge Door

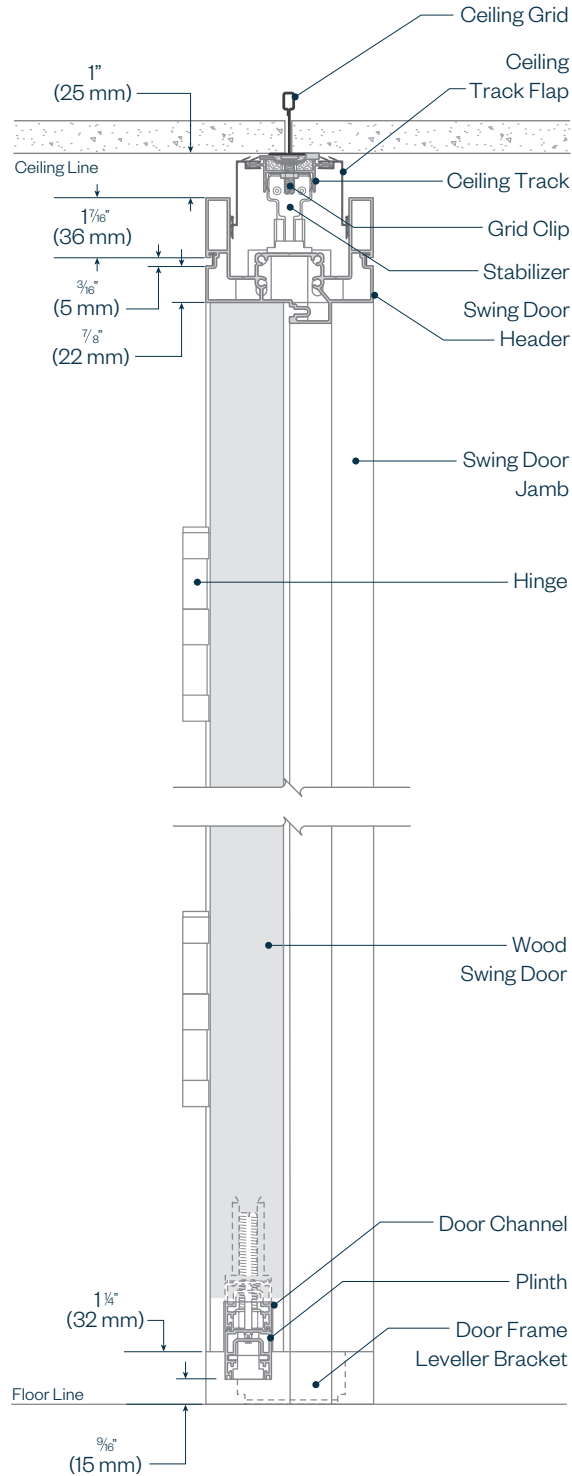

# Enclose & EFG Architectural Details

## Enclose Glass Slab Pivot Door with Glass Transom

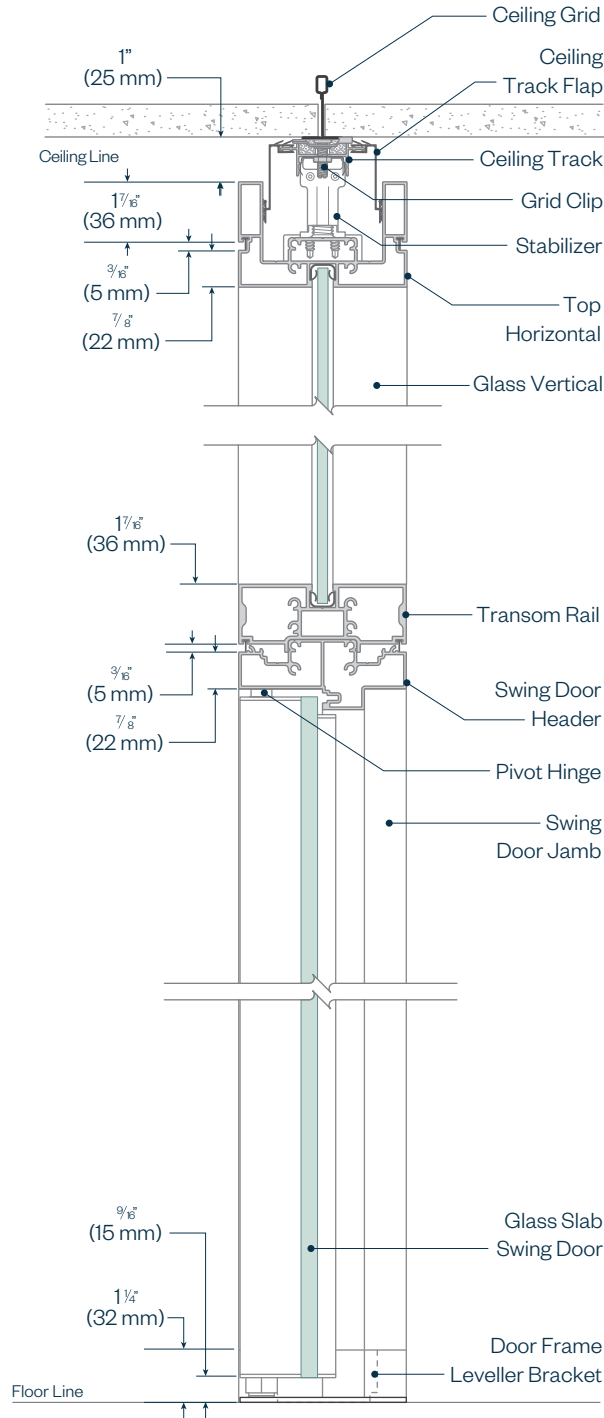



HAWORTH

# Enclose & EFG Architectural Details

Starter - Compressible 2 Channel Enclose Frameless Glass

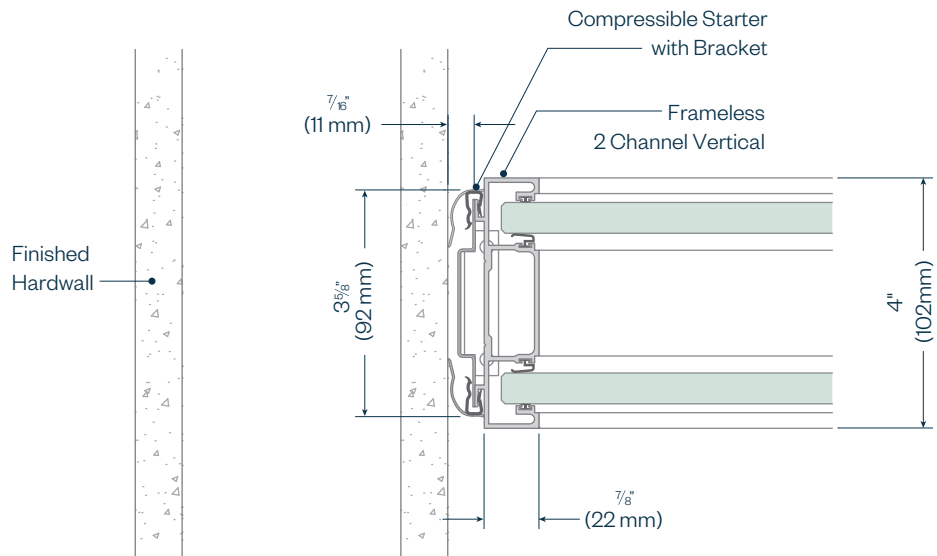

HAWORTH

# Enclose & EFG Architectural Details

Starter - Compressible Enclose Frameless Glass

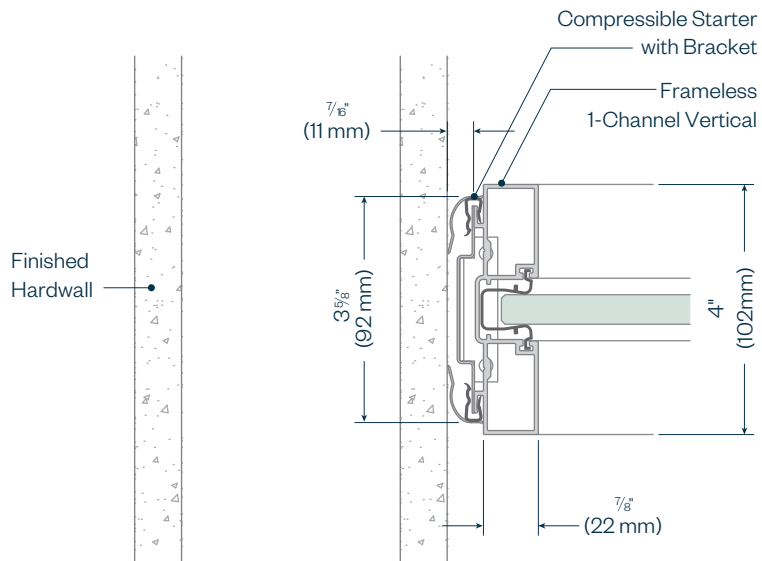

HAWORTH

# Enclose & EFG Architectural Details

Starter - Compressible Enclose Glass

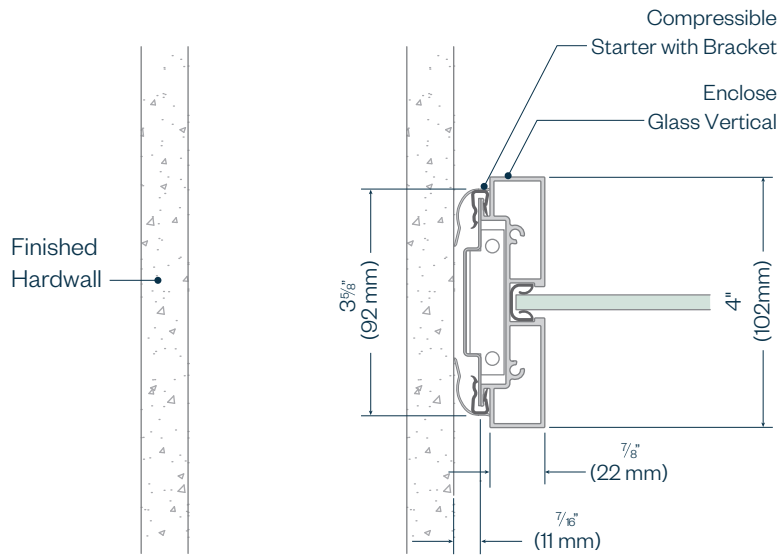

HAWORTH

# Enclose & EFG Architectural Details

Starter - Compressible Enclose Solid

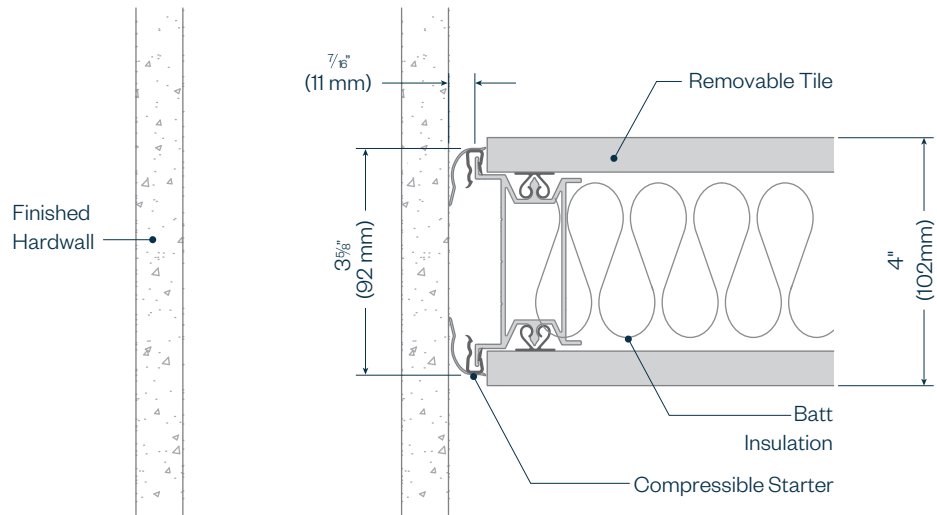

HAWORTH

# Enclose & EFG Architectural Details

Starter - Low Profile

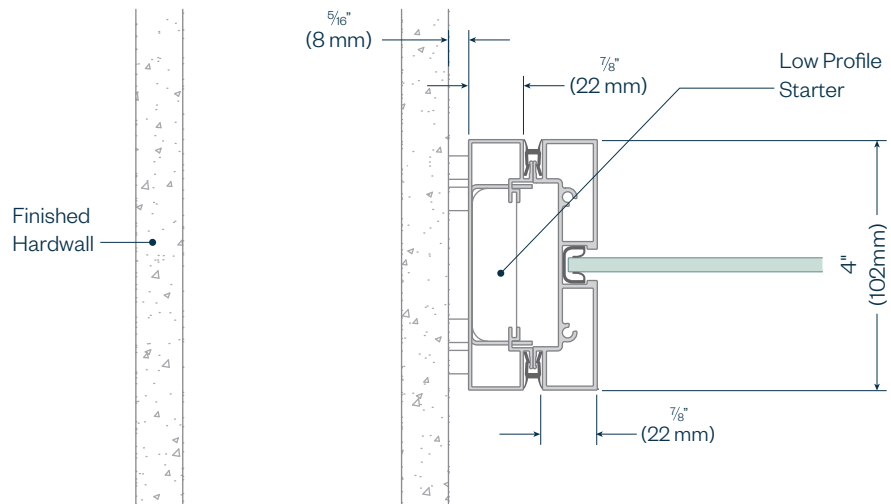

HAWORTH

# Enclose & EFG Architectural Details

Starter - Adjustable

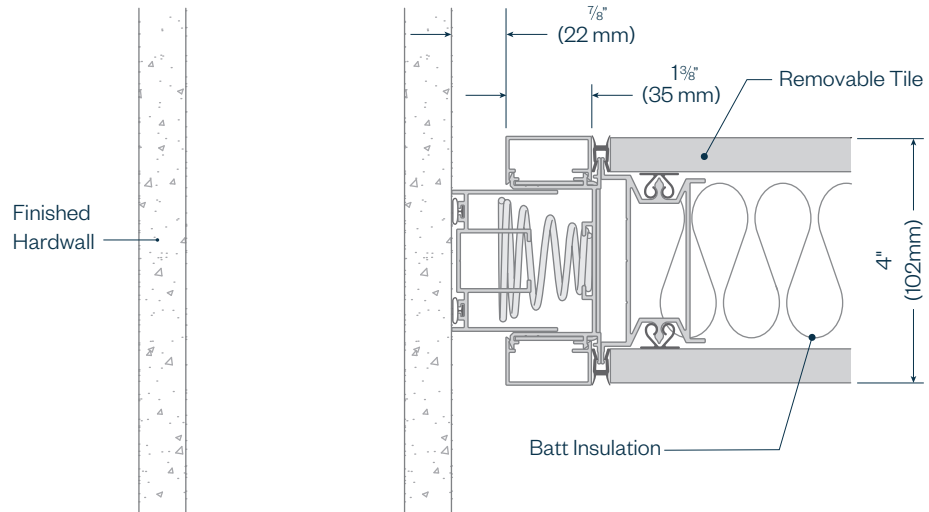

HAWORTH

# Enclose & EFG Architectural Details

## Starter - Enclose Cuttable

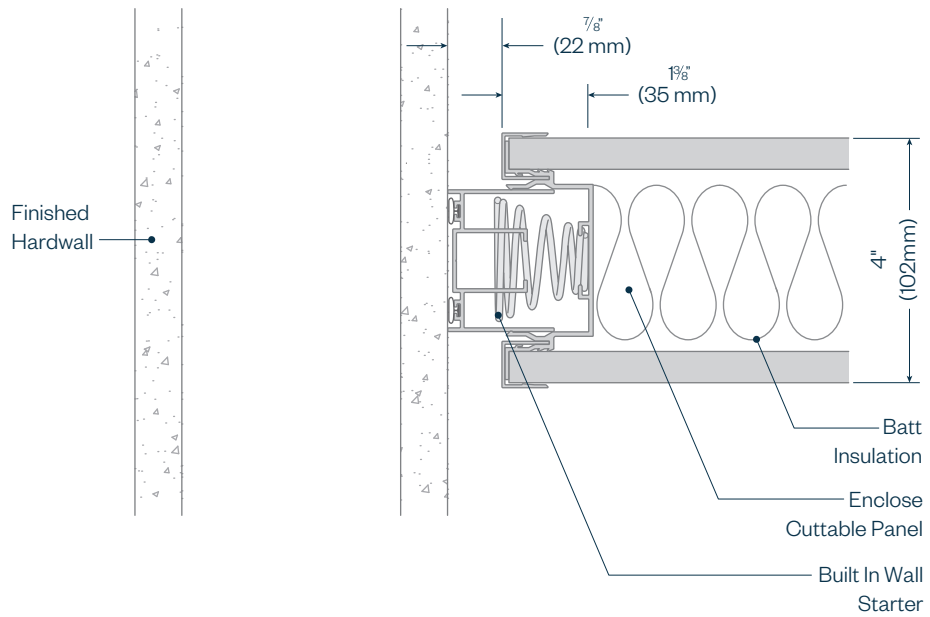

# Enclose & EFG Architectural Details

## Starter - Mullion Expandable Cladding

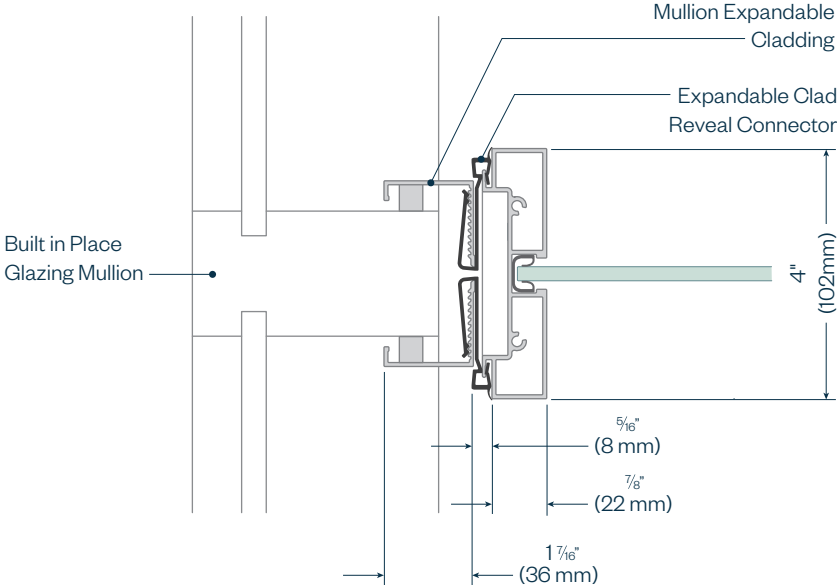



HAWORTH

# Enclose & EFG Architectural Details

## Starter - Hardwall Expandable Cladding

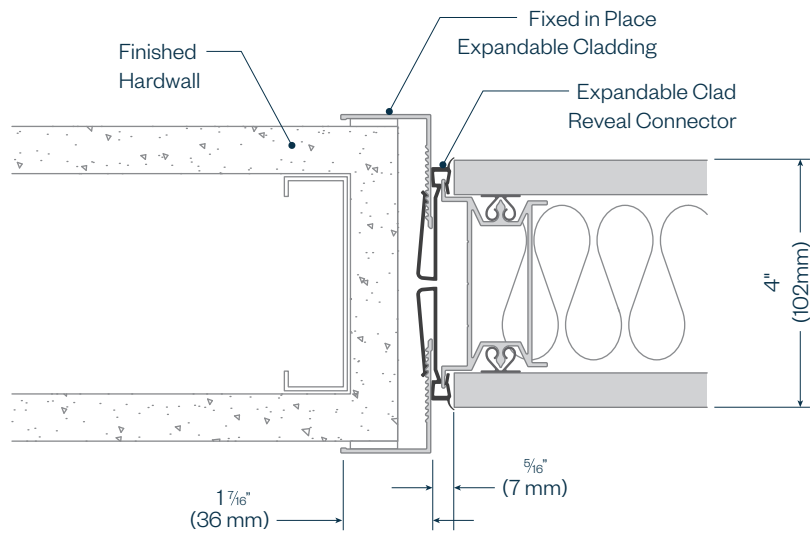

HAWORTH

# Enclose & EFG Architectural Details

Starter - Center Chamfer

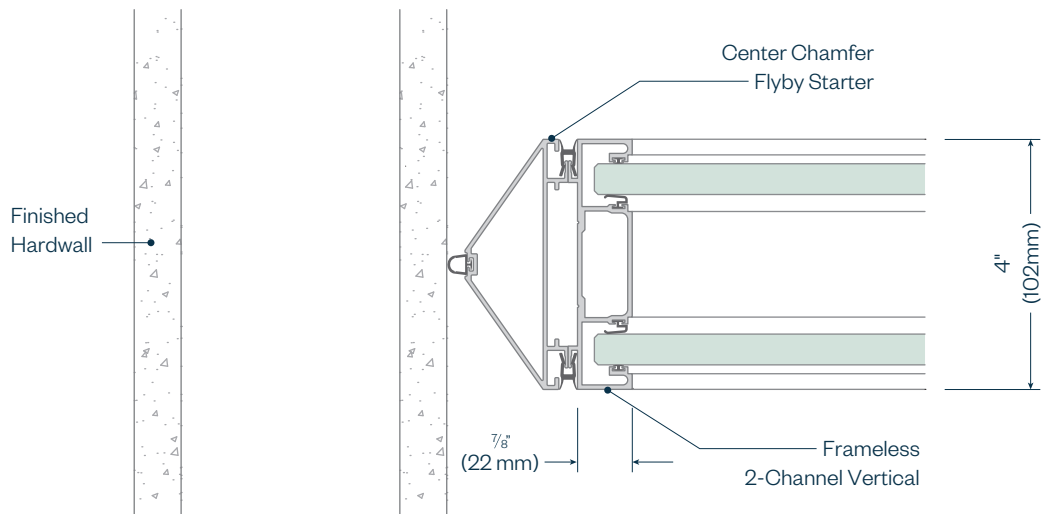

HAWORTH

# Enclose & EFG Architectural Details

Starter - Flush Flyby

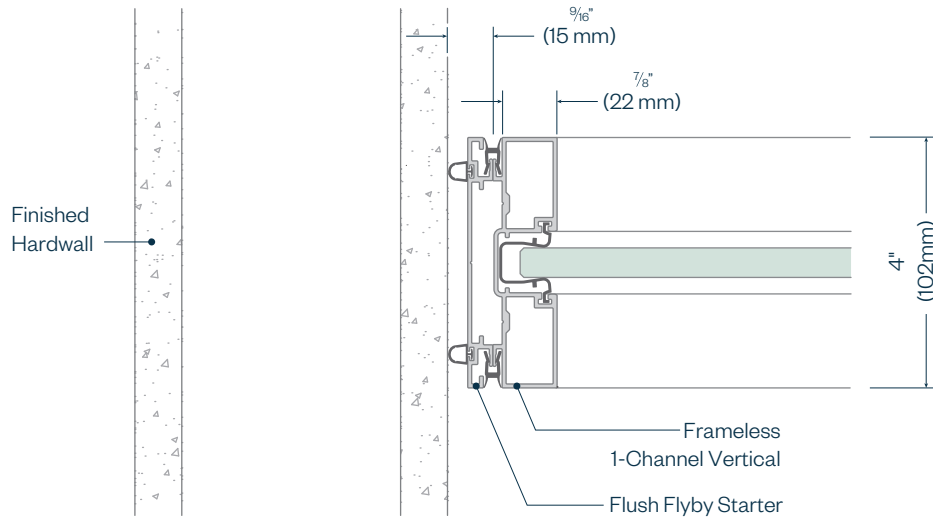

HAWORTH

# Enclose & EFG Architectural Details

## Enclose Frameless Glass Ceiling Connection - Tile

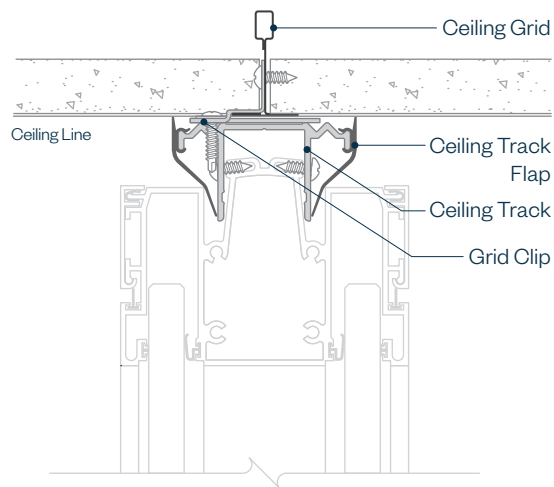

Recommended minimum detail only-  
to be confirmed and accepted by the  
professional of record for each  
application and site

Base building construction must be in  
accordance to local site building  
code requirements

HAWORTH

# Enclose & EFG Architectural Details

## Enclose Frameless Glass Ceiling Connection - Drywall

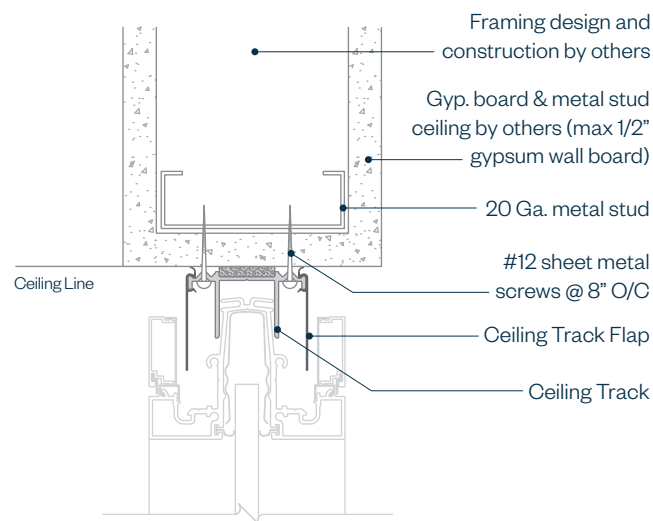

Recommended minimum detail only - to be confirmed and accepted by the professional of record for each application and site

Base building construction must be in accordance to local site building code requirements

HAWORTH

# Enclose & EFG Architectural Details

## Enclose Ceiling Connection - Tile

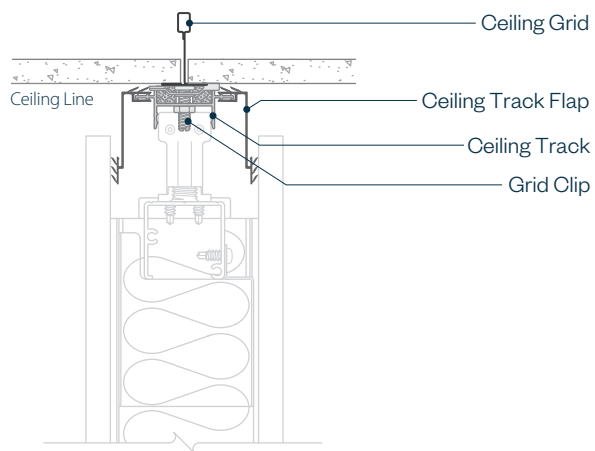

Recommended minimum detail only -  
to be confirmed and accepted by the  
professional of record for each  
application and site

Base building construction must be in  
accordance to local site building  
code requirements

# Enclose & EFG Architectural Details

## Enclose Ceiling Connection - Drywall

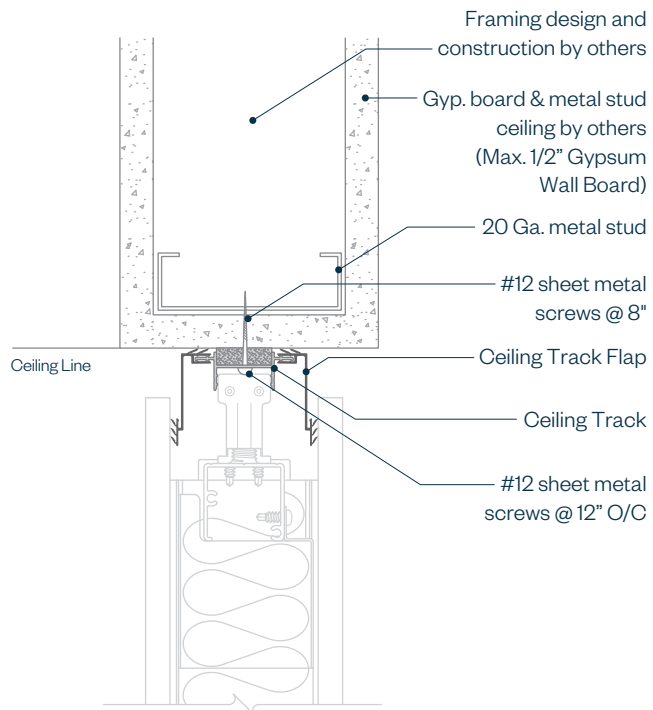

Recommended minimum detail only - to be confirmed and accepted by the professional of record for each application and site

Base building construction must be in accordance to local site building code requirements

HAWORTH

# Enclose & EFG Architectural Details

## 2 Channel Enclose Frameless Glass Floor Connection

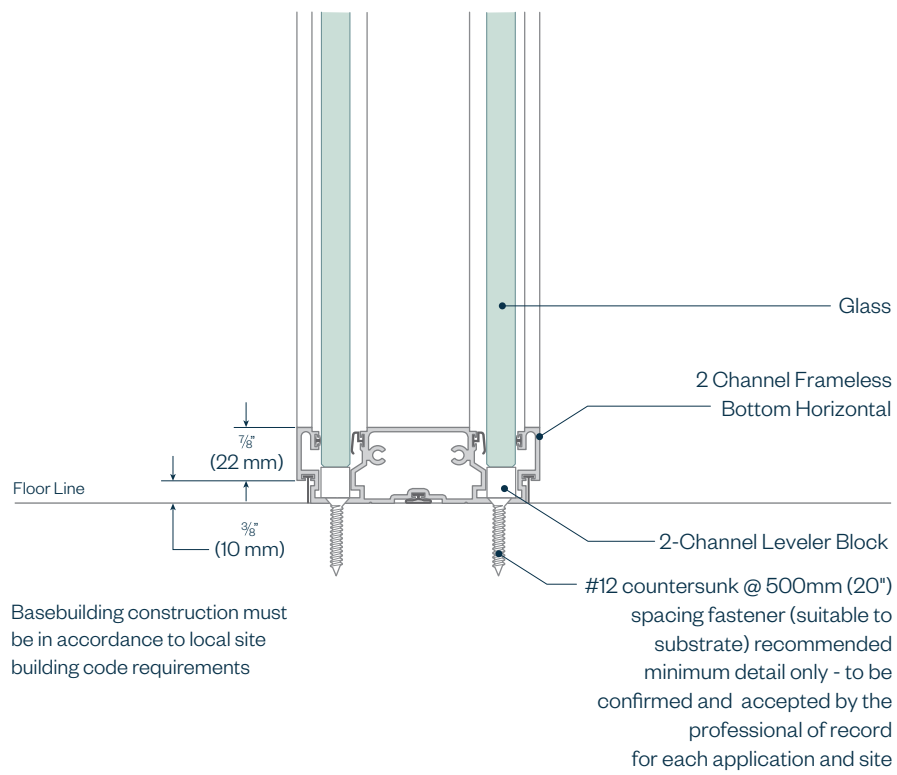



HAWORTH

# Enclose & EFG Architectural Details

## Enclose Frameless Glass Floor Connection

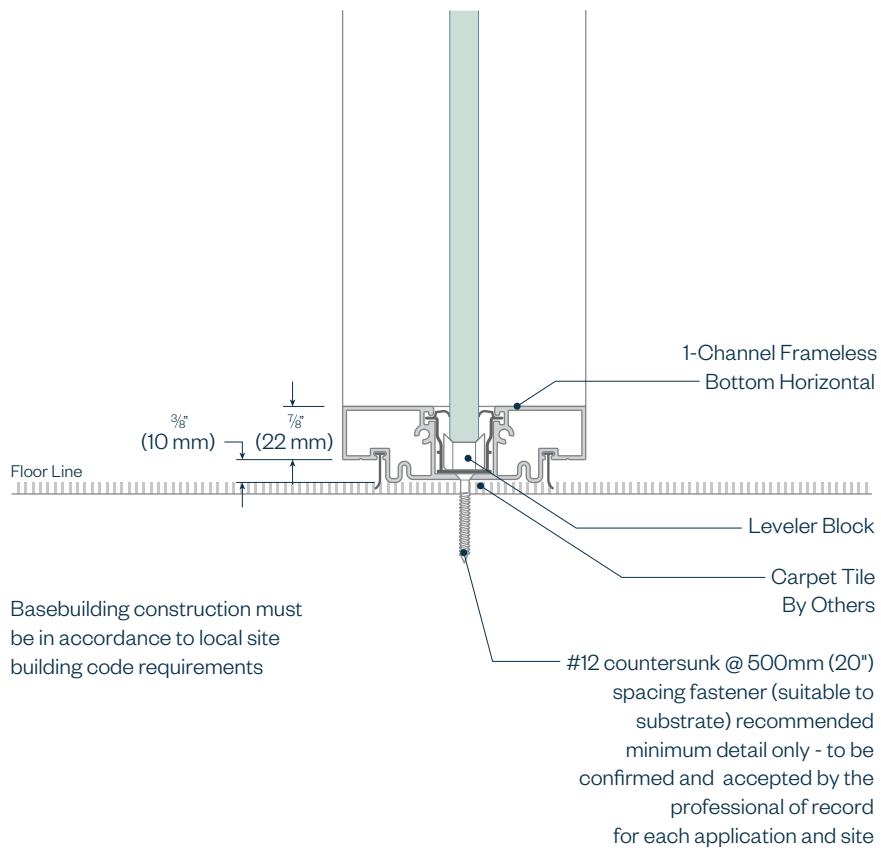

HAWORTH

# Enclose & EFG Architectural Details

## Enclose Glass Panel Floor Connection - Carpet

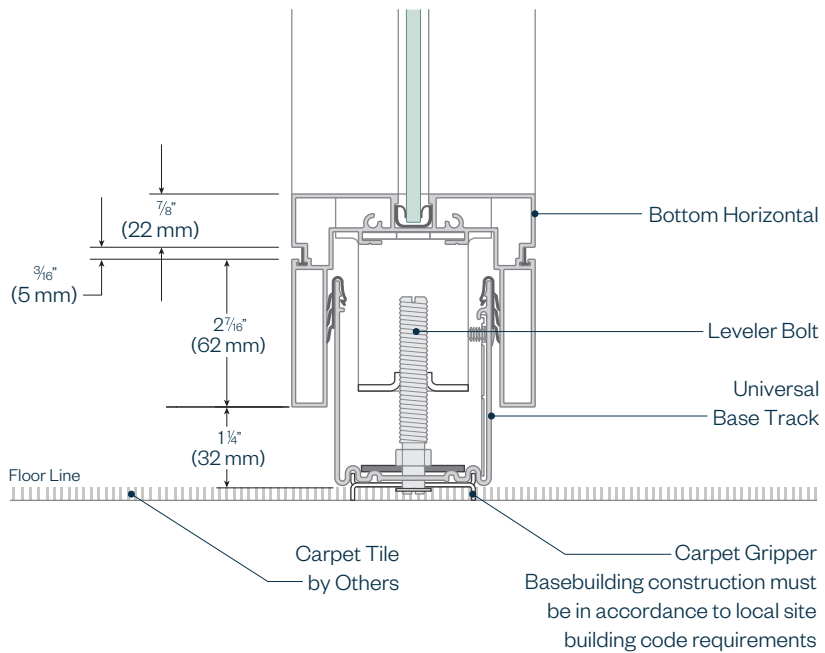

# Enclose & EFG Architectural Details

## Enclose Glass Panel Floor Connection - Hard

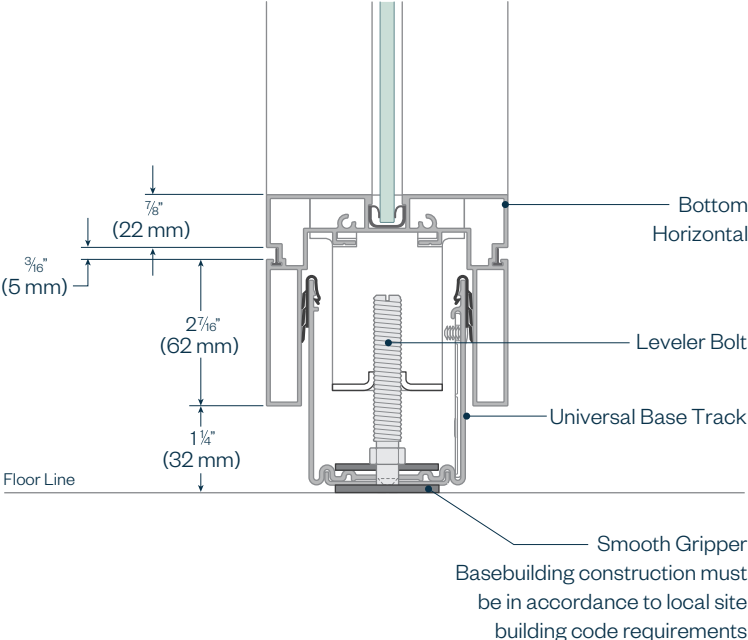

HAWORTH

# Enclose & EFG Architectural Details

## Enclose Solid Panel Floor Connection - Carpet

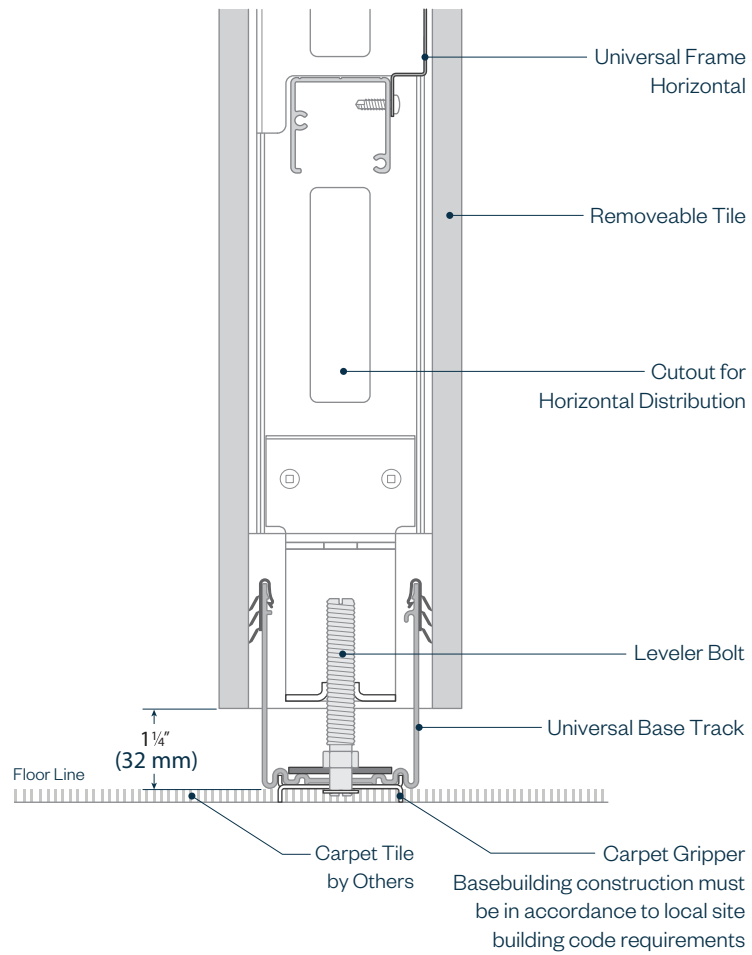

HAWORTH

# Enclose & EFG Architectural Details

## Enclose Freestanding

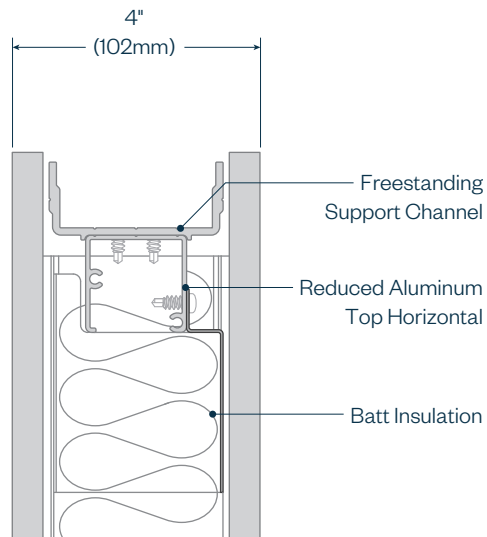

HAWORTH

# Enclose & EFG Architectural Details

## Enclose Freestanding - Chinook

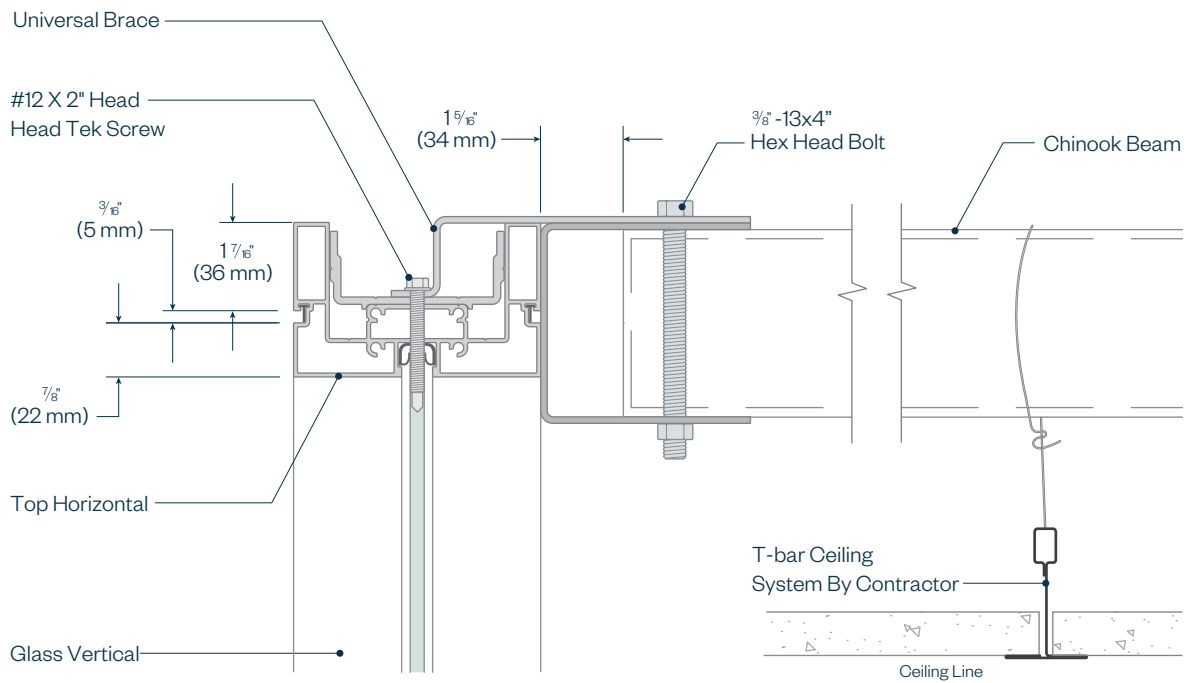

HAWORTH

# Enclose & EFG Architectural Details

## Lateral Bracing - Ceiling with Wire Ties Only

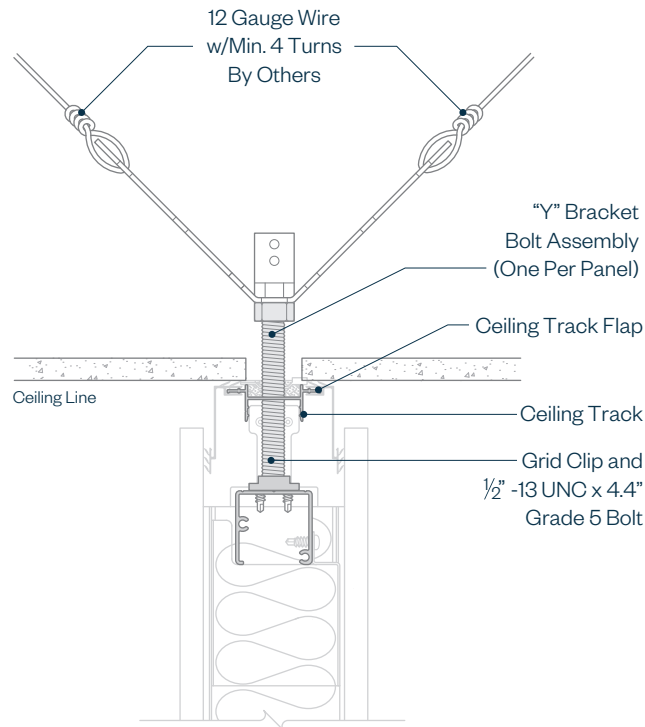

Base building construction must be in accordance to local site building code requirements

Details for lateral bracing are shown as a guide and are not project specific. It is the responsibility of the engineer of record to determine appropriate interpretation/application of information provided in the these drawings based on project requirements.

# Enclose & EFG Architectural Details

## Lateral Bracing - Ceiling with Kicker Studs

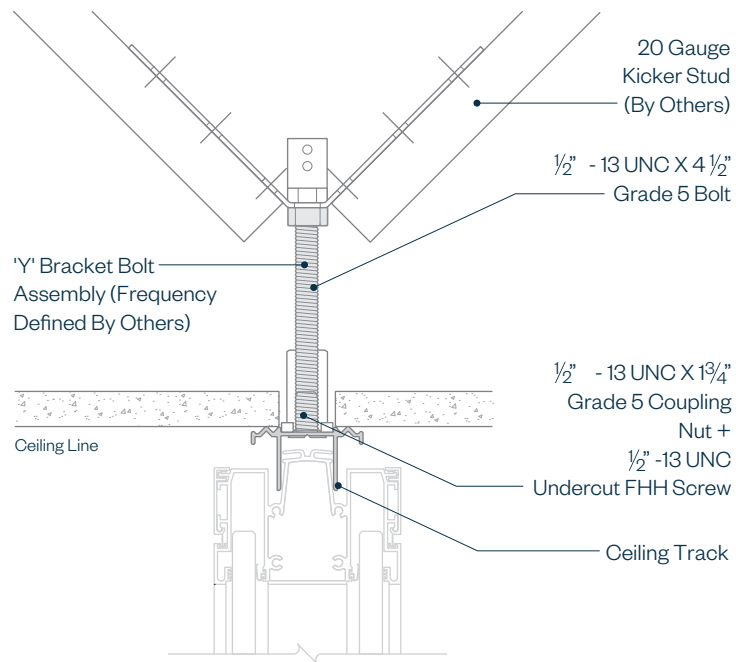

Base building construction must be in accordance to local site building code requirements

Details for lateral bracing are shown as a guide and are not project specific. It is the responsibility of the engineer of record to determine appropriate interpretation/application of information provided in the these drawings based on project requirements.



# Enclose & EFG Architectural Details

## Lateral Bracing - Ceiling with Compression Strut

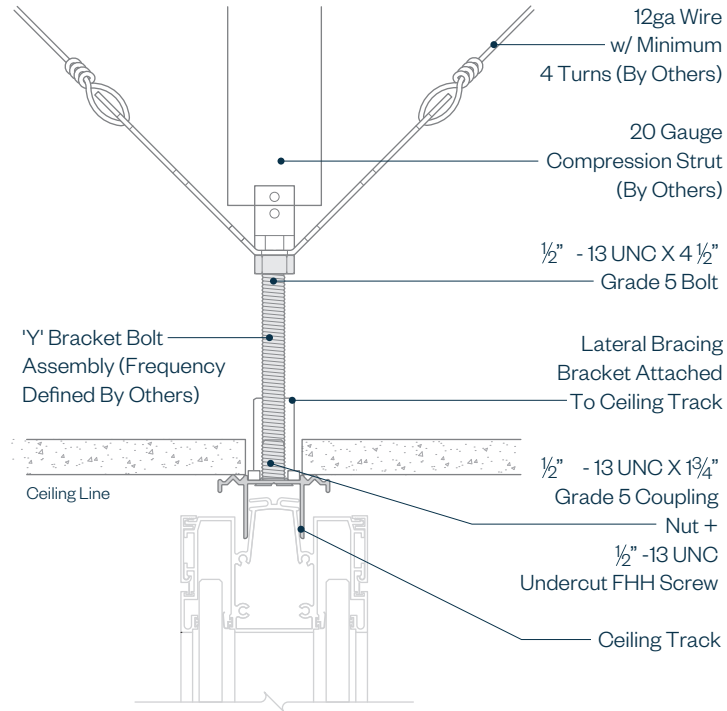

Base building construction must be in accordance to local site building code requirements

Details for lateral bracing are shown as a guide and are not project specific. It is the responsibility of the engineer of record to determine appropriate interpretation/application of information provided in the these drawings based on project requirements.

HAWORTH

# Enclose & EFG Architectural Details

## Lateral Bracing - Carpet

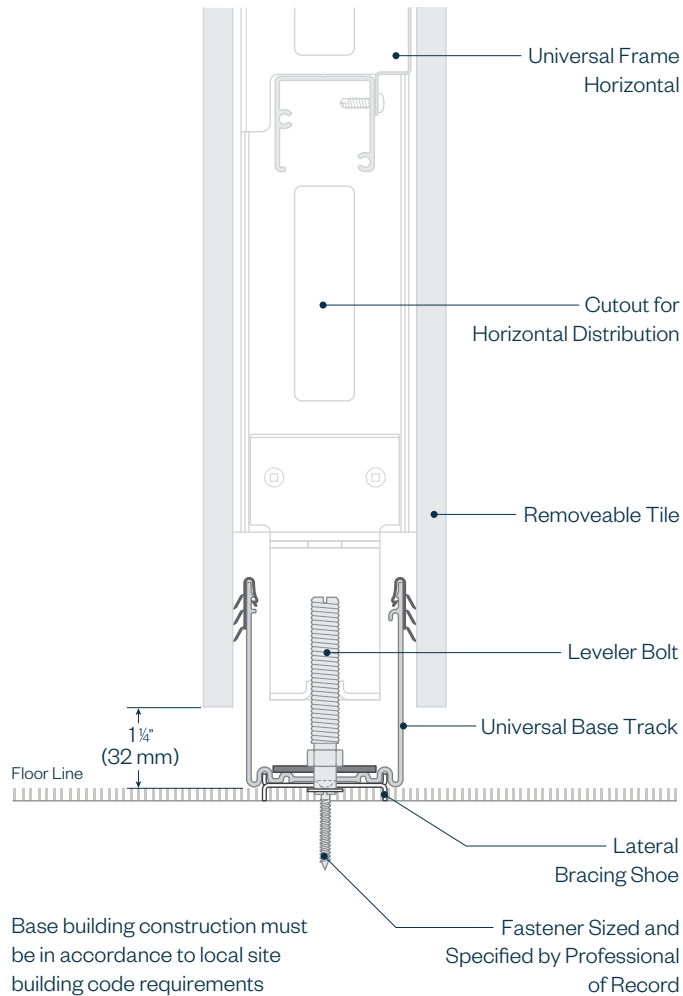

Base building construction must be in accordance to local site building code requirements

Fastener Sized and Specified by Professional of Record

Details for lateral bracing are shown as a guide and are not project specific. It is the responsibility of the engineer of record to determine appropriate interpretation/application of information provided in the these drawings based on project requirements.

HAWORTH

# Enclose & EFG Architectural Details

## Lateral Bracing-Hard Floor

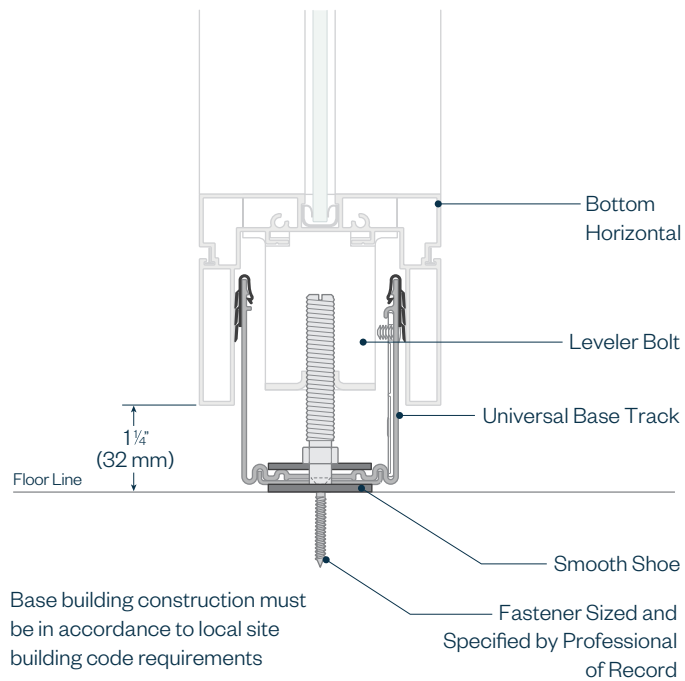

Details for lateral bracing are shown as a guide and are not project specific. It is the responsibility of the engineer of record to determine appropriate interpretation/application of information provided in these drawings based on project requirements.

HAWORTH

# Enclose & EFG Architectural Details

## Lateral Bracing - Compressible Starter

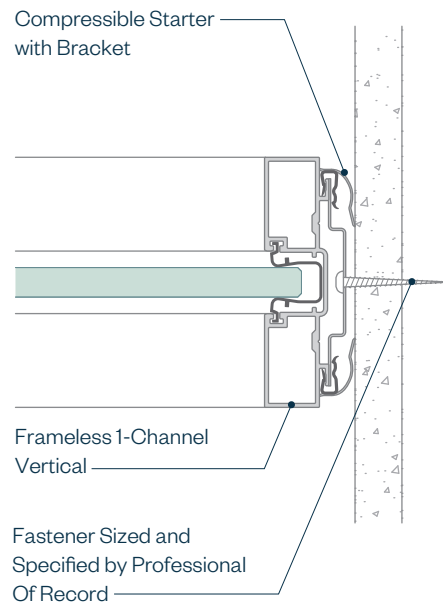

Details for lateral bracing are shown as a guide and are not project specific. It is the responsibility of the engineer of record to determine appropriate interpretation/application of information provided in the these drawings based on project requirements.